

SK/DAT

DIN 69871

PRECISION TOOL HOLDERS SYSTEM



SK/DAT 数控刀柄系列

CNC TOOL SYSTEMS

·参考资料

REFERENCE DETAILS

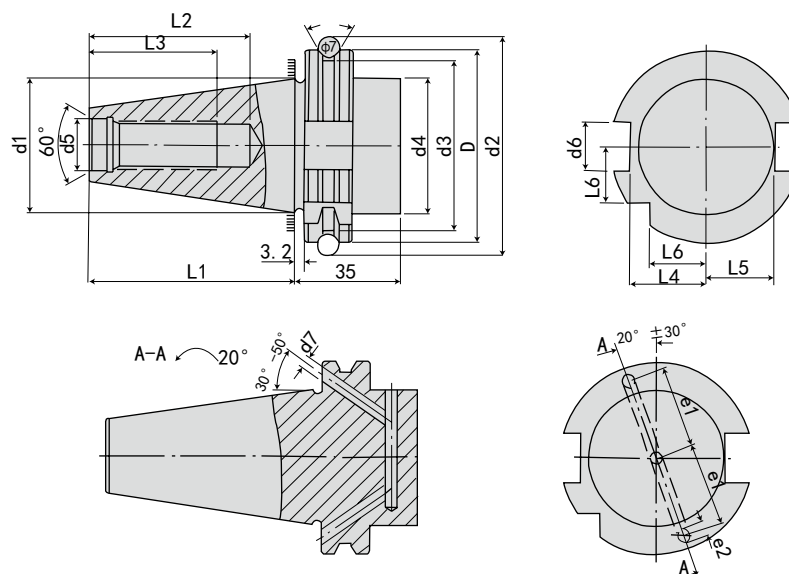

规格 Model	D 0 -0.4	d1	d2 ±0.05	d3 0 -0.5	d4 Max.	d5 H7	d6 H12	d7	L1 0 -0.3	L2 Min	L3 Min	L4 0 -0.4	L5 0 -0.5	L6 0 -0.3	e1 ±0.1	e2 Max.
SK30	50	31.75	59.30	44.30	45	13	16.1	4	47.8	33.5	24	19	16.4	15	21	5
SK40	63.55	44.45	72.30	56.25	50	17	16.1	4	68.4	42.5	32	25	22.8	18.5	27	5
SK50	97.50	69.85	107.25	91.25	80	25	25.7	6	101.75	61.5	47	37.7	35.5	30	42	7

特点:

- ◎ 锥度精度: <AT3
- ◎ 基本材质: JIS-SCM415
- ◎ 硬度: HRC56°渗碳深度 >0.8mm
- ◎ 真圆度: <0.8um
- ◎ 表面粗糙度: Ra<0.5um
- ◎ 刀柄本体可另外指定: 通过 V 型法兰端出水规格 (DIN-69871-AD+B)
- ◎ ER、FMA、FMB、MLT、SCK、SLN、SOM 皆符合: 通过刀柄本体中心出水规格 (DIN-69871-AD)
- ◎ 刀柄有预设标准动平衡 G6.3, 可另外指定精密动平衡 G2.5
- ◎ 本体规范: DIN 69871

·SK30-PHC 液压刀柄

SK30-PHC HYDRAULIC TOOL HOLDER

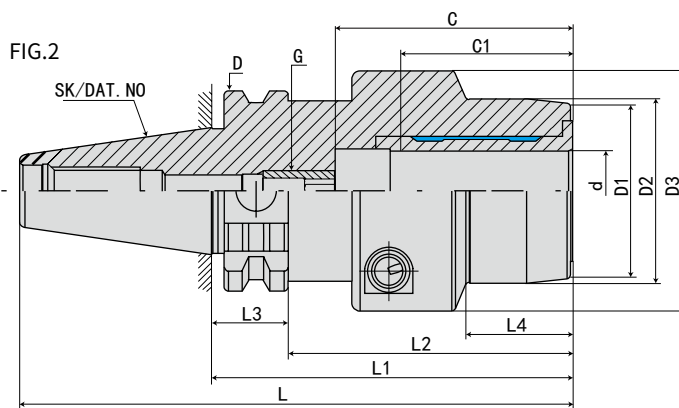
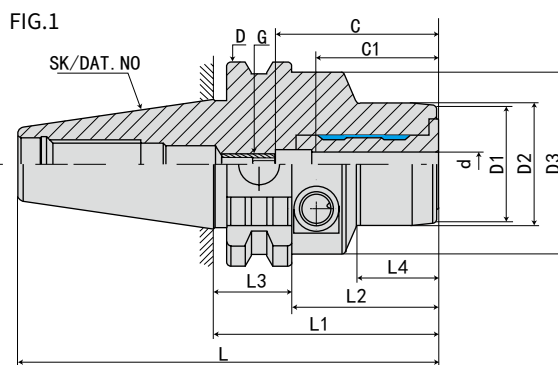

型号 Model	L	L1	L2	L3	L4	D	D1	D2	D3	d	最大插入深度 C Max. insertion depth	最少插入深度 C1 Min insertion depth	G	FIG	重量 KGS
SK30-PHC05- 55	102.8	55	35.9	19.1	20	50	21	25	45	5	*	26	*	1	0.6
-PHC06- 55	102.8	55	35.9	19.1	20	50	22	26	45	6	37	27	M5*0.8P	1	0.6
-PHC08- 55	102.8	55	35.9	19.1	20	50	24	28	45	8	37	27	M6*1.0P	1	0.6
-PHC10- 55	102.8	55	35.9	19.1	21	50	26	30	45	10	41	31	M8*1.0P	1	0.6
-PHC12- 55	102.8	55	35.9	19.1	22	50	28	32	45	12	46	36	M10*1.0P	1	0.6
-PHC14- 90	137.8	90	70.9	19.1	42	50	30	34	45	14	46	36	M10*1.0P	1	0.7
-PHC16- 90	137.8	90	70.9	19.1	50	50	34	38	45	16	49	39	M10*1.0P	1	0.7
-PHC18- 90	137.8	90	70.9	19.1	50	50	36	40	45	18	49	39	M10*1.0P	1	0.7
-PHC20- 90	137.8	90	70.9	19.1	50	50	38	42	45	20	51	41	M10*1.0P	1	0.7
-PHC25-115	157.8	110	95.9	19.1		50	53	57	63	25	57	47	M10*1.0P	2	1
-PHC32-115	157.8	110	95.9	19.1		50	60	64	63	32	61	51	M10*1.0P	2	1

规格说明:

SK30 - PHC - 05 - 55

- SK30 - 锥柄形式 Taper size
- PHC - 功能代号 Holder type
- 05 - L1 长度 Length (L1)
- 55 - 刀杆直径 Diameter

·SK40-PHC 液压刀柄

SK40-PHC HYDRAULIC TOOL HOLDER

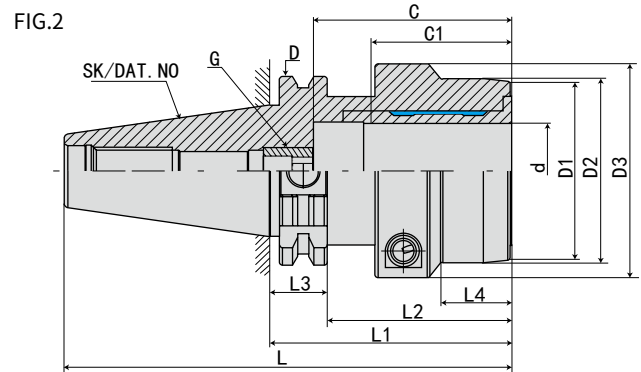
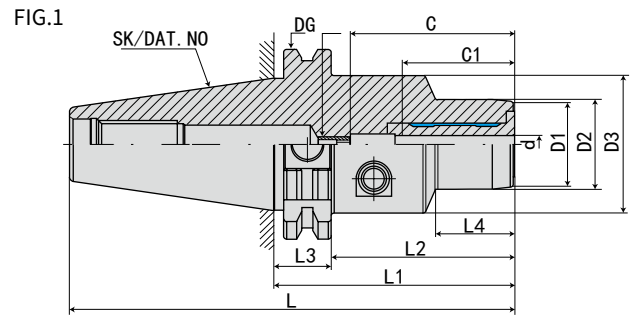

型号 Model	L	L1	L2	L3	L4	D	D1	D2	D3	d	最大插入深度 C Max. insertion depth	最少插入深度 C1 Min insertion depth	G	FIG	重量 KGS
SK40-PHC03-80.5	148.9	80.5	61.4	19.1	29.5	63.55	20	23	49.5	3	*	18	*	1	1.3
-PHC3.175-80.5	148.9	80.5	61.4	19.1	29.5	63.55	20	23	49.5	3.175	*	18	*	1	1.3
-PHC04-80.5	148.9	80.5	61.4	19.1	29.5	63.55	21	24	49.5	4	*	24	*	1	1.3
-PHC05-80.5	148.9	80.5	61.4	19.1	29.5	63.55	21	25	49.5	5	*	26	*	1	1.3
-PHC06-80.5	148.9	80.5	61.4	19.1	29.5	63.55	22	26	49.5	6	37	27	M5*0.8P	1	1.3
-PHC08-80.5	148.9	80.5	61.4	19.1	30	63.55	24	28	49.5	8	37	27	M6*1.0P	1	1.3
-PHC10-80.5	148.9	80.5	61.4	19.1	31	63.55	26	30	49.5	10	41	31	M8*1.0P	1	1.3
-PHC12-80.5	148.9	80.5	61.4	19.1	31.5	63.55	28	32	49.5	12	46	36	M10*1.0P	1	1.3
-PHC14-80.5	148.9	80.5	61.4	19.1	33	63.55	30	34	49.5	14	46	36	M10*1.0P	1	1.3
-PHC16-80.5	148.9	80.5	61.4	19.1	33	63.55	34	38	49.5	16	49	39	M12*1.0P	1	1.3
-PHC18-80.5	148.9	80.5	61.4	19.1	34	63.55	36	40	49.5	18	49	39	M12*1.0P	1	1.3
-PHC20-80.5	148.9	80.5	61.4	19.1	34	63.55	38	42	49.5	20	51	41	M16*1.0P	1	1.3
-PHC25-80.5	148.9	80.5	61.4	19.1	22	63.55	53	55	63	25	57	47	M16*1.0P	2	1.6
-PHC32-80.5	148.9	80.5	61.4	19.1	25.5	63.55	60	63	70	32	61	51	M16*1.0P	2	1.7

规格说明:

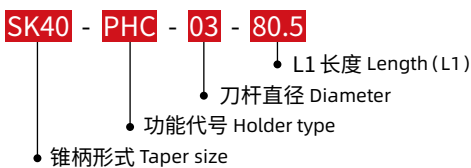

·SK40-PHC 液压刀柄

SK40-PHC HYDRAULIC TOOL HOLDER



FIG.1

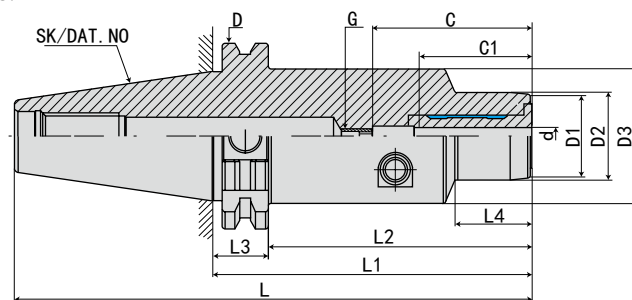
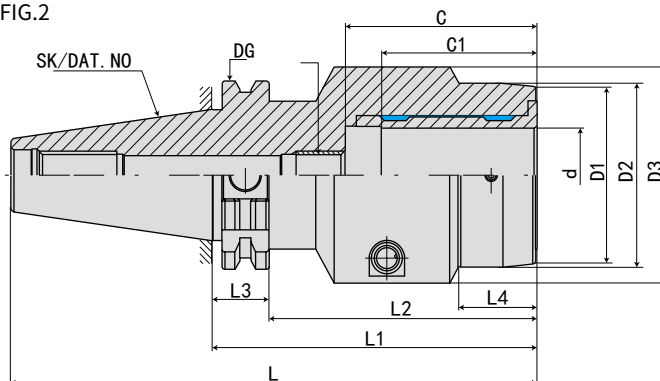
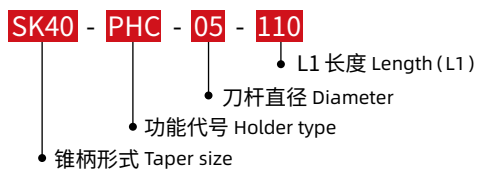

FIG.2



型号 Model	L	L1	L2	L3	L4	D	D1	D2	D3	d	最大插入深度 C Max. insertion depth	最少插入深度 C1 Min insertion depth	G	FIG	重量 KGS
SK40-PHC05-110	178.4	110	90.9	19.1	29.5	63.55	21	25	49.5	5	*	26	*	1	1.7
-PHC06-110	178.4	110	90.9	19.1	29.5	63.55	22	26	49.5	6	37	27	M5*0.8P	1	1.7
-PHC08-110	178.4	110	90.9	19.1	30	63.55	24	28	49.5	8	37	27	M6*1.0P	1	1.8
-PHC10-110	178.4	110	90.9	19.1	31	63.55	26	30	49.5	10	41	31	M8*1.0P	1	1.8
-PHC12-110	178.4	110	90.9	19.1	31.5	63.55	28	32	49.5	12	46	36	M10*1.0P	1	1.8
-PHC14-110	178.4	110	90.9	19.1	33	63.55	30	34	49.5	14	46	36	M10*1.0P	1	1.8
-PHC16-110	178.4	110	90.9	19.1	33	63.55	34	38	49.5	16	49	39	M12*1.0P	1	1.8
-PHC18-110	178.4	110	90.9	19.1	34	63.55	36	40	49.5	18	49	39	M12*1.0P	1	1.9
-PHC20-110	178.4	110	90.9	19.1	34	63.55	38	42	49.5	20	51	41	M16*1.0P	1	1.9
-PHC25-110	178.4	110	90.9	19.1	22	63.55	53	55	63	25	57	47	M16*1.0P	2	2.3
-PHC32-110	178.4	110	90.9	19.1	25.5	63.55	60	63	70	32	61	51	M16*1.0P	2	2.4

规格说明:



F
SK SHANK SYSTEMS
SK 刀柄系列

·SK40-PHC 液压刀柄

SK40-PHC HYDRAULIC TOOL HOLDER

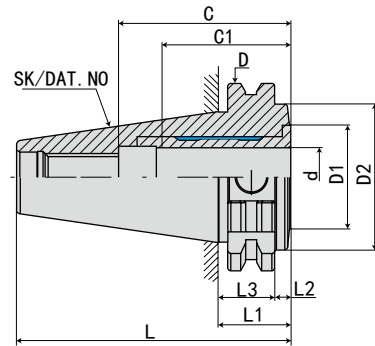

型号 Model	L	L1	L2	L3	D	D1	D2	d	最大插入深度 C Max. insertion depth	最少插入深度 C1 Min insertion depth	G	重量 KGS
SK40-PHC20-24.6	93	24.6	5.5	19.1	63.55	34	49.5	20	51	41	M16*1.0P	0.6

规格说明:

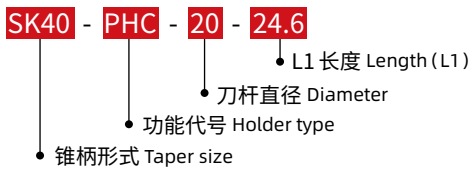

·SK50-PHC 液压刀柄

SK50-PHC HYDRAULIC TOOL HOLDER

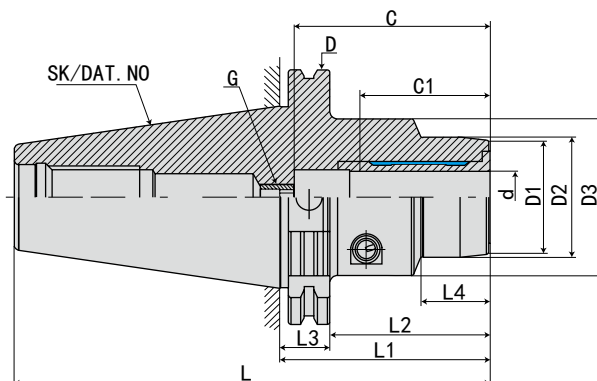

型号 Model	L	L1	L2	L3	L4	D	D1	D2	D3	d	最大插入深度 C Max. insertion depth	最少插入深度 C1 Min insertion depth	G	重量 KGS
SK50-PHC05-80.5	182.25	80.5	61.4	19.1	29.5	97.5	21	25	49.5	5	*	26	*	3.2
-PHC06-80.5	182.25	80.5	61.4	19.1	29.5	97.5	22	26	49.5	6	37	27	M5*0.8P	3.2
-PHC08-80.5	182.25	80.5	61.4	19.1	30	97.5	24	28	49.5	8	37	27	M6*1.0P	3.3
-PHC10-80.5	182.25	80.5	61.4	19.1	35	97.5	26	30	49.5	10	41	31	M8*1.0P	3.3
-PHC12-80.5	182.25	80.5	61.4	19.1	40	97.5	28	32	49.5	12	46	36	M10*1.0P	3.3
-PHC14-80.5	182.25	80.5	61.4	19.1	40	97.5	30	34	49.5	14	46	36	M10*1.0P	3.3
-PHC16-80.5	182.25	80.5	61.4	19.1	45	97.5	34	38	49.5	16	49	39	M12*1.0P	3.3
-PHC18-80.5	182.25	80.5	61.4	19.1	46	97.5	36	40	49.5	18	49	39	M12*1.0P	3.3
-PHC20-80.5	182.25	80.5	61.4	19.1	42	97.5	38	42	49.5	20	51	41	M16*1.0P	3.3
-PHC25- 100	201.75	100	80.9	19.1	48	97.5	53	55	63	25	57	47	M16*1.0P	3.8
-PHC32- 100	201.75	100	80.9	19.1	61	97.5	60	63	70	32	61	51	M16*1.0P	4.2

规格说明:

SK50 - PHC - 05 - 80.5

- L1 长度 Length (L1)
- 刀杆直径 Diameter
- 功能代号 Holder type
- 锥柄形式 Taper size

·SK50-PHC 液压刀柄

SK50-PHC HYDRAULIC TOOL HOLDER

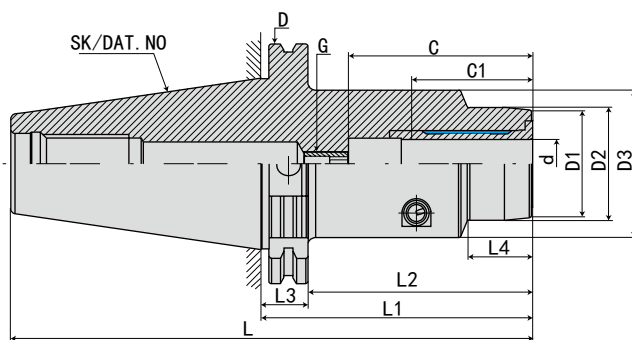

型号 Model	L	L1	L2	L3	L4	D	D1	D2	D3	d	最大插入深度 C Max. insertion depth	最少插入深度 C1 Min insertion depth	G	重量 KGS
SK50-PHC05-110	211.75	110	90.9	19.1	29	97.5	21	25	49.5	5	*	26	*	2.5
-PHC06-110	211.75	110	90.9	19.1	29	97.5	22	26	49.5	6	37	27	M5*0.8P	2.5
-PHC08-110	211.75	110	90.9	19.1	30	97.5	24	28	49.5	8	37	27	M6*1.0P	3
-PHC10-110	211.75	110	90.9	19.1	35	97.5	26	30	49.5	10	41	31	M8*1.0P	3
-PHC12-110	211.75	110	90.9	19.1	40	97.5	28	32	49.5	12	46	36	M10*1.0P	5
-PHC14-110	211.75	110	90.9	19.1	40	97.5	30	34	49.5	14	46	36	M10*1.0P	5
-PHC16-110	211.75	110	90.9	19.1	45	97.5	34	38	49.5	16	49	39	M12*1.0P	5
-PHC18-110	211.75	110	90.9	19.1	46	97.5	36	40	49.5	18	49	39	M12*1.0P	5
-PHC20-110	211.75	110	90.9	19.1	42	97.5	38	42	49.5	20	51	41	M16*1.0P	8
-PHC25-110	211.75	110	90.9	19.1	48	97.5	53	55	63	25	57	47	M16*1.0P	8
-PHC32-110	211.75	110	90.9	19.1	61	97.5	60	63	70	32	61	51	M16*1.0P	8

规格说明:

SK50 - PHC - 05 - 110

- L1 长度 Length (L1)
- 刀杆直径 Diameter
- 功能代号 Holder type
- 锥柄形式 Taper size

·SK50-PHC 液压刀柄

SK50-PHC HYDRAULIC TOOL HOLDER

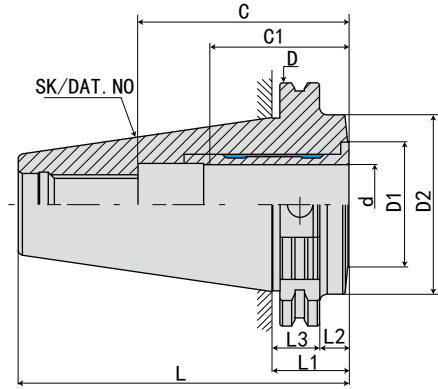

型号 Model	L	L1	L2	L3	D	D1	D2	d	最大插入深度 C Max. insertion depth	最少插入深度 C1 Min insertion depth	G	重量 KGS
SK50-PHC32-30.9	132.65	30.9	11.8	19.1	97.5	44.5	70.5	32	62.5	51	M16*1.0P	2.5

规格说明:

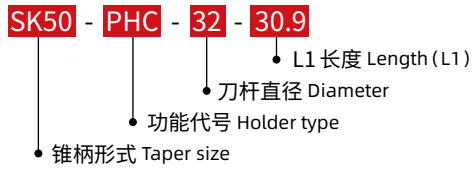

·SK40-SPHC 液压刀柄

SK40-SPHC HYDRAULIC TOOL HOLDER

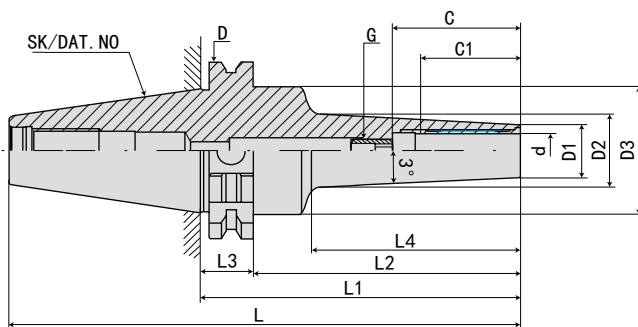

型号 Model	L	L1	L2	L3	L4	D	D1	D2	D3	d	最大插入深度 C Max. insertion depth	最少插入深度 C1 Min insertion depth	G	重量 KGS
SK40-SPHC03- 85	153.4	85	65.9	19.1	42	63.55	11		46	3	*	18	*	1.3
-115	183.4	115	95.9	19.1	72	63.55	11		46	3	*	18	*	1.4
SK40-SPHC04- 85	153.4	85	65.9	19.1	42	63.55	11		46	4	*	24	*	1.3
-115	183.4	115	95.9	19.1	72	63.55	11		46	4	*	24	*	1.4
-SPHC05- 85	153.4	85	65.9	19.1	42	63.55	12		46	5	*	26	*	1.3
-115	183.4	115	95.9	19.1	72	63.55	12		46	5	*	26	*	1.4
-SPHC06-115	183.4	115	95.9	19.1	74	63.55	13		46	6	37	27	M5*0.8P	1.4
-145	213.4	145	125.9	19.1	104	63.55	13		46	6	37	27	M5*0.8P	1.5
-SPHC08-115	183.4	115	95.9	19.1	74	63.55	15		46	8	37	27	M6*1.0P	1.4
-145	213.4	145	125.9	19.1	104	63.55	15		46	8	37	27	M6*1.0P	1.5
-SPHC10-115	183.4	115	95.9	19.1	74	63.55	17		46	10	41	31	M8*1.0P	1.4
-145	213.4	145	125.9	19.1	104	63.55	17		46	10	41	31	M8*1.0P	1.5
-SPHC12-115	183.4	115	95.9	19.1	74	63.55	19		46	12	46	36	M10*1.0P	1.4
-145	213.4	145	125.9	19.1	104	63.55	19		46	12	46	36	M10*1.0P	1.5
-SPHC14-115	183.4	115	95.9	19.1	74	63.55	21		46	14	46	36	M10*1.0P	1.6
-145	213.4	145	125.9	19.1	104	63.55	21		46	14	46	36	M10*1.0P	1.8
-SPHC16-115	183.4	115	95.9	19.1	74	63.55	23		50	16	49	39	M12*1.0P	1.7
-145	213.4	145	125.9	19.1	104	63.55	23		50	16	49	39	M12*1.0P	1.9
-SPHC18-115	183.4	115	95.9	19.1	74	63.55	25		50	18	49	39	M12*1.0P	1.7
-145	213.4	145	125.9	19.1	104	63.55	25		50	18	49	39	M12*1.0P	1.9
-SPHC20-115	183.4	115	95.9	19.1	74	63.55	27		50	20	51	41	M16*1.0P	1.8
-145	213.4	145	125.9	19.1	104	63.55	27		50	20	51	41	M16*1.0P	2

规格说明:

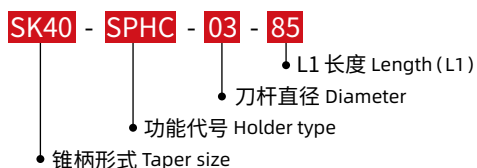

F SK 刀柄系列 SK SHANK SYSTEMS

·SK50-SPHC 液压刀柄

SK50-SPHC HYDRAULIC TOOL HOLDER

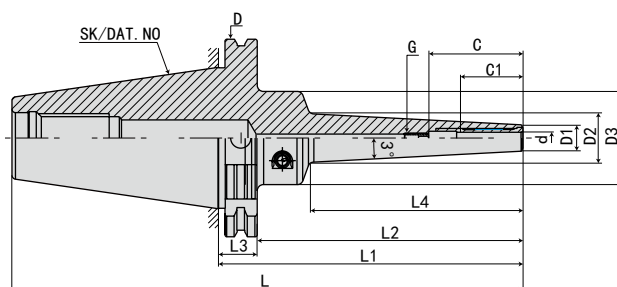

型号 Model	L	L1	L2	L3	L4	D	D1	D2	D3	d	最大插入深度 C Max. insertion depth	最少插入深度 C1 Min insertion depth	G	重量 KGS
SK50-SPHC06-150	251.75	150	130.9	19.1	100	97.5	13		50	6	37	27	M5*0.8P	4.2
-200	301.75	200	180.9	19.1	150	97.5	13		50	6	37	27	M5*0.8P	4.4
-250	351.75	250	230.9	19.1	200	97.5	13		50	6	37	27	M5*0.8P	4.6
-300	401.75	300	280.9	19.1	250	97.5	13		50	6	37	27	M5*0.8P	4.8
-SPHC08-150	251.75	150	130.9	19.1	100	97.5	15		50	8	37	27	M6*1.0P	4.2
-200	301.75	200	180.9	19.1	150	97.5	15		50	8	37	27	M6*1.0P	4.4
-250	351.75	250	230.9	19.1	200	97.5	15		50	8	37	27	M6*1.0P	4.6
-300	401.75	300	280.9	19.1	250	97.5	15		50	8	37	27	M6*1.0P	4.8
-SPHC10-150	251.75	150	130.9	19.1	100	97.5	17		50	10	41	31	M8*1.0P	4.3
-200	301.75	200	180.9	19.1	150	97.5	17		50	10	41	31	M8*1.0P	4.5
-250	351.75	250	230.9	19.1	200	97.5	17		50	10	41	31	M8*1.0P	4.7
-300	401.75	300	280.9	19.1	250	97.5	17		50	10	41	31	M8*1.0P	4.9
-SPHC12-150	251.75	150	130.9	19.1	100	97.5	19		50	12	46	36	M10*1.0P	4.3
-200	301.75	200	180.9	19.1	150	97.5	19		50	12	46	36	M10*1.0P	4.5
-250	351.75	250	230.9	19.1	200	97.5	19		50	12	46	36	M10*1.0P	4.7
-300	401.75	300	280.9	19.1	250	97.5	19		50	12	46	36	M10*1.0P	4.9
-SPHC14-150	251.75	150	130.9	19.1	100	97.5	21		50	14	46	36	M10*1.0P	4.4
-200	301.75	200	180.9	19.1	150	97.5	21		50	14	46	36	M10*1.0P	4.6
-250	351.75	250	230.9	19.1	200	97.5	21		50	14	46	36	M10*1.0P	4.8
-300	401.75	300	280.9	19.1	250	97.5	21		50	14	46	36	M10*1.0P	5
-SPHC16-150	251.75	150	130.9	19.1	100	97.5	23		50	16	75	39	M12*1.0P	4.4
-200	301.75	200	180.9	19.1	150	97.5	23		50	16	75	39	M12*1.0P	4.6
-250	351.75	250	230.9	19.1	200	97.5	23		50	16	75	39	M12*1.0P	4.8
-300	401.75	300	280.9	19.1	250	97.5	23		50	16	75	39	M12*1.0P	5
-SPHC18-150	251.75	150	130.9	19.1	100	97.5	25		50	18	75	39	M12*1.0P	4.5
-200	301.75	200	180.9	19.1	150	97.5	25		50	18	75	39	M12*1.0P	4.7
-250	351.75	250	230.9	19.1	200	97.5	25		50	18	75	39	M12*1.0P	4.9
-300	401.75	300	280.9	19.1	250	97.5	25		50	18	75	39	M12*1.0P	5.1
-SPHC20-150	251.75	150	130.9	19.1	100	97.5	27		50	20	75	41	M16*1.0P	4.6
-200	301.75	200	180.9	19.1	150	97.5	27		50	20	75	41	M16*1.0P	4.8
-250	351.75	250	230.9	19.1	200	97.5	27		50	20	75	41	M16*1.0P	5
-300	401.75	300	280.9	19.1	250	97.5	27		50	20	75	41	M16*1.0P	5.2

规格说明:

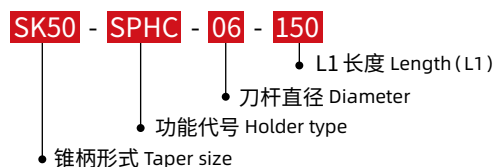
 F
 SK SHANK SYSTEMS
 SK 刀柄系列

·SK40-ZPHC 调零液压刀柄

SK40-ZPHC ZERO FIT HYDRAULIC TOOL HOLDER

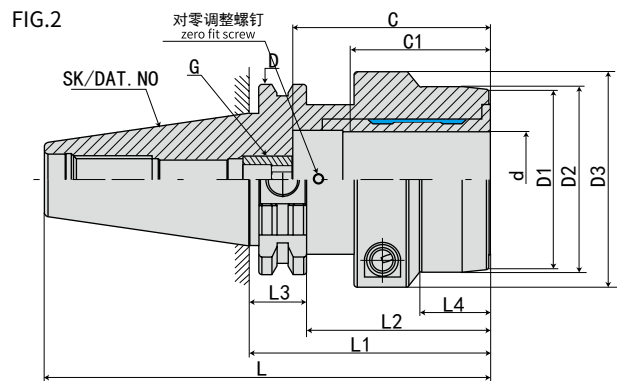
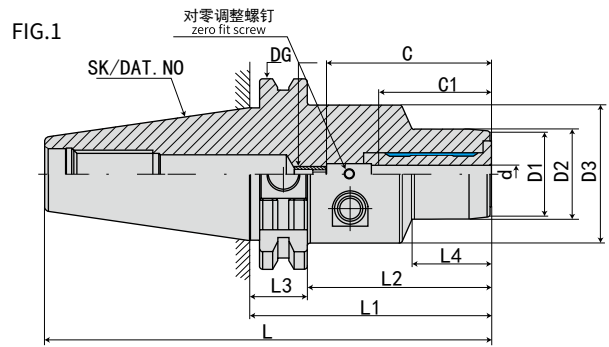

型号 Model	L	L1	L2	L3	L4	D	D1	D2	D3	d	最大插入深度 C Max. insertion depth	最少插入深度 C1 Min insertion depth	G	FIG	重量 KGS
SK40-ZPHC12-80.5	148.9	80.5	61.4	19.1	31.5	63.55	28	32	49.5	12	46	36	M10*1.0P	1	1.4
-ZPHC16-80.5	148.9	80.5	61.4	19.1	33	63.55	34	38	49.5	16	49	39	M12*1.0P	1	1.4
-ZPHC20-80.5	148.9	80.5	61.4	19.1	34	63.55	38	42	49.5	20	51	41	M16*1.0P	1	1.4
-ZPHC32-80.5	148.9	80.5	61.4	19.1	25.5	63.55	60	63	80	32	61	51	M16*1.0P	2	2

规格说明:

SK40 - ZPHC - 12 - 80.5

- L1 长度 Length (L1)
- 刀杆直径 Diameter
- 功能代号 Holder type
- 锥柄形式 Taper size

·SK50-ZPHC 调零液压刀柄 SK40-ZPHC ZERO FIT HYDRAULIC TOOL HOLDER

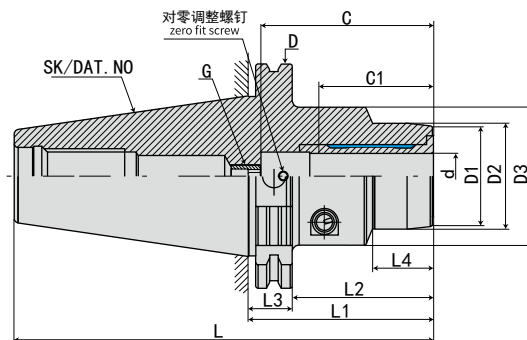

型号 Model	L	L1	L2	L3	L4	D	D1	D2	D3	d	最大插入深度 C Max. insertion depth	最少插入深度 C1 Min insertion depth	G	重量 KGS
SK50-ZPHC06-80.5	182.25	80.5	61.4	19.1	29.5	97.5	22	26	49.5	6	37	27	M5*0.8P	3.2
-ZPHC08-80.5	182.25	80.5	61.4	19.1	30	97.5	24	28	49.5	8	37	27	M6*1.0P	3.3
-ZPHC10-80.5	182.25	80.5	61.4	19.1	35	97.5	26	30	49.5	10	41	31	M8*1.0P	3.3
-ZPHC12-80.5	182.25	80.5	61.4	19.1	40	97.5	28	32	49.5	12	46	36	M10*1.0P	3.3
-ZPHC14-80.5	182.25	80.5	61.4	19.1	40	97.5	30	34	49.5	14	46	36	M10*1.0P	3.3
-ZPHC16-80.5	182.25	80.5	61.4	19.1	45	97.5	34	38	49.5	16	49	39	M12*1.0P	3.3
-ZPHC18-80.5	182.25	80.5	61.4	19.1	46	97.5	36	40	49.5	18	49	39	M12*1.0P	3.3
-ZPHC20-80.5	182.25	80.5	61.4	19.1	42	97.5	38	42	49.5	20	51	41	M16*1.0P	3.3
-ZPHC25- 100	201.75	80.5	61.4	19.1	48	97.5	53	55	63	25	57	47	M16*1.0P	3.8
-ZPHC32- 100	201.75	80.5	61.4	19.1	61	97.5	60	63	70	32	61	51	M16*1.0P	4.2

规格说明:

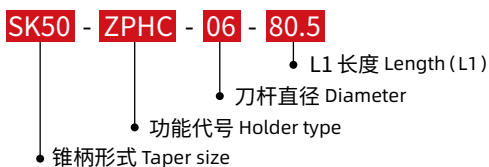

·SK50-MPHC 液压刀柄

SK50-MPHC HYDRAULIC TOOL HOLDER

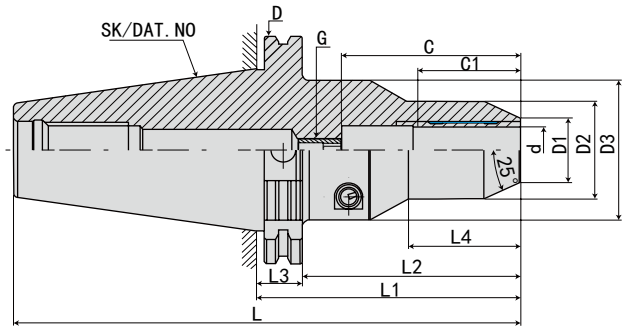

型号 Model	L	L1	L2	L3	L4	D	D1	D2	D3	d	最大插入深度 C Max. insertion depth	最少插入深度 C1 Min insertion depth	G	重量 KGS
SK50-MPHC05-110	211.75	110	90.9	19.1	55	97.5	13	31	60	5	*	26	*	3.6
-MPHC06-110	211.75	110	90.9	19.1	55	97.5	14	32	60	6	43	27	M5*0.8P	3.6
-MPHC08-110	211.75	110	90.9	19.1	55	97.5	16	33.5	60	8	43	27	M6*1.0P	3.6
-MPHC10-110	211.75	110	90.9	19.1	55	97.5	18	35	60	10	43	31	M8*1.0P	3.6
-MPHC12-110	211.75	110	90.9	19.1	55	97.5	20	36.5	60	12	50	36	M10*1.0P	3.6
-MPHC14-110	211.75	110	90.9	19.1	60	97.5	22	38	60	14	50	36	M10*1.0P	3.7
-MPHC16-110	211.75	110	90.9	19.1	60	97.5	24	39.5	60	16	53	39	M12*1.0P	3.7
-MPHC18-110	211.75	110	90.9	19.1	60	97.5	27	41	60	18	53	39	M12*1.0P	3.8
-MPHC20-110	211.75	110	90.9	19.1	60	97.5	28	42	70	20	95	41	M16*1.0P	3.8
-MPHC25-110	211.75	110	90.9	19.1	60	97.5	30	44	70	25	95	47	M16*1.0P	3.9
-MPHC32-110	211.75	110	90.9	19.1	60	97.5	40	54	70	32	95	51	M16*1.0P	4

规格说明:

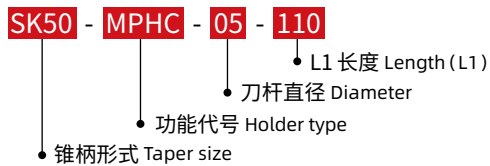

·SK30-SF 热缩刀柄 (4.5°标准型) SK30-SF SHRINK FIT TOOL HOLDER(4.5° STANDARD VERSION)

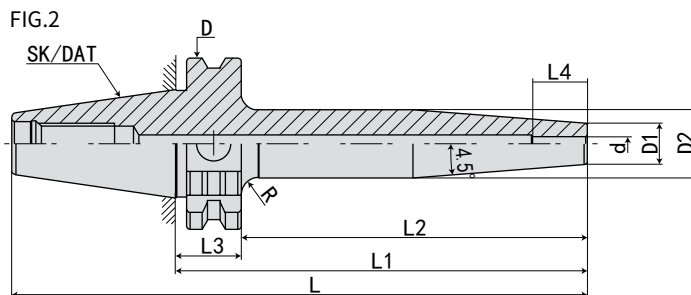
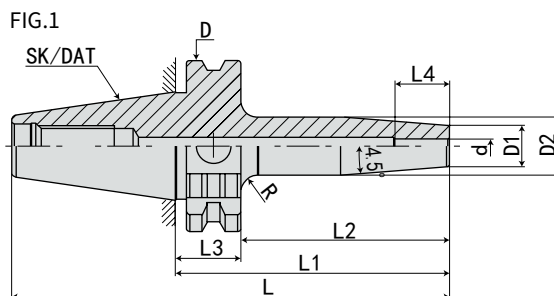

规格 Model	L	L1	L2	L3	L4	D	D1	D2	d	R	FIG	重量 KGS
SK30-SF03- 80	127.8	80	60.9	19.1	12	50	12	17	3	5	1	0.6
-120	167.8	120	100.9	19.1	12	50	12	20	3	5	2	0.8
-SF04- 80	127.8	80	60.9	19.1	16	50	12	17	4	5	1	0.6
-120	167.8	120	100.9	19.1	16	50	12	20	4	5	2	0.8
-SF05- 80	127.8	80	60.9	19.1	18	50	12	17	5	5	1	0.6
-120	167.8	120	100.9	19.1	18	50	12	20	5	5	2	0.8

规格说明:

- SK30 - SF - 03 - 80
- L1 长度 Length (L1)
 - 刀杆直径 Diameter
 - 功能代号 Holder type
 - 锥柄形式 Taper size

·SK30-SF 热缩刀柄 (4.5°标准型) SK30-SF SHRINK FIT TOOL HOLDER(4.5° STANDARD VERSION)

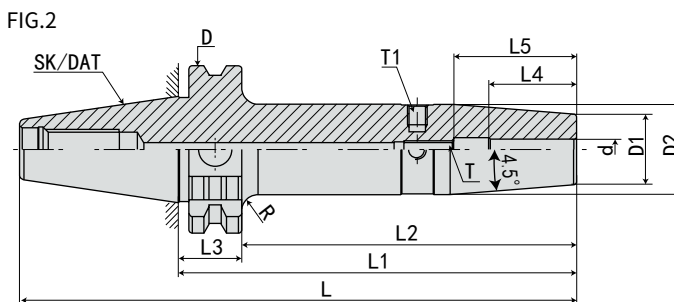
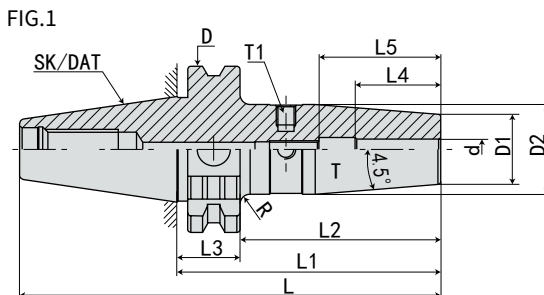

规格 Model	L	L1	L2	L3	L4	L5	D	D1	D2	d	T	T1	R	FIG	重量 KGS
SK30-SF06- 80	127.8	80	60.9	19.1	26	36	50	21	27	6	M5*0.8P	M6*1.0P	3	1	0.6
-120	167.8	120	100.9	19.1	26	36	50	21	27	6	M5*0.8P	M6*1.0P	5	2	0.8
-SF08- 80	127.8	80	60.9	19.1	26	36	50	21	27	8	M6*1.0P	M6*1.0P	3	1	0.65
-120	167.8	120	100.9	19.1	26	36	50	21	27	8	M6*1.0P	M6*1.0P	5	2	0.85
-SF10- 80	127.8	80	60.9	19.1	32	42	50	24	32	10	M8*1.0P	M6*1.0P	1	1	0.7
-120	167.8	120	100.9	19.1	32	42	50	24	32	10	M8*1.0P	M6*1.0P	4	2	0.9
-SF12- 80	127.8	80	60.9	19.1	37	47	50	24	32	12	M10*1.0P	M6*1.0P	1	1	0.7
-120	167.8	120	100.9	19.1	37	47	50	24	32	12	M10*1.0P	M6*1.0P	4	2	0.9
-SF14- 80	127.8	80	60.9	19.1	37	47	50	27	34	14	M10*1.0P	M6*1.0P	1	1	0.75
-120	167.8	120	100.9	19.1	37	47	50	27	34	14	M10*1.0P	M6*1.0P	3	2	0.95
-SF16- 80	127.8	80	60.9	19.1	40	50	50	27	34	16	M12*1.0P	M6*1.0P	1	1	0.75
-120	167.8	120	100.9	19.1	40	50	50	27	34	16	M12*1.0P	M6*1.0P	3	2	0.95
-SF18- 80	127.8	80	60.9	19.1	40	50	50	33	42	18	M12*1.0P	M6*1.0P	1	1	0.8
-120	167.8	120	100.9	19.1	40	50	50	33	42	18	M12*1.0P	M6*1.0P	1	2	1
-SF20- 80	127.8	80	60.9	19.1	42	52	50	33	42	20	M16*1.0P	M6*1.0P	1	1	0.8
-120	167.8	120	100.9	19.1	42	52	50	33	42	20	M16*1.0P	M6*1.0P	1	2	1

规格说明:

SK30 - SF - 06 - 80

- L1 长度 Length (L1)
- 刀杆直径 Diameter
- 功能代号 Holder type
- 锥柄形式 Taper size

·SK40-SF 热缩刀柄 (4.5°标准型)

SK40-SF SHRINK FIT TOOL HOLDER(4.5° STANDARD VERSION)



FIG.1

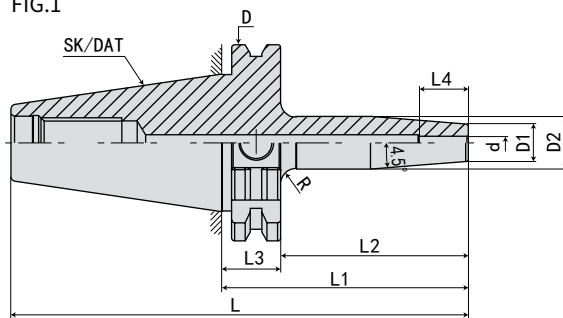
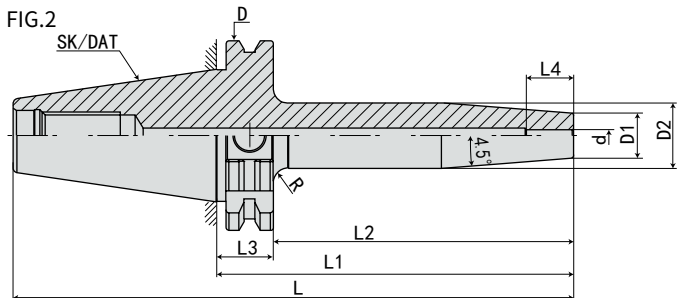

FIG.2



规格 Mode	L	L1	L2	L3	L4	D	D1	D2	d	R	FIG	重量 KGS
SK40-SF03- 80	148.4	80	60.9	19.1	12	63.55	12	17	3	5	1	1
-120	188.4	120	100.9	19.1	12	63.55	12	20	3	5	2	1.1
-160	228.4	160	140.9	19.1	12	63.55	12	20	3	5	2	1.2
-SF04- 80	148.4	80	60.9	19.1	16	63.55	12	17	4	5	1	1
-120	188.4	120	100.9	19.1	16	63.55	15	22	4	5	2	1.1
-160	228.4	160	140.9	19.1	16	63.55	15	22	4	5	2	1.2
-SF05- 80	148.4	80	60.9	19.1	18	63.55	12	17	5	5	1	1
-120	188.4	120	100.9	19.1	18	63.55	15	22	5	5	2	1.1
-160	228.4	160	140.9	19.1	18	63.55	15	22	5	5	2	1.2

规格说明:

SK40 - SF - 03 - 80

- L1 长度 Length (L1)
- 刀杆直径 Diameter
- 功能代号 Holder type
- 锥柄形式 Taper size

·SK40-SF 热缩刀柄 (4.5°标准型) SK40-SF SHRINK FIT TOOL HOLDER(4.5° STANDARD VERSION)



FIG.1

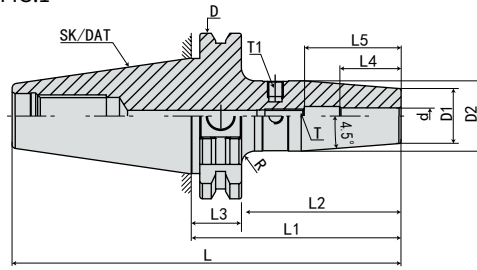

FIG.2

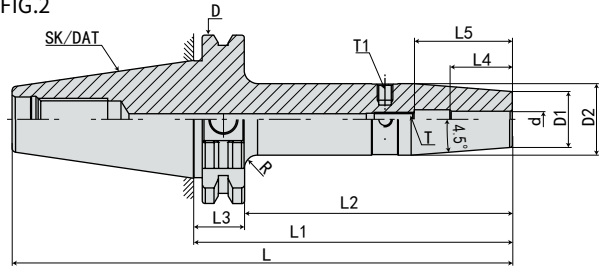
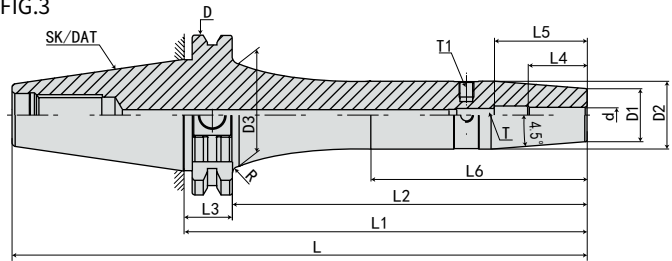
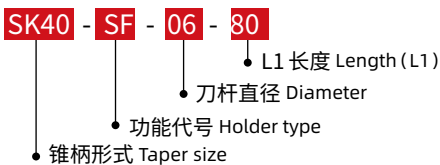

FIG.3



规格 Model	L	L1	L2	L3	L4	L5	L6	D	D1	D2	D3	d	T	T1	R	FIG	重量 KGS
SK40-SF06- 80	148.4	80	60.9	19.1	26	36	-	63.55	21	27	-	6	M5*0.8P	M6*1.0P	5	1	1.2
-120	188.4	120	100.9	19.1	26	36	-	63.55	21	27	-	6	M5*0.8P	M6*1.0P	10	2	1.5
-160	228.4	160	140.9	19.1	26	36	78	63.55	21	27	41	6	M5*0.8P	M6*1.0P	5	3	1.8
-200	268.4	200	180.9	19.1	26	36	118	63.55	21	27	41	6	M5*0.8P	M6*1.0P	5	3	2.2
-SF08- 80	148.4	80	60.9	19.1	26	36	-	63.55	21	27	-	8	M6*1.0P	M6*1.0P	5	1	1.2
-120	188.4	120	100.9	19.1	26	36	-	63.55	21	27	-	8	M6*1.0P	M6*1.0P	10	2	1.5
-160	228.4	160	140.9	19.1	26	36	78	63.55	21	27	41	8	M6*1.0P	M6*1.0P	5	3	1.8
-200	268.4	200	180.9	19.1	26	36	118	63.55	21	27	41	8	M6*1.0P	M6*1.0P	5	3	2.2
-SF10- 80	148.4	80	60.9	19.1	32	42	-	63.55	24	32	-	10	M8*1.0P	M6*1.0P	2	1	1.3
-120	188.4	120	100.9	19.1	32	42	-	63.55	24	32	-	10	M8*1.0P	M6*1.0P	10	2	1.6
-160	228.4	160	140.9	19.1	32	42	78	63.55	24	32	40	10	M8*1.0P	M6*1.0P	5	3	1.9
-200	268.4	200	180.9	19.1	32	42	118	63.55	24	32	40	10	M8*1.0P	M6*1.0P	5	3	2.3
-SF12- 80	148.4	80	60.9	19.1	37	47	-	63.55	24	32	-	12	M10*1.0P	M6*1.0P	2	1	1.3
-120	188.4	120	100.9	19.1	37	47	-	63.55	24	32	-	12	M10*1.0P	M6*1.0P	10	2	1.6
-160	228.4	160	140.9	19.1	37	47	78	63.55	24	32	40	12	M10*1.0P	M6*1.0P	5	3	1.9
-200	268.4	200	180.9	19.1	37	47	118	63.55	24	32	40	12	M10*1.0P	M6*1.0P	5	3	2.3
-SF14- 80	148.4	80	60.9	19.1	37	47	-	63.55	27	34	-	14	M10*1.0P	M6*1.0P	4	1	1.3
-120	188.4	120	100.9	19.1	37	47	-	63.55	27	34	-	14	M10*1.0P	M6*1.0P	10	2	1.6
-160	228.4	160	140.9	19.1	37	47	78	63.55	27	34	42	14	M10*1.0P	M6*1.0P	3	3	1.9
-200	268.4	200	180.9	19.1	37	47	118	63.55	27	34	42	14	M10*1.0P	M6*1.0P	3	3	2.3

规格说明:



·SK40-SF 热缩刀柄 (4.5°标准型) SK40-SF SHRINK FIT TOOL HOLDER(4.5° STANDARD VERSION)



FIG.1

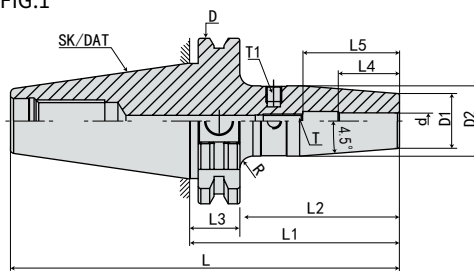

FIG.2

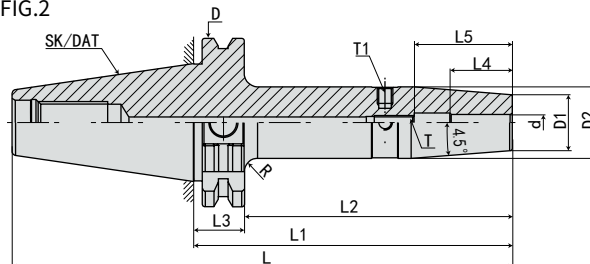
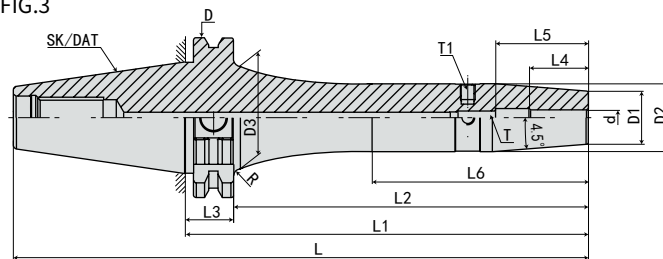

FIG.3



规格 Model	L	L1	L2	L3	L4	L5	L6	D	D1	D2	D3	d	T	T1	R	FIG	重量 KGS
SK40-SF16- 80	148.4	80	60.9	19.1	40	50	-	63.55	27	34	-	16	M12*1.0P	M6*1.0P	3	1	1.3
-120	188.4	120	100.9	19.1	40	50	-	63.55	27	34	-	16	M12*1.0P	M6*1.0P	10	2	1.6
-160	228.4	160	140.9	19.1	40	50	78	63.55	27	34	42	16	M12*1.0P	M6*1.0P	3	3	1.9
-200	268.4	200	180.9	19.1	40	50	118	63.55	27	34	42	16	M12*1.0P	M6*1.0P	3	3	2.3
-SF18- 80	148.4	80	60.9	19.1	40	50	-	63.55	33	42	-	18	M12*1.0P	M6*1.0P	2	1	1.4
-120	188.4	120	100.9	19.1	40	50	-	63.55	33	42	-	18	M12*1.0P	M6*1.0P	5	2	1.8
-160	228.4	160	140.9	19.1	40	50	-	63.55	33	42	-	18	M12*1.0P	M6*1.0P	5	2	2.1
-200	268.4	200	180.9	19.1	40	50	-	63.55	33	42	-	18	M12*1.0P	M6*1.0P	5	2	2.4
-SF20- 80	148.4	80	60.9	19.1	42	52	-	63.55	33	42	-	20	M16*1.0P	M6*1.0P	2	1	1.4
-120	188.4	120	100.9	19.1	42	52	-	63.55	33	42	-	20	M16*1.0P	M6*1.0P	5	2	1.8
-160	228.4	160	140.9	19.1	42	52	-	63.55	33	42	-	20	M16*1.0P	M6*1.0P	5	2	2.1
-200	268.4	200	180.9	19.1	42	52	-	63.55	33	42	-	20	M16*1.0P	M6*1.0P	5	2	2.4
-SF25-100	168.4	100	80.9	19.1	48	58	-	63.55	44	53	-	25	M16*1.0P	M6*1.0P	2	1	2.1
-120	188.4	120	100.9	19.1	48	58	-	63.55	44	53	-	25	M16*1.0P	M6*1.0P	2	2	2.3
-160	228.4	160	140.9	19.1	48	58	-	63.55	44	53	-	25	M16*1.0P	M6*1.0P	2	2	2.6
-200	268.4	200	180.9	19.1	48	58	-	63.55	44	53	-	25	M16*1.0P	M6*1.0P	2	2	3.1
-SF32-100	168.4	100	80.9	19.1	52	62	-	63.55	44	53	-	32	M16*1.0P	M6*1.0P	2	1	2.1
-120	188.4	120	100.9	19.1	52	62	-	63.55	44	53	-	32	M16*1.0P	M6*1.0P	2	2	2.3
-160	228.4	160	140.9	19.1	52	62	-	63.55	44	53	-	32	M16*1.0P	M6*1.0P	2	2	2.6
-200	268.4	200	180.9	19.1	52	62	-	63.55	44	53	-	32	M16*1.0P	M6*1.0P	2	2	3.1

规格说明:

SK40 - SF - 16 - 80

- L1 长度 Length(L1)
- 刀杆直径 Diameter
- 功能代号 Holder type
- 锥柄形式 Taper size

F SK SHANK SYSTEMS SK 刀柄系列

·SK50-SF 热缩刀柄 (4.5°标准型)

SK50-SF SHRINK FIT TOOL HOLDER(4.5° STANDARD VERSION)

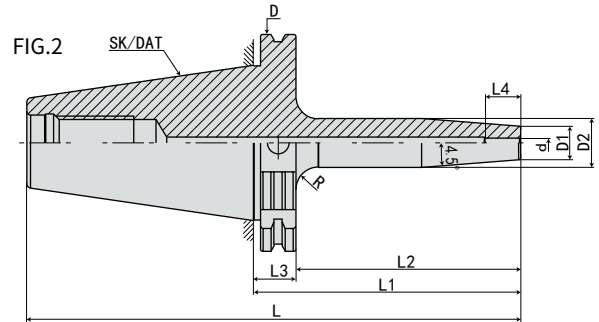
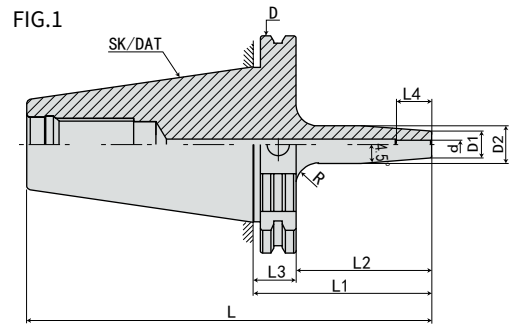

规格 Mode	L	L1	L2	L3	L4	D	D1	D2	d	R	FIG	重量 KGS
SK50-SF03- 80	181.75	80	60.9	19.1	12	97.5	12	17	3	5	1	2.8
-120	221.75	120	100.9	19.1	12	97.5	12	20	3	5	2	2.9
-160	261.75	160	140.9	19.1	12	97.5	12	20	3	5	2	3
-SF04-80	181.75	80	60.9	19.1	16	97.5	12	17	4	5	1	2.8
-120	221.75	120	100.9	19.1	16	97.5	15	22	4	5	2	2.9
-160	261.75	160	140.9	19.1	16	97.5	15	22	4	5	2	3
-SF05-80	181.75	80	60.9	19.1	18	97.5	12	17	5	5	1	2.8
-120	221.75	120	100.9	19.1	18	97.5	15	22	5	5	2	2.9
-160	261.75	160	140.9	19.1	18	97.5	15	22	5	5	2	3

规格说明:

- SK50 - SF - 03 - 80
- SK50: 锥柄形式 Taper size
 - SF: 功能代号 Holder type
 - 03: 刀杆直径 Diameter
 - 80: L1 长度 Length (L1)

·SK50-SF 热缩刀柄 (4.5°标准型)

SK50-SF SHRINK FIT TOOL HOLDER(4.5° STANDARD VERSION)



FIG.1

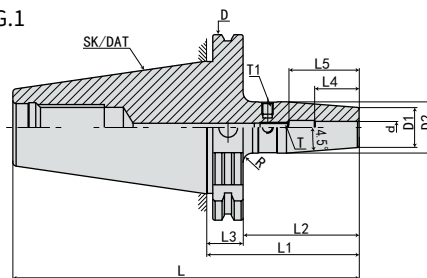

FIG.2

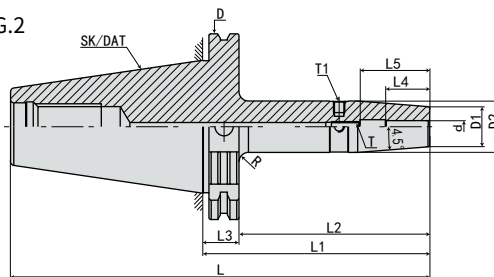
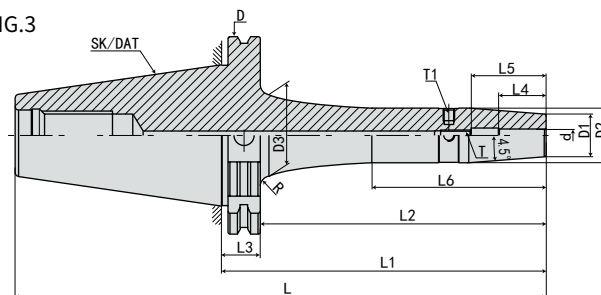
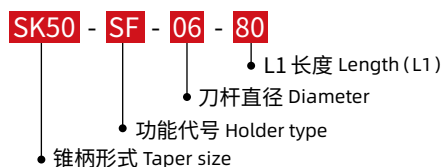

FIG.3



规格 Model	L	L1	L2	L3	L4	L5	L6	D	D1	D2	D3	d	T	T1	FIG	重量 KGS
SK50-SF06- 80	181.75	80	60.9	19.1	26	36		97.5	21	27	-	6	M5*0.8P	M6*1.0P	1	2.8
-SF06-120	221.75	120	100.9	19.1	26	36		97.5	21	27	-	6	M5*0.8P	M6*1.0P	2	2.9
-160	261.75	160	140.9	19.1	26	36	78	97.5	21	27	41	6	M5*0.8P	M6*1.0P	3	3
-200	301.75	200	180.9	19.1	26	36	118	97.5	21	27	41	6	M5*0.8P	M6*1.0P	3	3.1
-SF08- 80	181.75	80	60.9	19.1	26	36		97.5	21	27	-	8	M6*1.0P	M6*1.0P	1	2.8
-120	221.75	120	100.9	19.1	26	36		97.5	21	27	-	8	M6*1.0P	M6*1.0P	2	2.9
-160	261.75	160	140.9	19.1	26	36	78	97.5	21	27	41	8	M6*1.0P	M6*1.0P	3	3
-200	301.75	200	180.9	19.1	26	36	118	97.5	21	27	41	8	M6*1.0P	M6*1.0P	3	3.1
-SF10- 80	181.75	80	60.9	19.1	32	42		97.5	24	32	-	10	M8*1.0P	M6*1.0P	1	2.8
-120	221.75	120	100.9	19.1	32	42		97.5	24	32	-	10	M8*1.0P	M6*1.0P	2	2.9
-160	261.75	160	140.9	19.1	32	42	78	97.5	24	32	40	10	M8*1.0P	M6*1.0P	3	3
-200	301.75	200	180.9	19.1	32	42	118	97.5	24	32	40	10	M8*1.0P	M6*1.0P	3	3.1
-SF12- 80	181.75	80	60.9	19.1	37	47		97.5	24	32	-	12	M10*1.0P	M6*1.0P	1	2.9
-120	221.75	120	100.9	19.1	37	47		97.5	24	32	-	12	M10*1.0P	M6*1.0P	2	3
-160	261.75	160	140.9	19.1	37	47	78	97.5	24	32	40	12	M10*1.0P	M6*1.0P	3	3.1
-200	301.75	200	180.9	19.1	37	47	118	97.5	24	32	40	12	M10*1.0P	M6*1.0P	3	3.2
-SF14- 80	181.75	80	60.9	19.1	37	47		97.5	27	34	-	14	M10*1.0P	M6*1.0P	1	2.9
-120	221.75	120	100.9	19.1	37	47		97.5	27	34	-	14	M10*1.0P	M6*1.0P	2	3
-160	261.75	160	140.9	19.1	37	47	78	97.5	27	34	42	14	M10*1.0P	M6*1.0P	3	3.1
-200	301.75	200	180.9	19.1	37	47	118	97.5	27	34	42	14	M10*1.0P	M6*1.0P	3	3.2

规格说明:



F
SK SHANK SYSTEMS
SK 刀柄系列

·SK50-SF 热缩刀柄 (4.5°标准型)

SK50-SF SHRINK FIT TOOL HOLDER (4.5° STANDARD VERSION)



FIG.1

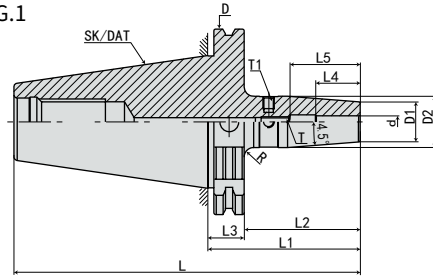

FIG.2

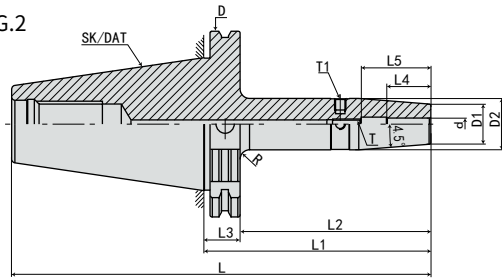
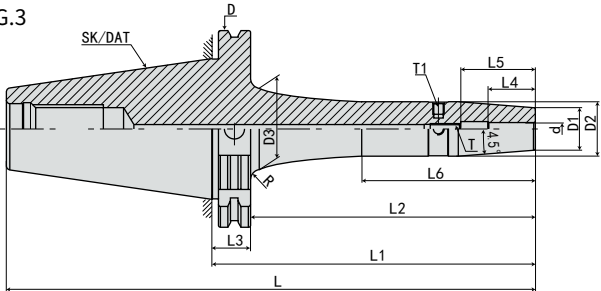
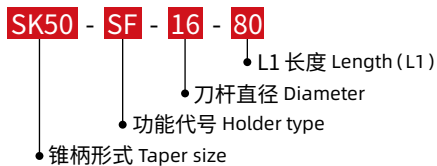

FIG.3



规格 Model	L	L1	L2	L3	L4	L5	L6	D	D1	D2	D3	d	T	T1	FIG	重量 KGS
SK50-SF16- 80	181.75	80	60.9	19.1	40	50		97.5	27	34	-	16	M12*1.0P	M6*1.0P	1	3.1
-120	221.75	120	100.9	19.1	40	50		97.5	27	34	-	16	M12*1.0P	M6*1.0P	2	3.3
-160	261.75	160	140.9	19.1	40	50	78	97.5	27	34	42	16	M12*1.0P	M6*1.0P	3	3.5
-200	301.75	200	180.9	19.1	40	50	118	97.5	27	34	42	16	M12*1.0P	M6*1.0P	3	3.7
-SF18- 80	181.75	80	60.9	19.1	40	50		97.5	33	42	-	18	M12*1.0P	M6*1.0P	1	3.1
-120	221.75	120	100.9	19.1	40	50		97.5	33	42	-	18	M12*1.0P	M6*1.0P	2	3.3
-160	261.75	160	140.9	19.1	40	50		97.5	33	42	-	18	M12*1.0P	M6*1.0P	3	3.5
-200	301.75	200	180.9	19.1	40	50		97.5	33	42	-	18	M12*1.0P	M6*1.0P	3	3.7
-SF20- 80	181.75	80	60.9	19.1	42	52		97.5	33	42	-	20	M16*1.0P	M6*1.0P	1	3.3
-120	221.75	120	100.9	19.1	42	52		97.5	33	42	-	20	M16*1.0P	M6*1.0P	2	3.5
-160	261.75	160	140.9	19.1	42	52		97.5	33	42	-	20	M16*1.0P	M6*1.0P	3	3.7
-200	301.75	200	180.9	19.1	42	52		97.5	33	42	-	20	M16*1.0P	M6*1.0P	3	3.9
-SF25-100	201.75	100	80.9	19.1	48	58		97.5	44	53	-	25	M16*1.0P	M6*1.0P	1	3.3
-120	221.75	120	100.9	19.1	48	58		97.5	44	53	-	25	M16*1.0P	M6*1.0P	2	3.5
-160	261.75	160	140.9	19.1	48	58		97.5	44	53	-	25	M16*1.0P	M6*1.0P	3	3.7
-200	301.75	200	180.9	19.1	48	58		97.5	44	53	-	25	M16*1.0P	M6*1.0P	3	3.9
-SF32-100	201.75	100	80.9	19.1	52	62		97.5	44	53	-	32	M16*1.0P	M6*1.0P	1	3.4
-120	221.75	120	100.9	19.1	52	62		97.5	44	53	-	32	M16*1.0P	M6*1.0P	2	3.6
-160	261.75	160	140.9	19.1	52	62		97.5	44	53	-	32	M16*1.0P	M6*1.0P	3	3.8
-200	301.75	200	180.9	19.1	52	62		97.5	44	53	-	32	M16*1.0P	M6*1.0P	3	4

规格说明:



·SK30-SFS 热缩刀柄 (3°细长型)

SK30-SFS SHRINK FIT TOOL HOLDER (3° SLENDER TYPE)

FIG.1

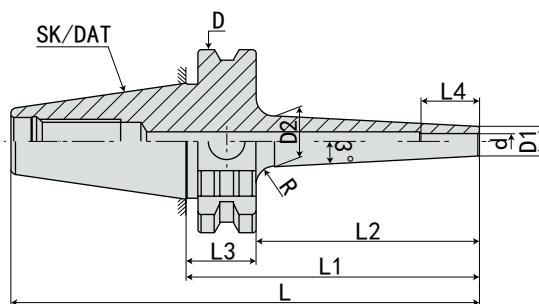
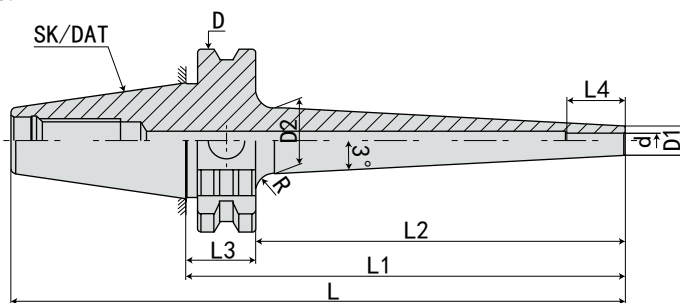
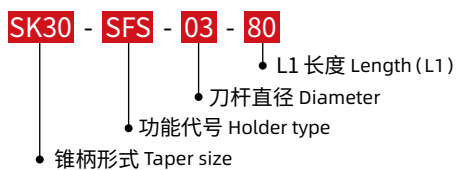

FIG.2



规格 Mode	L	L1	L2	L3	L4	D	D1	D2	d	R	FIG	重量 KGS
SK30-SFS03- 80	127.8	80	60.9	19.1	12	50	7	13	3	5	1	0.6
-120	167.8	120	100.9	19.1	12	50	7	17	3	5	2	0.9
-SFS04- 80	127.8	80	60.9	19.1	16	50	8	14	4	5	1	0.6
-120	167.8	120	100.9	19.1	16	50	8	18	4	5	2	0.9
-SFS05- 80	127.8	80	60.9	19.1	18	50	9	15	5	5	1	0.6
-120	167.8	120	100.9	19.1	18	50	9	19	5	5	2	0.9

规格说明:



·SK30-SFS 热缩刀柄 (3°细长型)

SK30-SFS SHRINK FIT TOOL HOLDER (3° SLENDER TYPE)



FIG.1

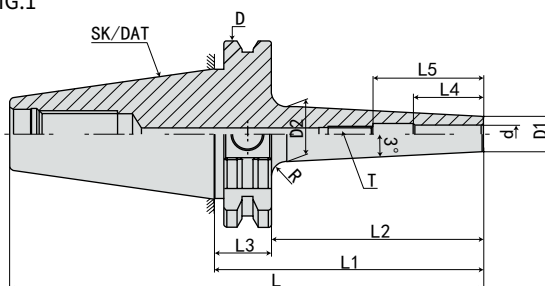
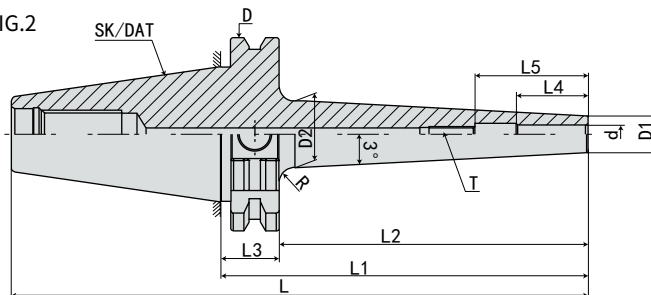

FIG.2



规格 Model	L	L1	L2	L3	L4	L5	D	D1	D2	d	T	R	FIG	重量 KGS
SK30-SFS06- 80	127.8	80	60.9	19.1	26	36	50	10	16	6	M5*0.8P	5	1	0.7
-120	167.8	120	100.9	19.1	26	36	50	10	20	6	M5*0.8P	5	2	1
-SFS08- 80	127.8	80	60.9	19.1	26	36	50	12	16	8	M6*1.0P	5	1	0.7
-120	167.8	120	100.9	19.1	26	36	50	12	20	8	M6*1.0P	5	2	1
-SFS10- 80	127.8	80	60.9	19.1	32	42	50	14	16	10	M8*1.0P	5	1	0.8
-120	167.8	120	100.9	19.1	32	42	50	14	20	10	M8*1.0P	5	2	1.1
-SFS12- 80	127.8	80	60.9	19.1	37	47	50	16	16	12	M10*1.0P	5	1	0.8
-120	167.8	120	100.9	19.1	37	47	50	16	20	12	M10*1.0P	5	2	1.1
-SFS14- 80	127.8	80	60.9	19.1	37	47	50	20	26	14	M10*1.0P	5	1	1
-120	167.8	120	100.9	19.1	37	47	50	20	29	14	M10*1.0P	5	2	1.2
-SFS16- 80	127.8	80	60.9	19.1	40	50	50	22	28	16	M12*1.0P	5	1	1
-120	167.8	120	100.9	19.1	40	50	50	22	31	16	M12*1.0P	5	2	1.2

规格说明:

SK30 - SFS - 06 - 80

- L1 长度 Length (L1)
- 刀杆直径 Diameter
- 功能代号 Holder type
- 锥柄形式 Taper size

·SK40-SFS 热缩刀柄 (3°细长型)

SK40-SFS SHRINK FIT TOOL HOLDER (3° SLENDER TYPE)



FIG.1

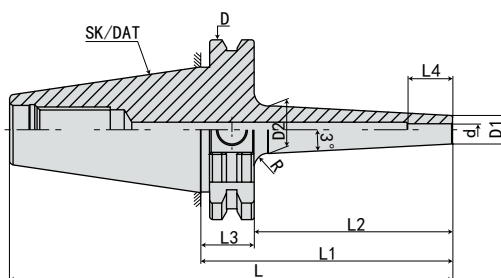
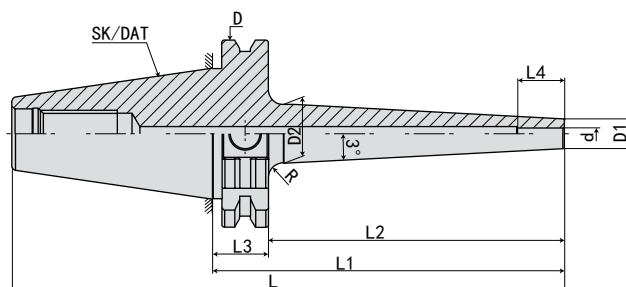

FIG.2



规格 Mode	L	L1	L2	L3	L4	D	D1	D2	d	R	FIG	重量 KGS
SK40-SFS03- 90	158.4	90	70.9	19.1	12	63.55	9	15	3	5	1	1
-120	188.4	120	100.9	19.1	12	63.55	9	16	3	5	2	1.1
-160	228.4	160	140.9	19.1	12	63.55	9	19	3	5	2	1.2
-200	268.4	200	180.9	19.1	12	63.55	9	22	3	5	2	1.3
-SFS04- 90	158.4	90	70.9	19.1	16	63.55	10	16	4	5	1	1
-120	188.4	120	100.9	19.1	16	63.55	10	17	4	5	2	1.1
-160	228.4	160	140.9	19.1	16	63.55	10	20	4	5	2	1.2
-200	268.4	200	180.9	19.1	16	63.55	10	23	4	5	2	1.3
-SFS05- 90	158.4	90	70.9	19.1	18	63.55	11	17	5	5	1	1
-120	188.4	120	100.9	19.1	18	63.55	11	18	5	5	2	1.1
-160	228.4	160	140.9	19.1	18	63.55	11	21	5	5	2	1.2
-200	268.4	200	180.9	19.1	18	63.55	11	24	5	5	2	1.3

规格说明:

SK40 - SFS - 03 - 90

- SK40 锥柄形式 Taper size
- SFS 功能代号 Holder type
- 03 刀杆直径 Diameter
- 90 L1 长度 Length (L1)

·SK40-SFS 热缩刀柄 (3°细长型)

SK40-SFS SHRINK FIT TOOL HOLDER (3° SLENDER TYPE)



FIG.1

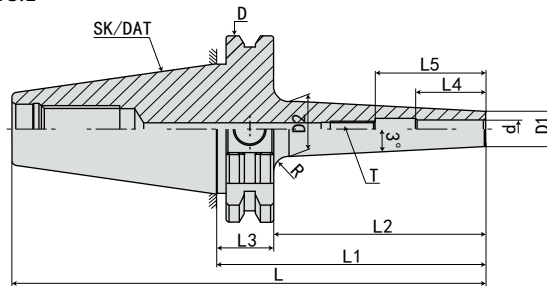
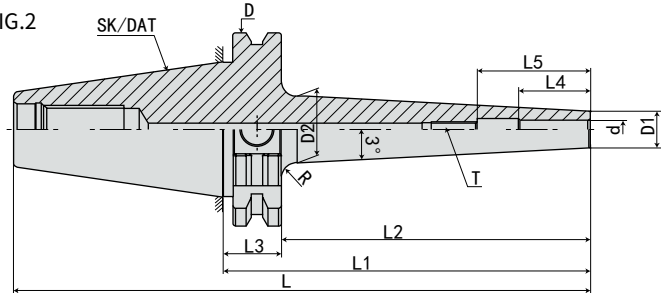
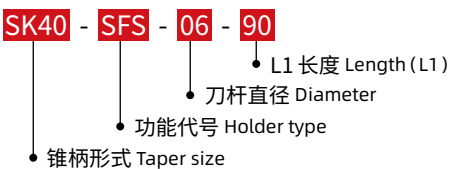

FIG.2



规格 Model	L	L1	L2	L3	L4	L5	D	D1	D2	d	T	R	FIG	重量 KGS
SK40-SFS06- 90	158.4	90	70.9	19.1	26	36	63.55	12	18	6	M5*0.8P	10	1	1.1
-120	188.4	120	100.9	19.1	26	36	63.55	12	21	6	M5*0.8P	10	2	1.2
-160	228.4	160	140.9	19.1	26	36	63.55	12	24	6	M5*0.8P	10	2	1.3
-200	268.4	200	180.9	19.1	26	36	63.55	12	27	6	M5*0.8P	10	2	1.4
-SFS08- 90	158.4	90	70.9	19.1	26	36	63.55	14	20	8	M6*1.0P	10	1	1.1
-120	188.4	120	100.9	19.1	26	36	63.55	14	23	8	M6*1.0P	10	2	1.2
-160	228.4	160	140.9	19.1	26	36	63.55	14	26	8	M6*1.0P	10	2	1.3
-200	268.4	200	180.9	19.1	26	36	63.55	14	29	8	M6*1.0P	10	2	1.4
-SFS10- 90	158.4	90	70.9	19.1	32	42	63.55	16	22	10	M8*1.0P	10	1	1.1
-120	188.4	120	100.9	19.1	32	42	63.55	16	25	10	M8*1.0P	10	2	1.2
-160	228.4	160	140.9	19.1	32	42	63.55	16	28	10	M8*1.0P	10	2	1.3
-200	268.4	200	180.9	19.1	32	42	63.55	16	31	10	M8*1.0P	10	2	1.4
-SFS12- 90	158.4	90	70.9	19.1	37	47	63.55	18	24	12	M10*1.0P	10	1	1.1
-120	188.4	120	100.9	19.1	37	47	63.55	18	27	12	M10*1.0P	10	2	1.2
-160	228.4	160	140.9	19.1	37	47	63.55	18	30	12	M10*1.0P	10	2	1.3
-200	268.4	200	180.9	19.1	37	47	63.55	18	33	12	M10*1.0P	10	2	1.4
-SFS14- 90	158.4	90	70.9	19.1	37	47	63.55	20	26	14	M10*1.0P	10	1	1.2
-120	188.4	120	100.9	19.1	37	47	63.55	20	29	14	M10*1.0P	10	2	1.3
-160	228.4	160	140.9	19.1	37	47	63.55	20	32	14	M10*1.0P	10	2	1.5
-200	268.4	200	180.9	19.1	37	47	63.55	20	35	14	M10*1.0P	10	2	1.7
-SFS16- 90	158.4	90	70.9	19.1	40	50	63.55	22	28	16	M12*1.0P	10	1	1.2
-120	188.4	120	100.9	19.1	40	50	63.55	22	31	16	M12*1.0P	10	2	1.3
-160	228.4	160	140.9	19.1	40	50	63.55	22	34	16	M12*1.0P	10	2	1.5
-200	268.4	200	180.9	19.1	40	50	63.55	22	37	16	M12*1.0P	10	2	1.7
-SFS18- 90	158.4	90	70.9	19.1	40	50	63.55	24	30	18	M12*1.0P	10	1	1.2
-120	188.4	120	100.9	19.1	40	50	63.55	24	33	18	M12*1.0P	10	2	1.3
-160	228.4	160	140.9	19.1	40	50	63.55	24	36	18	M12*1.0P	10	2	1.6
-200	268.4	200	180.9	19.1	40	50	63.55	24	39	18	M12*1.0P	10	2	1.9
-SFS20- 90	158.4	90	70.9	19.1	42	52	63.55	26	32	20	M12*1.0P	10	1	1.3
-120	188.4	120	100.9	19.1	42	52	63.55	26	35	20	M12*1.0P	10	2	1.4
-160	228.4	160	140.9	19.1	42	52	63.55	26	38	20	M12*1.0P	10	2	1.7
-200	268.4	200	180.9	19.1	42	52	63.55	26	41	20	M12*1.0P	10	2	2

规格说明:



·SK50-SFS 热缩刀柄 (3°细长型)

SK50-SFS SHRINK FIT TOOL HOLDER (3° SLENDER TYPE)



FIG.1

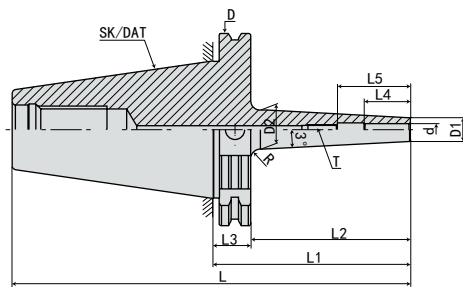
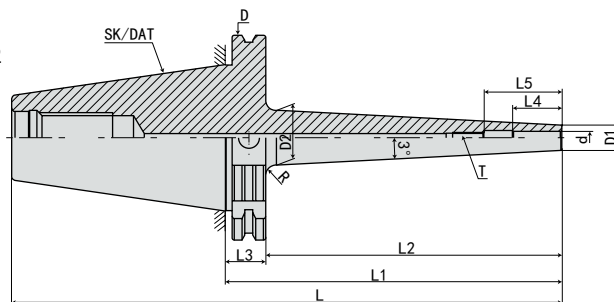

FIG.2



规格 Model	L	L1	L2	L3	L4	L5	D	D1	D2	d	T	R	FIG	重量 KGS
SK50-SFS06-100	201.75	100	80.9	19.1	26	36	97.5	12	18	6	M5*0.8P	10	1	3.8
-120	221.75	120	100.9	19.1	26	36	97.5	12	20	6	M5*0.8P	10	1	3.9
-160	261.75	160	140.9	19.1	26	36	97.5	12	24	6	M5*0.8P	10	2	4.2
-200	301.75	200	180.9	19.1	26	36	97.5	12	28	6	M5*0.8P	10	2	5.8
-SFS08-100	201.75	100	80.9	19.1	26	36	97.5	14	20	8	M6*1.0P	10	1	3.8
-120	221.75	120	100.9	19.1	26	36	97.5	14	22	8	M6*1.0P	10	1	3.9
-160	261.75	160	140.9	19.1	26	36	97.5	14	26	8	M6*1.0P	10	2	4.2
-200	301.75	200	180.9	19.1	26	36	97.5	14	30	8	M6*1.0P	10	2	5.8
-SFS10-100	201.75	100	80.9	19.1	32	42	97.5	16	22	10	M8*1.0P	10	1	3.9
-120	221.75	120	100.9	19.1	32	42	97.5	16	24	10	M8*1.0P	10	1	4.1
-160	261.75	160	140.9	19.1	32	42	97.5	16	28	10	M8*1.0P	10	2	4.3
-200	301.75	200	180.9	19.1	32	42	97.5	16	32	10	M8*1.0P	10	2	5.9
-SFS12-100	201.75	100	80.9	19.1	37	47	97.5	18	24	12	M10*1.0P	10	1	3.9
-120	221.75	120	100.9	19.1	37	47	97.5	18	26	12	M10*1.0P	10	1	4.1
-160	261.75	160	140.9	19.1	37	47	97.5	18	30	12	M10*1.0P	10	2	4.3
-SFS12-200	301.75	200	180.9	19.1	37	47	97.5	18	34	12	M10*1.0P	10	2	5.9
-SFS14-100	201.75	100	80.9	19.1	37	47	97.5	20	26	14	M10*1.0P	10	1	3.9
-120	221.75	120	100.9	19.1	37	47	97.5	20	28	14	M10*1.0P	10	1	4.1
-160	261.75	160	140.9	19.1	37	47	97.5	20	32	14	M10*1.0P	10	2	4.3
-200	301.75	200	180.9	19.1	37	47	97.5	20	36	14	M10*1.0P	10	2	5.9
-SFS16-100	201.75	100	80.9	19.1	40	50	97.5	22	28	16	M12*1.0P	10	1	4
-120	221.75	120	100.9	19.1	40	50	97.5	22	30	16	M12*1.0P	10	1	4.2
-160	261.75	160	140.9	19.1	40	50	97.5	22	34	16	M12*1.0P	10	2	4.4
-200	301.75	200	180.9	19.1	40	50	97.5	22	38	16	M12*1.0P	10	2	6
-SFS18-100	201.75	100	80.9	19.1	40	50	97.5	24	30	18	M12*1.0P	10	1	4
-120	221.75	120	100.9	19.1	40	50	97.5	24	32	18	M12*1.0P	10	1	4.2
-160	261.75	160	140.9	19.1	40	50	97.5	24	36	18	M12*1.0P	10	2	4.4
-200	301.75	200	180.9	19.1	40	50	97.5	24	40	18	M12*1.0P	10	2	6
-SFS20-100	201.75	100	80.9	19.1	42	52	97.5	26	32	20	M16*1.0P	10	1	4.1
-120	221.75	120	100.9	19.1	42	52	97.5	26	34	20	M16*1.0P	10	1	4.3
-160	261.75	160	140.9	19.1	42	52	97.5	26	38	20	M16*1.0P	10	2	4.4
-200	301.75	200	180.9	19.1	42	52	97.5	26	42	20	M16*1.0P	10	2	6.1

规格说明:

SK50 - SFS - 06 - 100

- L1 长度 Length (L1)
- 刀杆直径 Diameter
- 功能代号 Holder type
- 锥柄形式 Taper size

·SK40-SFK 热缩刀柄 (4.5通水型)

SK40-SFK SHRINK FIT TOOL HOLDER (4.5° SHRINK-FIT COOLANT TYPE)

FIG.1

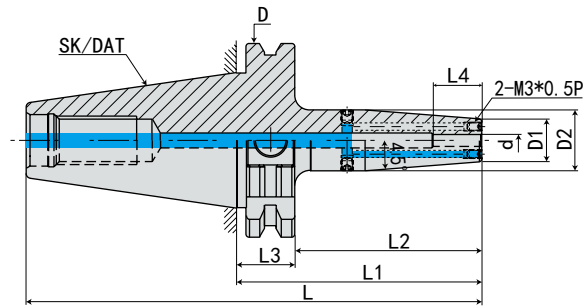
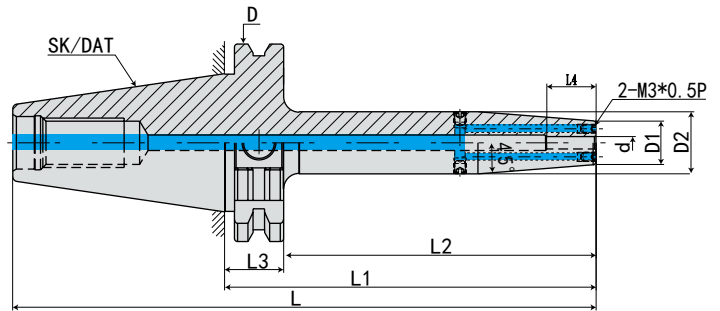

FIG.2



规格 Model	L	L1	L2	L3	L4	D	D1	D2	d	R	FIG	重量 KGS
SK40-SF03- 80K	148.4	80	60.9	19.1	12	63.55	14	20	3	5	1	1
-120K	188.4	120	100.9	19.1	12	63.55	14	20	3	5	2	1.1
-160K	228.4	160	140.9	19.1	12	63.55	14	20	3	5	2	1.2
-SF04- 80K	148.4	80	60.9	19.1	16	63.55	14	20	4	5	1	1
-120K	188.4	120	100.9	19.1	16	63.55	14	20	4	5	2	1.1
-160K	228.4	160	140.9	19.1	16	63.55	14	20	4	5	2	1.2
-SF05- 80K	148.4	80	60.9	19.1	18	63.55	14	20	5	5	1	1
-120K	188.4	120	100.9	19.1	18	63.55	14	20	5	5	2	1.1
-160K	228.4	160	140.9	19.1	18	63.55	14	20	5	5	2	1.2

规格说明:

SK40 - SF - 03 - 80K

- L1 长度 Length (L1)
- 刀杆直径 Diameter
- 功能代号 Holder type
- 锥柄形式 Taper size

·SK40-SFK 热缩刀柄 (4.5°通水型)

SK40-SFK SHRINK FIT TOOL HOLDER (4.5° SHRINK-FIT COOLANT TYPE)



FIG.1

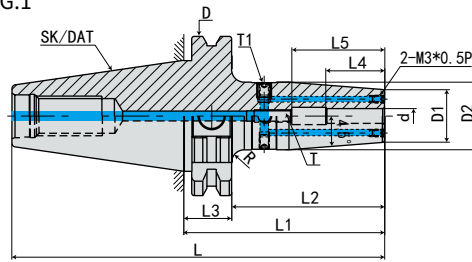

FIG.2

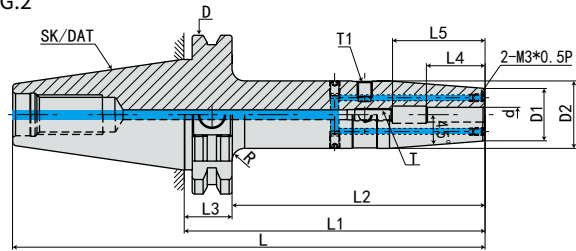
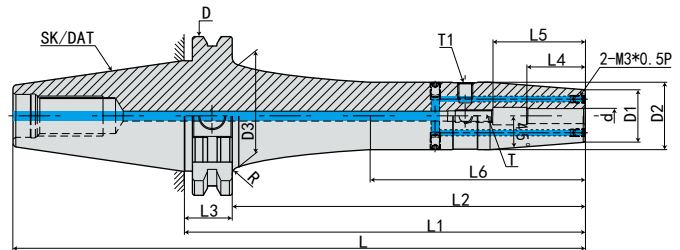
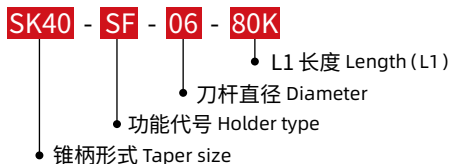

FIG.3



规格 Model	L	L1	L2	L3	L4	L5	L6	D	D1	D2	D3	d	T	T1	FIG	重量 KGS
SK40-SF06- 80K	148.4	80	60.9	19.1	26	36	-	63.55	21	27	-	6	M5*0.8P	M6*1.0P	1	1.2
-120K	188.4	120	100.9	19.1	26	36	-	63.55	21	27	-	6	M5*0.8P	M6*1.0P	2	1.5
-160K	228.4	160	140.9	19.1	26	36	78	63.55	21	27	41	6	M5*0.8P	M6*1.0P	3	1.8
-200K	268.4	200	180.9	19.1	26	36	118	63.55	21	27	41	6	M5*0.8P	M6*1.0P	3	2.2
-SF08- 80K	148.4	80	60.9	19.1	26	36	-	63.55	21	27	-	8	M6*1.0P	M6*1.0P	1	1.2
-120K	188.4	120	100.9	19.1	26	36	-	63.55	21	27	-	8	M6*1.0P	M6*1.0P	2	1.5
-160K	228.4	160	140.9	19.1	26	36	78	63.55	21	27	41	8	M6*1.0P	M6*1.0P	3	1.8
-200K	268.4	200	180.9	19.1	26	36	118	63.55	21	27	41	8	M6*1.0P	M6*1.0P	3	2.2
-SF10- 80K	148.4	80	60.9	19.1	32	42	-	63.55	24	32	-	10	M8*1.0P	M6*1.0P	1	1.3
-120K	188.4	120	100.9	19.1	32	42	-	63.55	24	32	-	10	M8*1.0P	M6*1.0P	2	1.6
-160K	228.4	160	140.9	19.1	32	42	78	63.55	24	32	40	10	M8*1.0P	M6*1.0P	3	1.9
-200K	268.4	200	180.9	19.1	32	42	118	63.55	24	32	40	10	M8*1.0P	M6*1.0P	3	2.3
-SF12- 80K	148.4	80	60.9	19.1	37	47	-	63.55	24	32	-	12	M10*1.0P	M6*1.0P	1	1.3
-120K	188.4	120	100.9	19.1	37	47	-	63.55	24	32	-	12	M10*1.0P	M6*1.0P	2	1.6
-160K	228.4	160	140.9	19.1	37	47	78	63.55	24	32	40	12	M10*1.0P	M6*1.0P	3	1.9
-200K	268.4	200	180.9	19.1	37	47	118	63.55	24	32	40	12	M10*1.0P	M6*1.0P	3	2.3
-SF14- 80K	148.4	80	60.9	19.1	37	47	-	63.55	27	34	-	14	M10*1.0P	M6*1.0P	1	1.3
-120K	188.4	120	100.9	19.1	37	47	-	63.55	27	34	-	14	M10*1.0P	M6*1.0P	2	1.6
-160K	228.4	160	140.9	19.1	37	47	78	63.55	27	34	42	14	M10*1.0P	M6*1.0P	3	1.9
-200K	268.4	200	180.9	19.1	37	47	118	63.55	27	34	42	14	M10*1.0P	M6*1.0P	3	2.3

规格说明:



·SK40-SFK 热缩刀柄 (4.5通水型)

SK40-SFK SHRINK FIT TOOL HOLDER (4.5° SHRINK-FIT COOLANT TYPE)



FIG.1

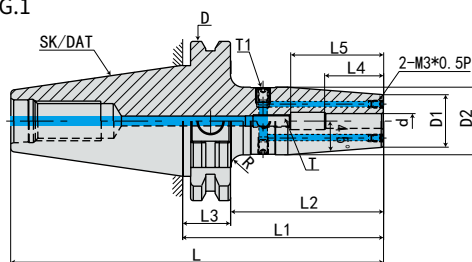

FIG.2

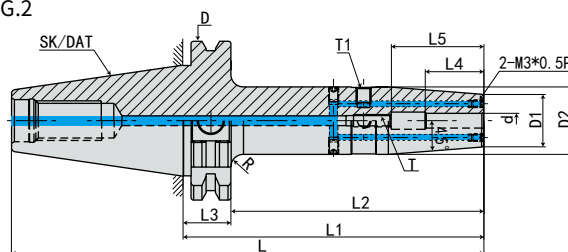
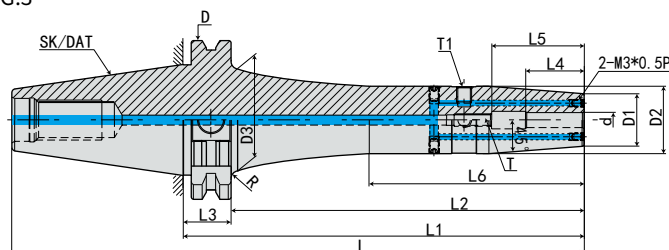

FIG.3



规格 Model	L	L1	L2	L3	L4	L5	L6	D	D1	D2	D3	d	T	T1	FIG	重量 KGS
SK40-SF16- 80K	148.4	80	60.9	19.1	40	50	-	63.55	27	34	-	16	M12*1.0P	M6*1.0P	1	1.3
-120K	188.4	120	100.9	19.1	40	50	-	63.55	27	34	-	16	M12*1.0P	M6*1.0P	2	1.6
-160K	228.4	160	140.9	19.1	40	50	78	63.55	27	34	42	16	M12*1.0P	M6*1.0P	3	1.9
-200K	268.4	200	180.9	19.1	40	50	118	63.55	27	34	42	16	M12*1.0P	M6*1.0P	3	2.3
-SF18- 80K	148.4	80	60.9	19.1	40	50	-	63.55	33	42	-	18	M12*1.0P	M6*1.0P	1	1.4
-120K	188.4	120	100.9	19.1	40	50	-	63.55	33	42	-	18	M12*1.0P	M6*1.0P	2	1.7
-160K	228.4	160	140.9	19.1	40	50	-	63.55	33	42	-	18	M12*1.0P	M6*1.0P	2	2
-200K	268.4	200	180.9	19.1	40	50	-	63.55	33	42	-	18	M12*1.0P	M6*1.0P	2	2.4
-SF20- 80K	148.4	80	60.9	19.1	42	52	-	63.55	33	42	-	20	M16*1.0P	M6*1.0P	1	1.4
-120K	188.4	120	100.9	19.1	42	52	-	63.55	33	42	-	20	M16*1.0P	M6*1.0P	2	1.7
-160K	228.4	160	140.9	19.1	42	52	-	63.55	33	42	-	20	M16*1.0P	M6*1.0P	2	2
-200K	268.4	200	180.9	19.1	42	52	-	63.55	33	42	-	20	M16*1.0P	M6*1.0P	2	2.4
-SF25- 80K	148.4	80	60.9	19.1	48	58	-	63.55	44	53	-	25	M16*1.0P	M6*1.0P	1	2
-120K	188.4	120	100.9	19.1	48	58	-	63.55	44	53	-	25	M16*1.0P	M6*1.0P	2	2.3
-160K	228.4	160	140.9	19.1	48	58	-	63.55	44	53	-	25	M16*1.0P	M6*1.0P	2	2.6
-200K	268.4	200	180.9	19.1	48	58	-	63.55	44	53	-	25	M16*1.0P	M6*1.0P	2	3
-SF32- 80K	148.4	80	60.9	19.1	52	62	-	63.55	44	53	-	32	M16*1.0P	M6*1.0P	1	2
-120K	188.4	120	100.9	19.1	52	62	-	63.55	44	53	-	32	M16*1.0P	M6*1.0P	2	2.3
-160K	228.4	160	140.9	19.1	52	62	-	63.55	44	53	-	32	M16*1.0P	M6*1.0P	2	2.6
-200K	268.4	200	180.9	19.1	52	62	-	63.55	44	53	-	32	M16*1.0P	M6*1.0P	2	3

规格说明:

SK40 - SF - 16 - 80K

- L1 长度 Length (L1)
- 刀杆直径 Diameter
- 功能代号 Holder type
- 锥柄形式 Taper size



·SK50-SFK 热缩刀柄 (4.5通水型)

SK50-SFK SHRINK FIT TOOL HOLDER (4.5° SHRINK-FIT COOLANT TYPE)

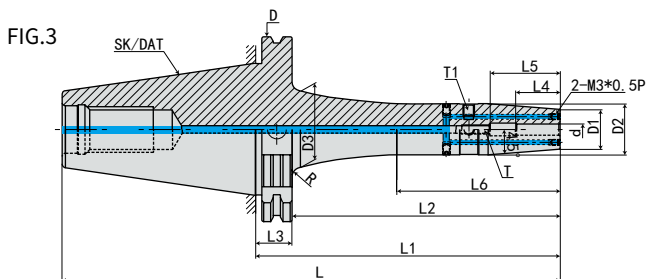
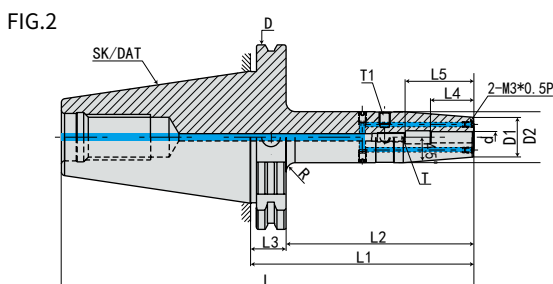
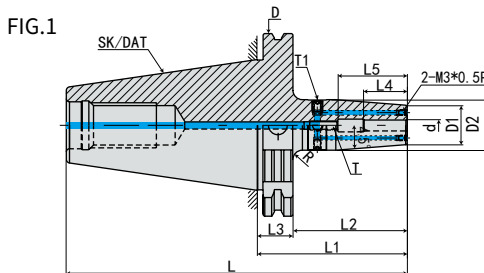

规格 Model	L	L1	L2	L3	L4	L5	L6	D	D1	D2	D3	d	T	T1	FIG	重量 KGS
SK50-SF06- 80K	181.75	80	60.9	19.1	26	36	-	97.5	21	27	-	6	M5*0.8P	M6*1.0P	1	2.8
-120K	221.75	120	100.9	19.1	26	36	-	97.5	21	27	-	6	M5*0.8P	M6*1.0P	2	2.9
-160K	261.75	160	140.9	19.1	26	36	78	97.5	21	27	41	6	M5*0.8P	M6*1.0P	3	3
-200K	301.75	200	180.9	19.1	26	36	118	97.5	21	27	41	6	M5*0.8P	M6*1.0P	3	3.1
-SF08- 80K	181.75	80	60.9	19.1	26	36	-	97.5	21	27	-	8	M6*1.0P	M6*1.0P	1	2.8
-120K	221.75	120	100.9	19.1	26	36	-	97.5	21	27	-	8	M6*1.0P	M6*1.0P	2	2.9
-160K	261.75	160	140.9	19.1	26	36	78	97.5	21	27	41	8	M6*1.0P	M6*1.0P	3	3
-200K	301.75	200	180.9	19.1	26	36	118	97.5	21	27	41	8	M6*1.0P	M6*1.0P	3	3.1
-SF10- 80K	181.75	80	60.9	19.1	32	42	-	97.5	24	32	-	10	M8*1.0P	M6*1.0P	1	2.8
-120K	221.75	120	100.9	19.1	32	42	-	97.5	24	32	-	10	M8*1.0P	M6*1.0P	2	2.9
-160K	261.75	160	140.9	19.1	32	42	78	97.5	24	32	40	10	M8*1.0P	M6*1.0P	3	3
-200K	301.75	200	180.9	19.1	32	42	118	97.5	24	32	40	10	M8*1.0P	M6*1.0P	3	3.1
-SF12- 80K	181.75	80	60.9	19.1	37	47	-	97.5	24	32	-	12	M10*1.0P	M6*1.0P	1	2.9
-120K	221.75	120	100.9	19.1	37	47	-	97.5	24	32	-	12	M10*1.0P	M6*1.0P	2	3
-160K	261.75	160	140.9	19.1	37	47	78	97.5	24	32	40	12	M10*1.0P	M6*1.0P	3	3.1
-200K	301.75	200	180.9	19.1	37	47	118	97.5	24	32	40	12	M10*1.0P	M6*1.0P	3	3.2
-SF14- 80K	181.75	80	60.9	19.1	37	47	-	97.5	27	34	-	14	M10*1.0P	M6*1.0P	1	2.9
-120K	221.75	120	100.9	19.1	37	47	-	97.5	27	34	-	14	M10*1.0P	M6*1.0P	2	3
-160K	261.75	160	140.9	19.1	37	47	78	97.5	27	34	42	14	M10*1.0P	M6*1.0P	3	3.1
-200K	301.75	200	180.9	19.1	37	47	118	97.5	27	34	42	14	M10*1.0P	M6*1.0P	3	3.2

规格说明:

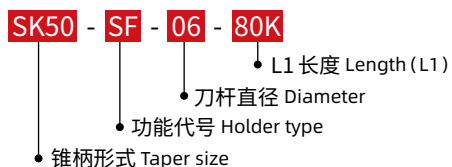

F
SK SHANK SYSTEMS
SK 刀柄系列

·SK50-SFK 热缩刀柄 (4.5通水型)

SK50-SFK SHRINK FIT TOOL HOLDER (4.5° SHRINK-FIT COOLANT TYPE)

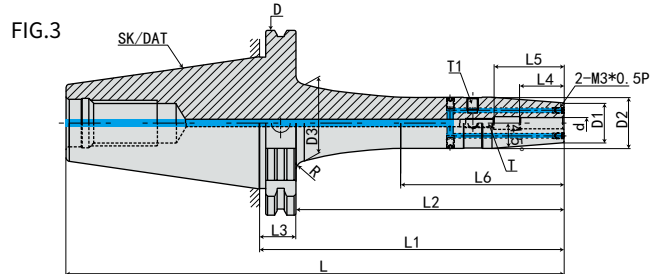
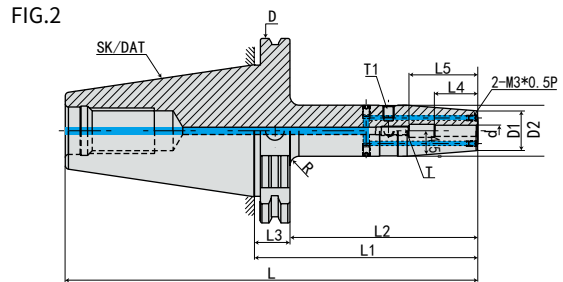
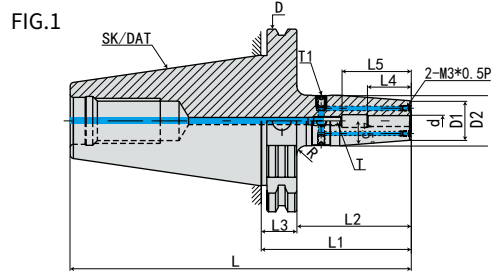

规格 Model	L	L1	L2	L3	L4	L5	L6	D	D1	D2	D3	d	T	T1	FIG	重量 KGS
SK50-SF16- 80K	181.75	80	60.9	19.1	40	50	-	97.5	27	34	-	16	M12*1.0P	M6*1.0P	1	3.1
-120K	221.75	120	100.9	19.1	40	50	-	97.5	27	34	-	16	M12*1.0P	M6*1.0P	2	3.3
-160K	261.75	160	140.9	19.1	40	50	78	97.5	27	34	42	16	M12*1.0P	M6*1.0P	3	3.5
-200K	301.75	200	180.9	19.1	40	50	118	97.5	27	34	42	16	M12*1.0P	M6*1.0P	3	3.7
-SF18- 80K	181.75	80	60.9	19.1	40	50	-	97.5	33	42	-	18	M12*1.0P	M6*1.0P	1	3.1
-120K	221.75	120	100.9	19.1	40	50	-	97.5	33	42	-	18	M12*1.0P	M6*1.0P	2	3.3
-160K	261.75	160	140.9	19.1	40	50	-	97.5	33	42	-	18	M12*1.0P	M6*1.0P	3	3.5
-200K	301.75	200	180.9	19.1	40	50	-	97.5	33	42	-	18	M12*1.0P	M6*1.0P	3	3.7
-SF20- 80K	181.75	80	60.9	19.1	42	52	-	97.5	33	42	-	20	M16*1.0P	M6*1.0P	1	3.3
-120K	221.75	120	100.9	19.1	42	52	-	97.5	33	42	-	20	M16*1.0P	M6*1.0P	2	3.5
-160K	261.75	160	140.9	19.1	42	52	-	97.5	33	42	-	20	M16*1.0P	M6*1.0P	3	3.7
-200K	301.75	200	180.9	19.1	42	52	-	97.5	33	42	-	20	M16*1.0P	M6*1.0P	3	3.9
-SF25-100K	201.75	100	80.9	19.1	48	58	-	97.5	44	53	-	25	M16*1.0P	M6*1.0P	1	3.3
-120K	221.75	120	100.9	19.1	48	58	-	97.5	44	53	-	25	M16*1.0P	M6*1.0P	2	3.5
-160K	261.75	160	140.9	19.1	48	58	-	97.5	44	53	-	25	M16*1.0P	M6*1.0P	3	3.7
-200K	301.75	200	180.9	19.1	48	58	-	97.5	44	53	-	25	M16*1.0P	M6*1.0P	3	3.9
-SF32-100K	201.75	100	80.9	19.1	52	62	-	97.5	44	53	-	32	M16*1.0P	M6*1.0P	1	3.4
-120K	221.75	120	100.9	19.1	52	62	-	97.5	44	53	-	32	M16*1.0P	M6*1.0P	2	3.6
-160K	261.75	160	140.9	19.1	52	62	-	97.5	44	53	-	32	M16*1.0P	M6*1.0P	3	3.8
-200K	301.75	200	180.9	19.1	52	62	-	97.5	44	53	-	32	M16*1.0P	M6*1.0P	3	4

规格说明:

SK50 - SF - 16 - 80K

- L1 长度 Length (L1)
- 刀杆直径 Diameter
- 功能代号 Holder type
- 锥柄形式 Taper size

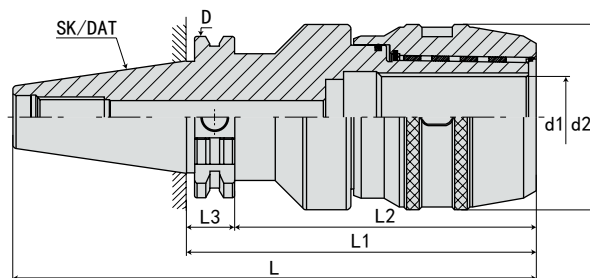
·SK-C 型高精度强力刀柄
SK-C FORCE MILLING CHUCK

规格 Model	L	L1	L2	L3	d1	d2	D	夹持范围 Range
SK30-C20- 85	132.8	85	66	19.1	20	56	50	3 4 5 6 8 10 12 14 16
-100	147.8	100	81	19.1	20	56	50	3 4 5 6 8 10 12 14 16
-C32-105	152.8	105	86	19.1	32	68	50	3 4 5 6 8 10 12 14 16 18 20 22 24 25
SK40-C20- 85	132.8	85	66	19.1	20	56	63.55	3 4 5 6 8 10 12 14 16
-100	147.8	100	81	19.1	20	56	63.55	3 4 5 6 8 10 12 14 16
-135	182.8	135	116	19.1	20	56	63.55	3 4 5 6 8 10 12 14 16
-C25-100	147.8	100	81	19.1	25	61	63.55	3 4 5 6 8 10 12 14 16 18 20
-135	182.8	135	116	19.1	25	61	63.55	3 4 5 6 8 10 12 14 16 18 20
-C32-105	152.8	105	86	19.1	32	68	63.55	3 4 5 6 8 10 12 14 16 18 20 22 24 25
-135	182.8	135	116	19.1	32	68	63.55	3 4 5 6 8 10 12 14 16 18 20 22 24 25
SK50-C20-105	206.75	105	86	19.1	20	56	97.5	3 4 5 6 8 10 12 14 16
-150	251.75	150	131	19.1	20	56	97.5	3 4 5 6 8 10 12 14 16
-C25-105	206.75	105	86	19.1	25	61	97.5	3 4 5 6 8 10 12 14 16 18 20
-165	266.75	165	146	19.1	25	61	97.5	3 4 5 6 8 10 12 14 16 18 20
-C32-110	211.75	110	91	19.1	32	68	97.5	3 4 5 6 8 10 12 14 16 18 20 22 24 25
-165	266.75	165	146	19.1	32	68	97.5	3 4 5 6 8 10 12 14 16 18 20 22 24 25
-200	301.75	200	181	19.1	32	68	97.5	3 4 5 6 8 10 12 14 16 18 20 22 24 25
-C42-110	211.75	110	94	19.1	42	87	97.5	3 4 5 6 8 10 12 14 16 18 20 22 24 25 28 30 32 34 36
-150	251.75	150	131	19.1	42	87	97.5	3 4 5 6 8 10 12 14 16 18 20 22 24 25 28 30 32 34 36

特点:

高速、高精度、高寿命直柄刀具系列

- ◎ 材质: 20CrMnTi/15CrMn
- ◎ 硬度: HRC58-60, 渗碳深度 > 0.8mm
- ◎ 锥柄公差等级: ≤ AT3
- ◎ 刀柄内孔分割了六槽, 以防止刀具转动, 增大夹持力
- ◎ 采用特殊材料制作滚针轴承保持架, 延长使用寿命, 增强夹紧力
- ◎ 具有夹持力大, 定点精度高, 特别适用于强力切削
- ◎ 可提供两种外观: 光饰或涂层处理
- ◎ 内孔多次研磨, 可达 Ra0.4, 起到镜面效果
- ◎ 外圆及端面多次研磨, 可达 Ra0.4, 起到镜面效果
- ◎ 表面“环保”特殊涂层处理, 提高表面硬度、耐磨性, 提高清洁度, 精度更稳定, 表面更光滑, 防锈、防腐蚀效果更好, 手感更舒适, 外观更美观
- ◎ 扳手、拉钉、筒夹须另行购买

Features:

High speed, high accuracy, high durability C-STRAIGHT TOOL SERIES

- ◎ Material: 20CrMnTi/15CrMn;
- ◎ Hardness: HRC58-60, Carbon depth > 0.8 ◎ Tolerance class: ≤ AT3
- ◎ Inner hole of the shank divide into 6 troughs to prevent the insert remove, increase the grasp force
- ◎ Ball bearing cage is made of special material, improve the endurance, enhance the grasp force
- ◎ Grasp force strong, centering accuracy high, suit to heavy cutting
- ◎ Two kinds looks provide: polishing or chemical nickel-plating processing;
- ◎ Inner hole grinding for many times, so as to reach Ra0.4, has a mirror effect;
- ◎ End and the cylindrical are grinding for many times, can reach Ra0.4, has a mirror effect;
- ◎ Surface "environmental protection", special coating surface treatment, improve the hardness and endurance of the surface, cleanliness better, accuracy stable, surface more smooth, antirust, feel comfortable, appearance nice.
- ◎ The spanner、pull stud chuck must purchase alone.

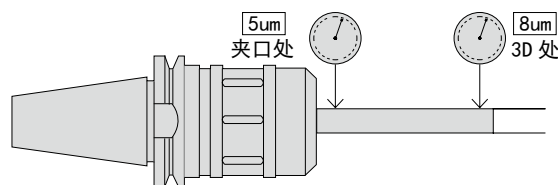
规格说明:

F
 SK SHANK SYSTEMS
SK 刀柄系列

·SK30-ER 弹性筒夹刀柄

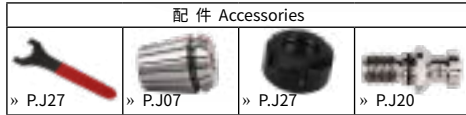
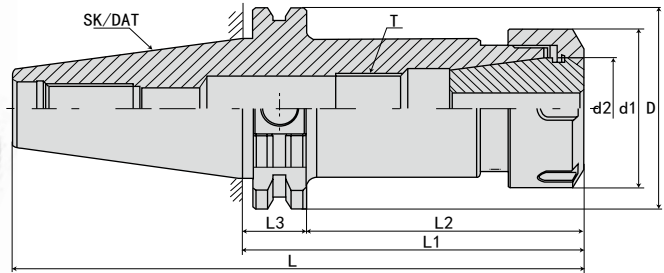
SK30-ER COLLET CHUCK



规格 Model	L	L1	L2	L3	d1	d2	D	夹持范围 Range	重量 KGS
SK30-ER11- 80	127.8	80	61	19.1	19	11	50	1-7mm	0.6
-ER16- 63	110.8	63	44	19.1	28	16	50	1-10mm	0.7
-120	167.8	120	101	19.1	28	16	50	1-10mm	0.85
-ER20- 63	110.8	63	44	19.1	34	20	50	1-13mm	0.8
-120	167.8	120	101	19.1	34	20	50	1-13mm	1.05
-ER25- 63	110.8	63	44	19.1	42	25	50	1-16mm	0.85
-ER32- 63	110.8	63	44	19.1	50	32	50	2-20mm	0.90

特点:

注:

- ◎ 本体锥柄规格: DIN69871-A 或 GB10944
- ◎ 配用 ER 弹性筒夹, 可适用于夹持铣刀、钻头、丝锥
- ◎ 装置时筒夹必需先置入螺母, 再装入刀具, 接着锁固入本体
- ◎ 适用专用扳手, 不可用其它工具, 可能造成刀体损坏
- ◎ 扳手、拉钉、筒夹须另行购买

Features:

- ◎ Spindle conicity standard: DIN69871A or GB10944.
- ◎ ER collet chuck set with ER collet with flexibility used for gripping cutting tool, drill bit, draw bolt and so on.
- ◎ When using, nut should be clamped tensed firstly with cutting tools then locked into the main body.
- ◎ Always use the recommended wrench or spanner, unless, there might cause damage of cutting tools.
- ◎ The spanner, pull stud chuck must purchase alone.

规格说明:

SK30 - ER - 11 - 80

- L1 长度 Length (L1)
- 筒夹型号 Collect model
- 筒夹种类 Collect type ER
- 锥柄形式 Taper size

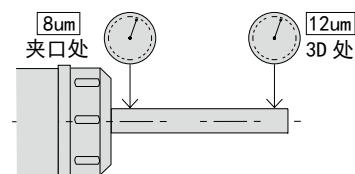

·SK40-ER 弹性筒夹刀柄

SK40-ER COLLET CHUCK

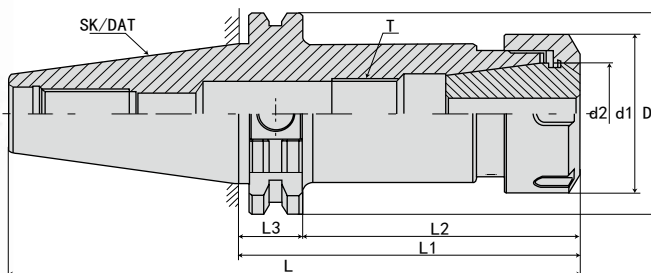

规格 Model	L	L1	L2	L3	d1	d2	D	夹持范围 Range	重量 KGS
SK40-ER11- 80	148.4	80	61	19.1	19	11	63.55	1-7mm	1.05
-100	168.4	100	81	19.1	19	11	63.55	1-7mm	1.1
-150	218.4	150	131	19.1	19	11	63.55	1-7mm	
-ER16-100	168.4	100	81	19.1	28	16	63.55	1-10mm	1.4
-150	218.4	150	131	19.1	28	16	63.55	1-10mm	1.65
-200	268.4	200	181	19.1	28	16	63.55	1-10mm	
-ER20- 70	138.4	70	51	19.1	34	20	63.55	1-13mm	1.4
-100	168.4	100	81	19.1	34	20	63.55	1-13mm	1.5
-150	218.4	150	131	19.1	34	20	63.55	1-13mm	
-200	268.4	200	181	19.1	34	20	63.55	1-13mm	
-ER25- 70	138.4	70	51	19.1	42	25	63.55	1-16mm	1.6
-100	168.4	100	81	19.1	42	25	63.55	1-16mm	1.85
-150	218.4	150	131	19.1	42	25	63.55	1-16mm	2.25
-200	268.4	200	181	19.1	42	25	63.55	1-16mm	2.55
-ER32- 70	138.4	70	51	19.1	50	32	63.55	2-20mm	1.6
-100	168.4	100	81	19.1	50	32	63.55	2-20mm	2.0
-150	218.4	150	131	19.1	50	32	63.55	2-20mm	2.65
-200	268.4	200	181	19.1	50	32	63.55	2-20mm	3.2
-ER40- 70	138.4	70	51	19.1	63	40	63.55	2-26mm	1.5
-100	168.4	100	81	19.1	63	40	63.55	2-26mm	2.0
-150	233.4	150	131	19.1	63	40	63.55	2-26mm	3.8
-200	268.4	200	181	19.1	63	40	63.55	2-26mm	
-ER50-100	168.4	100	81	19.1	78	50	63.55	6-34mm	1.7

特点:

注:

- ◎ 本体锥柄规格: DIN69871-A 或 GB10944
- ◎ 配用 ER 弹性筒夹, 可适用于夹持铣刀、钻头、丝锥
- ◎ 装置时筒夹必需先置入螺母, 再装入刀具, 接着锁固入本体
- ◎ 适用专用扳手, 不可用其它工具, 可能造成刀体损坏
- ◎ 扳手、拉钉、筒夹须另行购买

Features:

- ◎ Spindle conicity standard: DIN69871A or GB10944.
- ◎ ER collet chuck set with ER collet with flexibility used for gripping cutting tool, drill bit, draw bolt and so on.
- ◎ When using, nut should be clamped tensed firstly with cutting tools then locked into the main body.
- ◎ Always use the recommended wrench or spanner, unless, there might cause damage of cutting tools.
- ◎ The spanner, pull stud chuck must purchase alone.

规格说明:

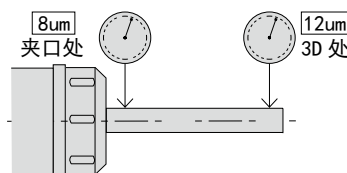

·SK50-ER 弹性筒夹刀柄

SK50-ER COLLET CHUCK

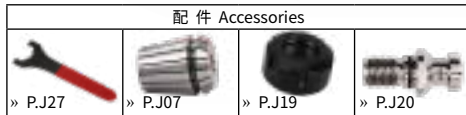
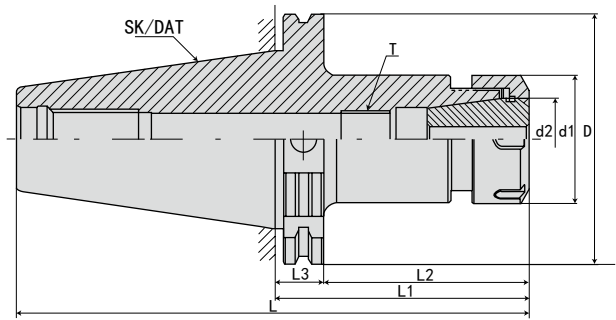

规格 Model	L	L1	L2	L3	d1	d2	D	夹持范围 Range	重量 KGS
SK50-ER16-100	201.75	100	81	19.1	28	16	97.5	1-10mm	3.2
-150	251.75	150	131	19.1	28	16	97.5	1-10mm	
-200	301.75	200	181	19.1	28	16	97.5	1-10mm	4.7
-250	351.75	250	231	19.1	28	16	97.5	1-10mm	
-ER20- 70	171.5	70	51	19.1	34	20	97.5	1-13mm	
-100	201.75	100	81	19.1	34	20	97.5	1-13mm	3.4
-150	251.75	150	131	19.1	34	20	97.5	1-13mm	
-200	301.75	200	181	19.1	34	20	97.5	1-13mm	4.7
-250	351.75	250	231	19.1	34	20	97.5	1-13mm	
-ER25- 80	181.75	80	61	19.1	42	25	97.5	1-16mm	
-100	201.75	100	81	19.1	42	25	97.5	1-16mm	4.15
-150	251.75	150	131	19.1	42	25	97.5	1-16mm	4.5
-200	301.75	200	181	19.1	42	25	97.5	1-16mm	4.8
-250	351.75	250	231	19.1	42	25	97.5	1-16mm	
-300	401.75	300	281	19.1	42	25	97.5	1-16mm	
-ER32- 80	181.75	80	61	19.1	50	32	97.5	2-20mm	3.6
-100	201.75	100	81	19.1	50	32	97.5	2-20mm	
-150	251.75	150	131	19.1	50	32	97.5	2-20mm	
-200	301.75	200	181	19.1	50	32	97.5	2-20mm	5.1
-250	351.75	250	231	19.1	50	32	97.5	2-20mm	5.3
-300	401.75	300	281	19.1	50	32	97.5	2-20mm	6
-ER40- 80	181.75	80	61	19.1	63	40	97.5	2-26mm	3.5
-100	201.75	100	81	19.1	63	40	97.5	2-26mm	
-150	251.75	150	131	19.1	63	40	97.5	2-26mm	
-200	301.75	200	181	19.1	63	40	97.5	2-26mm	5.2
-250	351.75	250	231	19.1	63	40	97.5	2-26mm	5.8
-300	401.75	300	281	19.1	63	40	97.5	2-26mm	6.5
-ER50-160	261.75	160	141	19.1	78	50	97.5	6-34mm	5.55

特点:

注:

- ◎ 本体锥柄规格: DIN69871-A 或 GB10944
- ◎ 配用 ER 弹性筒夹, 可适用于夹持铣刀、钻头、丝锥
- ◎ 装置时筒夹必需先置入螺母, 再装入刀具, 接着锁固入本体
- ◎ 适用专用扳手, 不可用其它工具, 可能造成刀体损坏
- ◎ 扳手、拉钉、筒夹须另行购买

规格说明:



Features:

- ◎ Spindle conicity standard: DIN69871A or GB10944.
- ◎ ER collet chuck set with ER collet with flexibility used for gripping cutting tool, drill bit, draw bolt and so on.
- ◎ When using, nut should be clamped tensed firstly with cutting tools then locked into the main body.
- ◎ Always use the recommended wrench or spanner, unless, there might cause damage of cutting tools.
- ◎ The spanner, pull stud chuck must purchase alone.

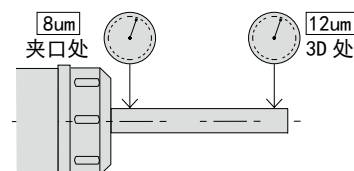

·SK-FMB 平面铣刀柄

SK-FMB FACE MILL ARBOR

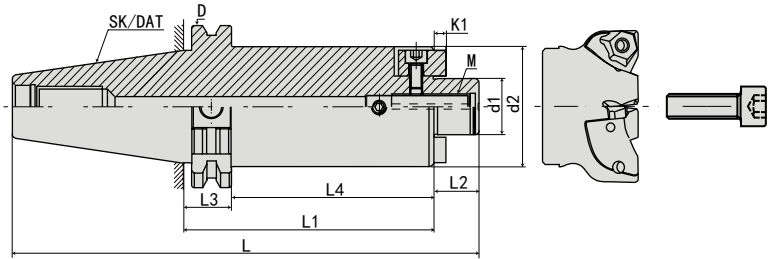

规格 Model	L	L1	L2	L3	L4	D	d1	d2	k1	k2	螺孔 M
SK30-FMB22- 35	100.8	35	18	19.1	16	50	22	48	4.8	10	M10*1.5P
-FMB27- 35	102.8	35	20	19.1	16	50	27	58	5.8	12	M12*1.75P
SK40-FMB22- 45	131.4	45	18	19.1	26	63.55	22	48	4.8	10	M10*1.5P
- 60	146.4	60	18	19.1	41	63.55	22	48	4.8	10	M10*1.5P
-100	186.4	100	18	19.1	81	63.55	22	48	4.8	10	M10*1.5P
-150	236.4	150	18	19.1	131	63.55	22	48	4.8	10	M10*1.5P
-FMB27- 45	133.4	45	20	19.1	26	63.55	27	58	5.8	12	M12*1.75P
- 60	148.4	60	20	19.1	41	63.55	27	58	5.8	12	M12*1.75P
-100	163.4	100	20	19.1	81	63.55	27	58	5.8	12	M12*1.75P
-FMB32- 45	110.4	45	22	19.1	26	63.55	32	70	6.8	14	M16*2.0P
- 60	125.4	60	22	19.1	41	63.55	32	70	6.8	14	M16*2.0P
-100	165.4	100	22	19.1	81	63.55	32	70	6.8	14	M16*2.0P
-FMB40- 45	113.4	45	25	19.1	26	63.55	40	80	8.3	16	M16*2.0P
- 60	128.4	60	25	19.1	41	63.55	40	80	8.3	16	M16*2.0P
-100	168.4	100	25	19.1	81	63.55	40	80	8.3	16	M16*2.0P

特点:

注:

- ◎ 本体锥柄规格: DIN69871-A 或 GB10944
- ◎ 中心通孔有利于出水及抗震性强
- ◎ 平面铣刀配合部位 (d) 轴系公轴 h6
- ◎ 适用于平面铣削加工
- ◎ 可定制非常规长度
- ◎ 拉钉须另行购买

规格说明:

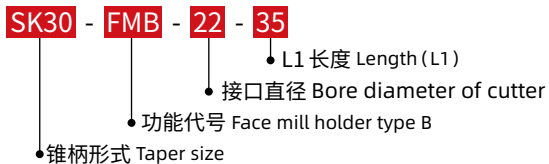

Features:

- ◎ Spindle conicity standard: DIN69871A or GB10944
- ◎ With water through design that reduces vibration and steady for cutting.
- ◎ Connecting part(d) designed for metric size.
- ◎ Tool holders with BT shank for face mill chuck, Face mill holders equipped with screws and drive keys to assemble the mill cutter to holder.
- ◎ Can be made upon requested dimensions.
- ◎ The pull stud must purchase alone.

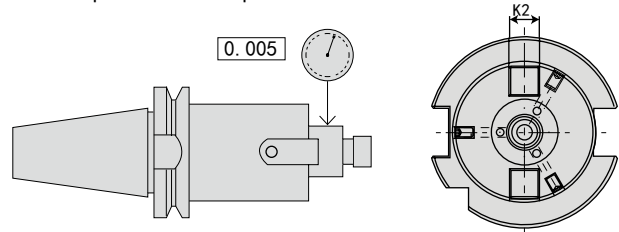

·SK50-FMB 平面铣刀柄

SK50-FMB FACE MILL ARBOR

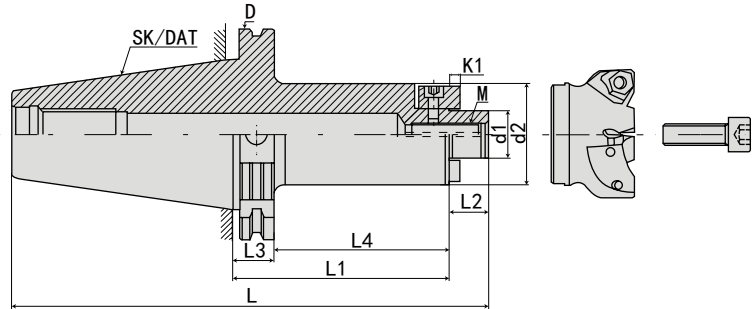

规格 Model	L	L1	L2	L3	L4	D	d1	d2	d3	k1	k2	螺孔 M
SK50-FMB22- 45	164.75	45	18	19.1	26	97.5	22	26	48	4.8	10	M10*1.5P
- 60	179.75	60	18	19.1	41	97.5	22	26	48	4.8	10	M10*1.5P
-100	219.75	100	18	19.1	81	97.5	22	26	48	4.8	10	M10*1.5P
-150	269.75	150	18	19.1	131	97.5	22	26	48	4.8	10	M10*1.5P
-200	319.75	200	18	19.1	181	97.5	22	26	48	4.8	10	M10*1.5P
-250	369.75	250	18	19.1	231	97.5	22	26	48	4.8	10	M10*1.5P
-FMB27- 45	166.75	45	20	19.1	26	97.5	27	33	58	5.8	12	M12*1.75P
- 60	181.75	60	20	19.1	41	97.5	27	33	58	5.8	12	M12*1.75P
-100	221.75	100	20	19.1	81	97.5	27	33	58	5.8	12	M12*1.75P
-150	271.75	150	20	19.1	131	97.5	27	33	58	5.8	12	M12*1.75P
-200	321.75	200	20	19.1	181	97.5	32	33	58	5.8	12	M12*1.75P
-FMB32- 45	168.75	45	22	19.1	26	97.5	32	40	70	6.8	14	M16*2.0P
- 60	183.75	60	22	19.1	41	97.5	32	40	70	6.8	14	M16*2.0P
-100	223.75	100	22	19.1	81	97.5	32	40	70	6.8	14	M16*2.0P
-150	273.75	150	22	19.1	231	97.5	32	40	70	6.8	14	M16*2.0P
-200	323.75	200	22	19.1	281	97.5	32	40	70	6.8	14	M16*2.0P

特点:

注:

- ◎ 本体锥柄规格: DIN69871-A 或 GB10944
- ◎ 中心通孔有利于出水及抗震性强
- ◎ 平面铣刀配合部位 (d) 轴系公轴 h6
- ◎ 适用于平面铣削加工
- ◎ 可定制非常规长度
- ◎ 拉钉须另行购买

Features:

- ◎ Spindle conicity standard: DIN69871A or GB10944
- ◎ With water through design that reduces vibration and steady for cutting.
- ◎ Connecting part(d) designed for metric size.
- ◎ Tool holders with BT shank for face mill chuck, Face mill holders equipped with screws and drive keys to assemble the mill cutter to holder.
- ◎ Can be made upon requested dimensions.
- ◎ The pull stud must purchase alone.

规格说明:

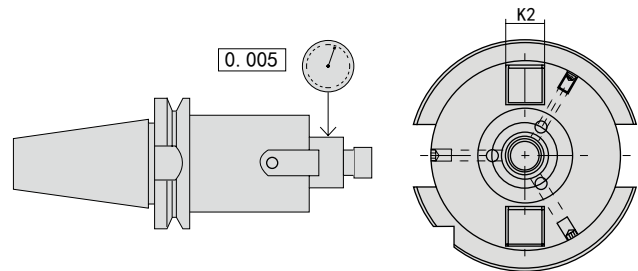
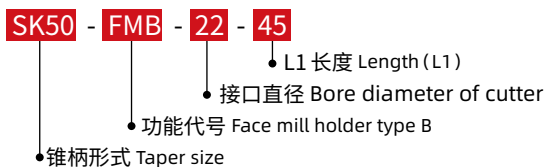

·SK50-FMB 平面铣刀柄

SK50-FMB FACE MILL ARBOR

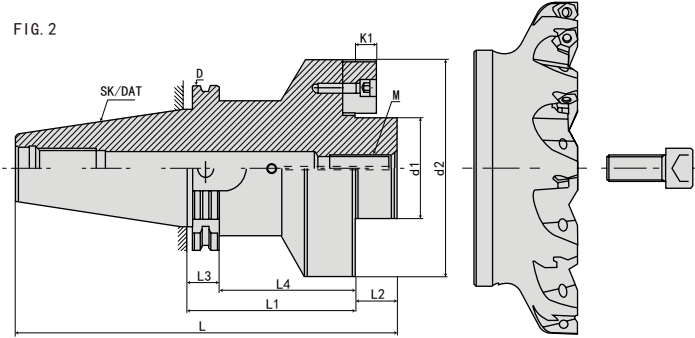
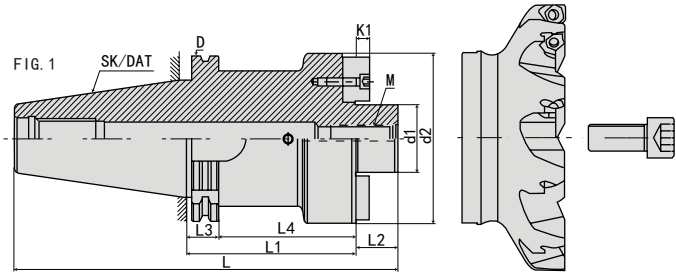

规格 Model	L	L1	L2	L3	L4	PCD	D	d1	d2	d3	四螺孔	k1	k2	螺孔 M	FIG
SK50-FMB40- 50	176.75	50	25	19.1	31	/	97.5	40	50	80	/	8.3	16	M16*2.0P	1
- 70	191.75	70	25	19.1	51	/	97.5	40	50	80	/	8.3	16	M16*2.0P	1
-100	226.75	100	25	19.1	81	/	97.5	40	50	80	/	8.3	16	M16*2.0P	1
-150	276.75	150	25	19.1	131	/	97.5	40	50	80	/	8.3	16	M16*2.0P	1
-200	326.75	200	25	19.1	181	/	97.5	40	50	80	/	8.3	16	M16*2.0P	1
- FMB50- 60	181.75	60	30	19.1	41	/	97.5	50	68	95	/	9.7	19	M24*3.0P	1
-100	221.75	100	30	19.1	81	/	97.5	50	68	95	/	9.7	19	M24*3.0P	1
SK40-FMB40F- 60(四螺孔)	153.4	60	25	19.1	41	66.7	97.5	40	/	99	M12*1.75P	8.3	16	M16*2.0P	1
SK50-FMB40F- 70(四螺孔)	196.75	70	25	19.1	51	66.7	97.5	40	/	99	M12*1.75P	8.3	16	M16*2.0P	1
-100(四螺孔)	226.75	100	25	19.1	81	66.7	97.5	40	/	99	M12*1.75P	8.3	16	M16*2.0P	1
-150(四螺孔)	276.8	150	25	19.1	131	66.7	97.5	40	/	99	M12*1.75P	8.3	16	M16*2.0P	1
-200(四螺孔)	326.8	200	25	19.1	181	66.7	97.5	40	/	99	M12*1.75P	8.3	16	M16*2.0P	1
- FMB60- 70(四螺孔)	196.75	70	25	19.1	51	101.6	97.5	60	/	128	M16*2.0P	12.5	25.4	M16*2.0P	2

特点:

注:

- ◎ 本体锥柄规格: DIN69871-A 或 GB10944
- ◎ 中心通孔有利于出水及抗震性强
- ◎ 平面铣刀配合部位 (d) 轴系公轴 h6
- ◎ 适用于平面铣削加工
- ◎ 可定制非常规长度
- ◎ 拉钉须另行购买

规格说明:

SK50 - FMB - 40 - 50

- L1 长度 Length (L1)
- 接口直径 Bore diameter of cutter
- 功能代号 Face mill holder type B
- 锥柄形式 Taper size

Features:

- ◎ Spindle conicity standard: DIN69871A or GB10944
- ◎ With water through design that reduces vibration and steady for cutting.
- ◎ Connecting part(d) designed for metric size.
- ◎ Tool holders with BT shank for face mill chuck, Face mill holders equipped with screws and drive keys to assemble the mill cutter to holder.
- ◎ Can be made upon requested dimensions.
- ◎ The pull stud must purchase alone.

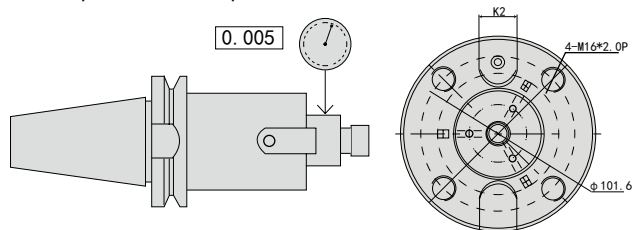

·SK40-LBK 镗头刀柄

SK40-LBK BORING HEAD SHANK

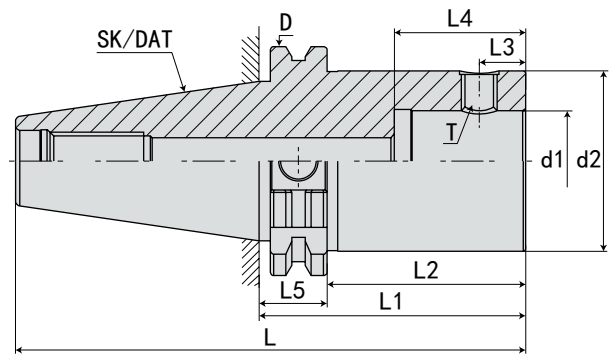

规格 Model	L	L1	L2	L3	L4	L5	D	d2	d1	侧边螺丝	重量 KGS
SK40-LBK1- 75	143.4	75	55.9	5.05	30	19.1	63.55	19	11	M4*0.5P	1
-105	168.4	105	85.9	5.05	30	19.1	63.55	19	11	M4*0.5P	1.2
-LBK2- 85	153.4	85	65.9	6.62	31	19.1	63.55	24	14	M5*0.5P	1.2
-115	178.4	115	95.9	6.62	31	19.1	63.55	24	14	M5*0.5P	1.3
-LBK3- 95	163.4	95	75.9	8	35	19.1	63.55	31	18	M6*0.75P	1.3
-125	188.4	125	105.9	8	35	19.1	63.55	31	18	M6*0.75P	1.2
-155	218.4	155	135.9	8	35	19.1	63.55	31	18	M6*0.75P	1.6
-LBK4- 85	153.4	85	65.9	10	39	19.1	63.55	39	22	M8*0.75P	1.7
-130	193.4	130	110.9	10	39	19.1	63.55	39	22	M8*0.75P	1.45
-175	243.4	175	155.9	10	39	19.1	63.55	39	22	M8*0.75P	1.5
-205	273.4	205	185.9	10	39	19.1	63.55	39	22	M8*0.75P	2.1
-300	368.4	300	280.9	10	39	19.1	63.55	39	22	M8*0.75P	2.2
-LBK5- 75	143.4	75	55.9	13	45	19.1	63.55	50	28	M10*1.0P	2.3
-125	188.4	125	105.9	13	45	19.1	63.55	50	28	M10*1.0P	1.7
-175	243.4	175	155.9	13	45	19.1	63.55	50	28	M10*1.0P	1.95
-205	273.4	205	185.9	13	45	19.1	63.55	50	28	M10*1.0P	3
-250	318.4	250	230.9	13	45	19.1	63.55	50	28	M10*1.0P	3.2
-LBK6- 65	133.4	65	45.9	16	55	19.1	63.55	63	36	M12*1.0P	3.5
-115	178.4	115	95.9	16	55	19.1	63.55	63	36	M12*1.0P	2.15
-165	233.4	165	145.9	16	55	19.1	63.55	63	36	M12*1.0P	3.5
-205	273.4	205	185.9	16	55	19.1	63.55	63	36	M12*1.0P	3.85
-250	318.4	250	230.9	16	55	19.1	63.55	63	36	M12*1.0P	4.1
-300	368.4	300	280.9	16	55	19.1	63.55	63	36	M12*1.0P	4.5

特点:

注:

- ◎内孔公差 H6
- ◎整支通孔，利于出水及抗震
- ◎可共用并互容于大多数“LBK”系列
- ◎侧边锁固螺丝与键槽呈 90 度，确保镗孔切削完毕时的相对位置
- ◎锁固时请使用螺丝防卡油防止因镗孔加工扭力过大，导致螺丝卡死难以拆卸组装
- ◎拉钉须另行购买

规格说明:

SK40 - LBK - 1 - 75

- L1 长度 Length (L1)
- 接口锥度 Taper No. of cutter
- 功能代号 Holder type
- 锥柄形式 Taper size

Features:

- ◎ Internal tolerance is H6.
- ◎ The entire through hole, favors the water leakage and quakeproof.
- ◎ May use in common and the mutual capacitance in majority "LBK" Series.
- ◎ The side locks the solid screw and the key slot assumes 90 degrees, guaranteed that time the boring cutting function draws back the knife phase.
- ◎ Because locks is solid when please do use the screw against card oil to prevent to process the torsion to be oversized boring , Causes the screw deactivation to disassemble the assembly with difficulty.
- ◎ The pull stud must purchase alone.

·SK50-LBK 镗头刀柄

SK50-LBK BORING HEAD SHANK

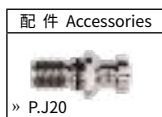
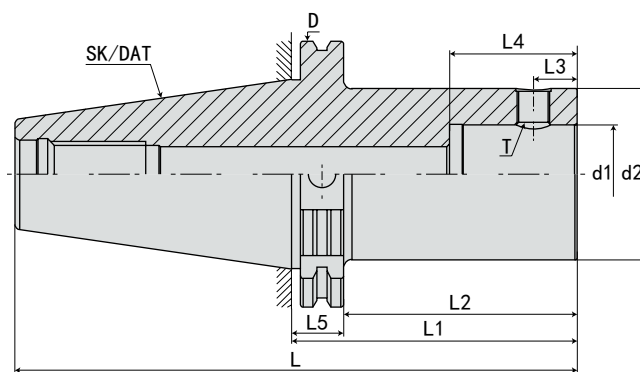

规格 Model	L	L1	L2	L3	L4	L5	D	d2	d1	侧边螺丝	重量 KGS
SK50-LBK1- 90	191.75	90	70.9	5.05	30	19.1	97.5	19	11	M4*0.5P	3.7
-115	216.75	115	95.9	5.05	30	19.1	97.5	19	11	M4*0.5P	3.9
-145	246.75	145	125.9	5.05	30	19.1	97.5	19	11	M4*0.5P	4.4
-LBK2- 90	191.75	90	70.9	6.62	31	19.1	97.5	24	14	M5*0.5P	4.5
-110	211.75	110	90.9	6.62	31	19.1	97.5	24	14	M5*0.5P	4
-140	241.75	140	120.9	6.62	31	19.1	97.5	24	14	M5*0.5P	5
-LBK3- 90	191.75	90	70.9	8	35	19.1	97.5	31	18	M6*0.75P	4.4
-125	226.75	125	105.9	8	35	19.1	97.5	31	18	M6*0.75P	4.4
-155	256.75	155	135.9	8	35	19.1	97.5	31	18	M6*0.75P	4.6
-185	286.75	185	165.9	8	35	19.1	97.5	31	18	M6*0.75P	4.75
-LBK4- 90	191.75	90	70.9	10	39	19.1	97.5	39	22	M8*0.75P	4.6
-115	216.75	115	95.9	10	39	19.1	97.5	39	22	M8*0.75P	4.8
-145	246.75	145	125.9	10	39	19.1	97.5	39	22	M8*0.75P	4.95
-175	276.75	175	155.9	10	39	19.1	97.5	39	22	M8*0.75P	5.1
-205	306.75	205	185.9	10	39	19.1	97.5	39	22	M8*0.75P	5.2
-250	351.75	250	230.9	10	39	19.1	97.5	39	22	M8*0.75P	5.5
-300	401.75	300	280.9	10	39	19.1	97.5	39	22	M8*0.75P	5.6

特点:

注:

- ◎内孔公差 H6
- ◎整支通孔, 利于出水及抗震
- ◎可共用并互容于大多数 "LBK" 系列
- ◎侧边锁固螺丝与键槽呈 90 度, 确保镗孔切削完毕时的相对位置
- ◎锁固时请使用螺丝防卡油防止因镗孔加工扭力过大, 导致螺丝卡死难以拆卸组装
- ◎拉钉须另行购买

规格说明:
SK50 - LBK - 1 - 90

- L1 长度 Length (L1)
- 接口锥度 Taper No. of cutter
- 功能代号 Holder type
- 锥柄形式 Taper size

Features:

- ◎ Internal tolerance is H6.
- ◎ The entire through hole, favors the water leakage and quakeproof.
- ◎ May use in common and the mutual capacitance in majority "LBK" Series.
- ◎ The side locks the solid screw and the key slot assumes 90 degrees, guaranteed that time the boring cutting function draws back the knife phase.
- ◎ Because locks is solid when please do use the screw against card oil to prevent to process the torsion to be oversized boring , Causes the screw deactivation to disassemble the assembly with difficulty.
- ◎ The pull stud must purchase alone.

·SK50-LBK 镗头刀柄

SK50-LBK BORING HEAD SHANK

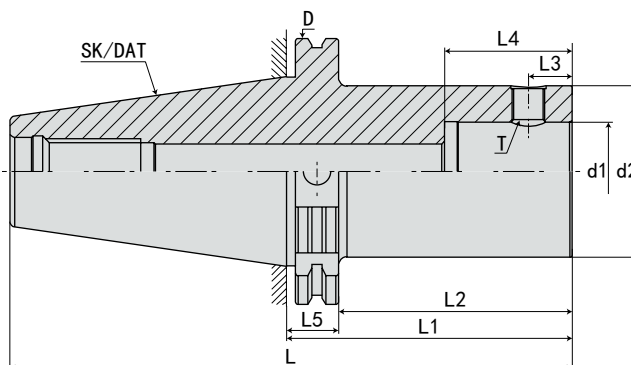
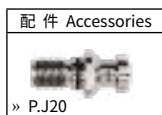

规格 Model	L	L1	L2	L3	L4	L5	D	d2	d1	侧边螺丝	重量 KGS
SK50-LBK5- 90	191.75	90	70.9	13	45	19.1	97.5	50	28	M10*1.0P	5.4
-105	206.75	105	85.9	13	45	19.1	97.5	50	28	M10*1.0P	5.5
-150	251.75	150	130.9	13	45	19.1	97.5	50	28	M10*1.0P	6
-180	281.75	180	160.9	13	45	19.1	97.5	50	28	M10*1.0P	6.2
-240	341.75	240	220.9	13	45	19.1	97.5	50	28	M10*1.0P	6.4
-270	371.75	270	250.9	13	45	19.1	97.5	50	28	M10*1.0P	6.7
-300	401.75	300	280.9	13	45	19.1	97.5	50	28	M10*1.0P	7
-350	451.75	350	330.9	13	45	19.1	97.5	50	28	M10*1.0P	7.3
-400	501.75	400	380.9	13	45	19.1	97.5	50	28	M10*1.0P	7.6
-LBK6- 90	191.75	90	70.9	16	55	19.1	97.5	63	36	M12*1.0P	5.9
-105	206.75	105	85.9	16	55	19.1	97.5	63	36	M12*1.0P	6.5
-150	251.75	150	130.9	16	55	19.1	97.5	63	36	M12*1.0P	6.7
-170	271.75	170	150.9	16	55	19.1	97.5	63	36	M12*1.0P	6.9
-180	281.75	180	160.9	16	55	19.1	97.5	63	36	M12*1.0P	7
-230	331.75	230	210.9	16	55	19.1	97.5	63	36	M12*1.0P	7.45
-270	371.75	270	250.9	16	55	19.1	97.5	63	36	M12*1.0P	8.2
-300	401.75	300	280.9	16	55	19.1	97.5	63	36	M12*1.0P	9.5
-350	451.75	350	330.9	16	55	19.1	97.5	63	36	M12*1.0P	10.8
-400	501.75	400	380.9	16	55	19.1	97.5	63	36	M12*1.0P	11.3
-450	551.75	450	430.9	16	55	19.1	97.5	63	36	M12*1.0P	11.8
-500	601.75	500	480.9	16	55	19.1	97.5	63	36	M12*1.0P	12.3

特点:

注:

- ◎内孔公差 H6
- ◎整支通孔，利于出水及抗震
- ◎可共用并互容于大多数“LBK”系列
- ◎侧边锁固螺丝与键槽呈 90 度，确保镗孔切削完毕时的相对位置
- ◎锁固时请使用螺丝防卡油防止因镗孔加工扭力过大，导致螺丝卡死难以拆卸组装
- ◎拉钉须另行购买

规格说明:

SK50 - LBK - 5 - 90

- L1 长度 Length (L1)
- 接口锥度 Taper No. of cutter
- 功能代号 Holder type
- 锥柄形式 Taper size

Features:

- ◎ Internal tolerance is H6.
- ◎ The entire through hole, favors the water leakage and quakeproof.
- ◎ May use in common and the mutual capacitance in majority "LBK" Series.
- ◎ The side locks the solid screw and the key slot assumes 90 degrees, guaranteed that time the boring cutting function draws back the knife phase.
- ◎ Because locks is solid when please do use the screw against card oil to prevent to process the torsion to be oversized boring , Causes the screw deactivation to disassemble the assembly with difficulty.
- ◎ The pull stud must purchase alone.

·SK-MTA 带扁尾莫氏刀柄

SK-MTA TAPER ADAPTER(MORSE)

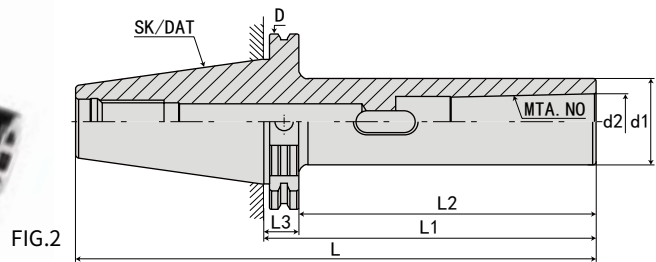
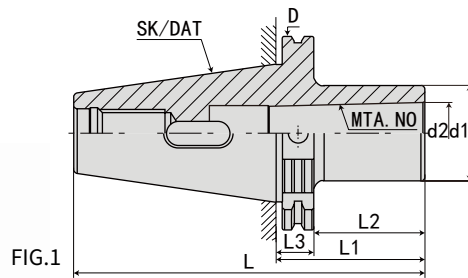
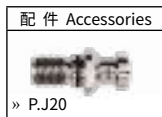

规格 Model	FIG	L	L1	L2	L3	d1	d2	D	夹持钻头范围	重量 KGS
SK30-MTA1- 50	1	97.8	50	31	19.1	25	12.065	50	φ2-φ14	0.55
-MTA2- 60	1	107.8	60	41	19.1	32	17.780	50	φ14-φ23	0.80
-MTA3- 75	1	122.8	70	51	19.1	40	23.825	50	φ23-φ32	1
SK40-MTA1- 50	1	118.4	50	31	19.1	25	12.065	63.55	φ2-φ14	1.2
-MTA2- 50	1	118.4	50	31	19.1	32	17.780	63.55	φ14-φ23	1
-MTA3- 70	1	138.4	70	51	19.1	40	23.825	63.55	φ23-φ32	1.10
-MTA4- 95	1	163.4	95	71	19.1	48	31.267	63.55	φ32-φ50	1.35
SK50-MTA1- 45	1	146.75	45	26	19.1	25	12.065	97.5	φ2-φ14	3
-120	2	221.75	120	101	19.1	25	12.065	97.5	φ2-φ14	4.6
-MTA2- 60	1	161.75	60	41	19.1	32	17.780	97.5	φ14-φ23	3.1
-135	2	236.75	135	116	19.1	32	17.780	97.5	φ14-φ23	4.8
-180	2	281.75	180	161	19.1	32	17.780	97.5	φ14-φ23	5
-MTA3- 65	1	166.75	65	46	19.1	40	23.825	97.5	φ23-φ32	3.2
-150	2	251.75	150	131	19.1	40	23.825	97.5	φ23-φ32	5
-180	2	281.75	180	161	19.1	40	23.825	97.5	φ23-φ32	5.2
-MTA4- 75	1	176.75	75	56	19.1	48	31.267	97.5	φ32-φ50	3.2
- 95	1	196.75	95	76	19.1	48	31.267	97.5	φ32-φ50	3.4
-180	2	281.75	180	161	19.1	48	31.267	97.5	φ32-φ50	5.5
-MTA5-105	1	206.75	105	86	19.1	65	44.399	97.5	φ50-φ75	3.6
-200	2	301.75	200	181	19.1	65	44.399	97.5	φ50-φ75	7.2
-MTA6-200	1	301.75	200	181	19.1	85	63.348	97.5	φ75-φ100	5.2
-280	2	381.75	280	261	19.1	85	63.348	97.5	φ75-φ100	10

特点:

注:

- ◎ 本体锥柄规格: DIN69871-A 或 GB10944
- ◎ 刀柄用于带扁尾莫氏锥柄刀具、钻头、铰刀等
- ◎ 钻头莫氏柄
- ◎ 拉钉须另行购买

Features:

- ◎ Spindle conicity standard: DIN69871A or GB10944
- ◎ Used in Morse conicity tools, drill chuck, reamer and so on.
- ◎ Dimensions
- ◎ The pull stud must purchase alone.

规格说明:

SK30 - MTA - 1 - 50

- L1 长度 Length (L1)
- 莫氏锥度号 Morse taper No.
- 有扁尾莫氏锥孔 Morse taper holder type A
- 锥柄形式 Taper size

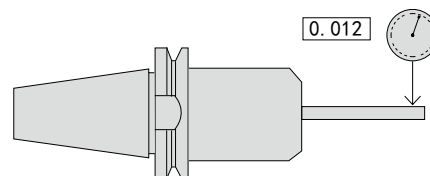

·SK-MTB 无扁尾莫氏刀柄

SK-MTB MORSE TAPER HOLDER

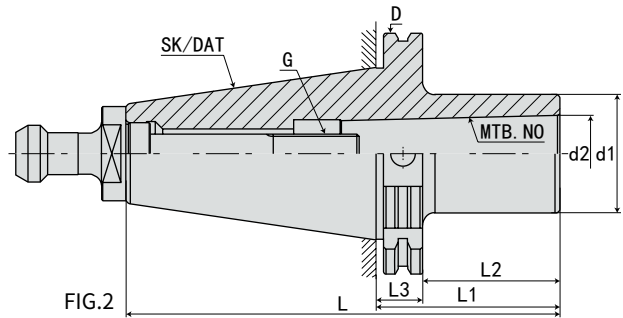
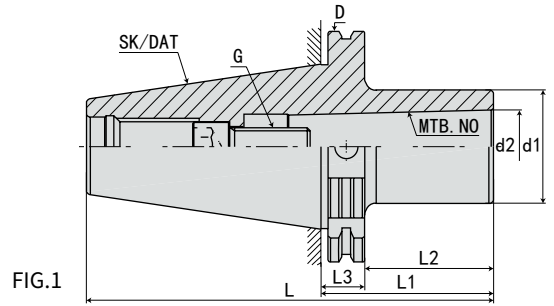
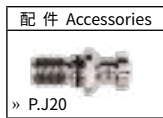

规格 Model	FIG	L	L1	L2	L3	d1	d2	D	夹持铣刀范围	重量 KGS
SK30-MTB1- 50	1	97.8	50	31	19.1	25	12.065	50	φ10-φ14	0.55
-MTB2- 60	1	107.8	60	41	19.1	32	17.780	50	φ16-φ22	0.80
-MTB3- 75	2	122.8	70	51	19.1	40	23.825	50	φ24-φ32	1
SK40-MTB1- 50	1	118.4	50	31	19.1	25	12.065	63.55	φ10-φ14	1.2
-MTB2- 50	1	118.4	50	31	19.1	32	17.780	63.55	φ16-φ22	1
-MTB3- 70	1	138.4	70	51	19.1	40	23.825	63.55	φ24-φ32	1.10
-MTB4- 95	2	163.4	95	71	19.1	48	31.267	63.55	φ32-φ50	1.35
SK50-MTB1- 45	1	146.75	45	26	19.1	25	12.065	97.5	φ10-φ14	3
-120	1	221.75	120	101	19.1	25	12.065	97.5	φ10-φ14	4.6
-MTB2- 60	1	161.75	60	41	19.1	32	17.780	97.5	φ16-φ22	3.1
-135	1	236.75	135	116	19.1	32	17.780	97.5	φ16-φ22	4.8
-180	1	281.75	180	161	19.1	32	17.780	97.5	φ16-φ22	5
-MTB3- 65	1	166.75	65	46	19.1	40	23.825	97.5	φ24-φ32	3.2
-150	1	251.75	150	131	19.1	40	23.825	97.5	φ24-φ32	5
-180	1	281.75	180	161	19.1	40	23.825	97.5	φ24-φ32	5.2
-MTB4- 75	1	176.75	75	56	19.1	48	31.267	97.5	φ32-φ50	3.2
- 95	1	196.75	95	76	19.1	48	31.267	97.5	φ32-φ50	3.4
-180	1	281.75	180	161	19.1	48	31.267	97.5	φ32-φ50	5.5
-MTB5-105	1	206.75	105	86	19.1	65	44.399	97.5	φ40-φ75	3.6
-200	1	301.75	200	181	19.1	65	44.399	97.5	φ40-φ75	7.2
-MTB6-175	1	276.75	175	156	19.1	85	63.348	97.5	φ75-φ100	5.2
-280	1	381.75	280	261	19.1	85	63.348	97.5	φ75-φ100	10

特点:

注:

- ◎ 本體錐柄規格: DIN69871-A 或 GB10944
- ◎ 刀柄用于莫氏錐柄銑刀
- ◎ 用于夾持莫氏錐度、尾端附內螺紋的切削刀具或是延長杆
- ◎ 拉釘須另行購買

规格说明:



Features:

- ◎ Spindle conicity standard: DIN69871A or GB10944
- ◎ Dimensions
- ◎ Uses in supporting on both sides not-like the taper, end to attach the box thread the cutting tool perhaps lengthens the pole.
- ◎ The pull stud must purchase alone.

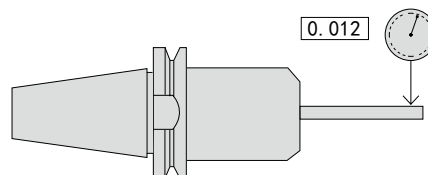

·SK-APU 一体式钻夹头刀柄

SK-APU DRILL CHUCK HOLDER

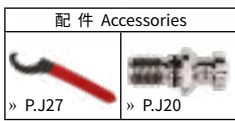
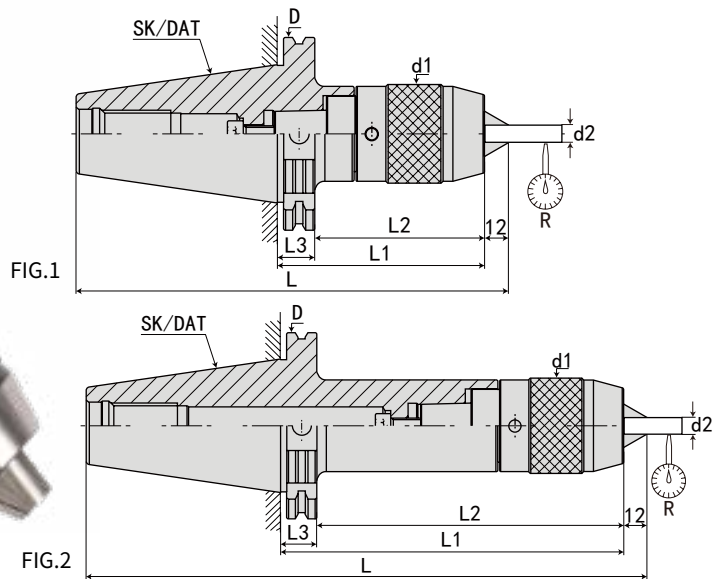

规格 Model	L1	L	L2	L3	d1	d2	D	R	FIG	重量 KGS
SK40-APU08-85	85	162.4	58	16	37	6	63.55	0.08	1	1.46
-APU13-110	110	187.4	83	16	50	13	63.55	0.08	1	2
-150	110	187.4	93	16	57	16	63.55	0.08	2	2.35
-APU16-110	150	227.4	83	16	50	13	63.55	0.08	1	2.3
-150	150	227.4	93	16	57	16	63.55	0.08	1	2.5
SK50-APU08-90	90	203.8	52	16	37	6	97.5	0.08	1	4.16
-APU13-105	105	218.8	67	16	50	13	97.5	0.08	1	4.7
-120	120	233.8	92	16	50	13	97.5	0.08	1	5.5
-180	180	293.8	142	16	50	13	97.5	0.08	2	5.85
-APU16-105	105	218.8	67	16	57	16	97.5	0.08	1	5.03
-120	120	233.8	92	16	57	16	97.5	0.08	1	5.35
-180	180	293.8	142	16	57	16	97.5	0.08	2	5.85

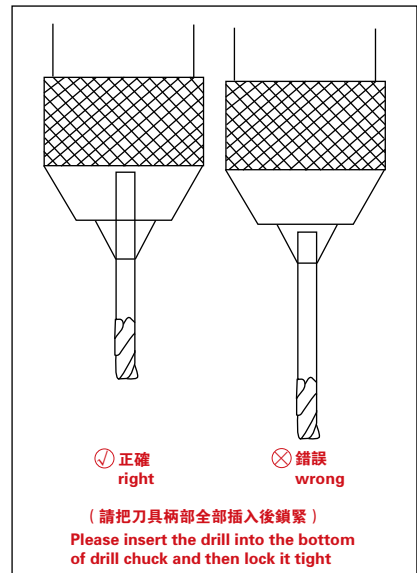

特点:

注:

- ◎ 一体式结构，减少了连接误差精度，内部用螺纹结构，就不会出现夹头脱落现象
- ◎ 用于钻头、铰刀等夹持，不可用于丝锥和铣刀夹持
- ◎ 一体刀柄缩短刀具长度，提高加工精度，增加使用寿命
- ◎ 有自锁功能，附带专用扳手，请勿用其它工具
- ◎ APU 偏摆精度为 0.06，如需更高精度要求请使用 ER 或 SK 系列
- ◎ 扳手、拉钉须另行购买

Features:

- ◎ The shank and keyless drill chuck are combined together so as to avoid the drill chuck slipping out for heavy-duty and high speed cutting and improve the precision.
- ◎ Not be used for gripping draw bolt and milling tools, instead of drill bit and reamer.
- ◎ APU drill chuck shorten the length while length the working life of tool.
- ◎ Each APU drill chuck attached 1pc APU wrench.
- ◎ The APU leaning precision is 0.06mm, like the need high accuracy request, please use ER or the SK serie.
- ◎ The spanner、pull stud must purchase alone.

规格说明:

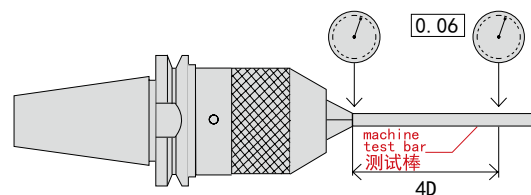

·SK-SLN 侧固式刀柄

SK-SLN SIDE LOCK END MILL HOLDER

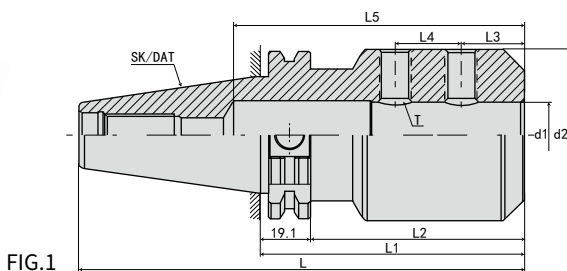

FIG.1

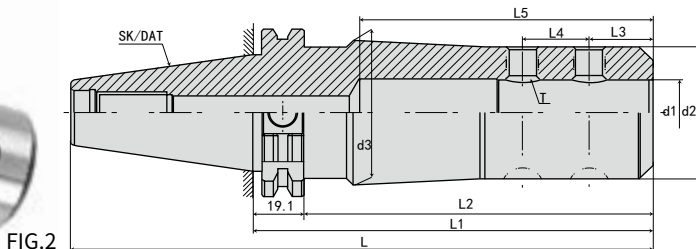
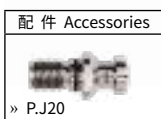

FIG.2



规格 Model	FIG	L	L1	L2	L3	L4	L5	d1	d2	d3	T
SK30- SLN6- 50	FIG1	97.8	50	31	18	-	50	6	25	25	M5*0.8P
- SLN8- 50	FIG1	97.8	50	31	18	-	50	8	28	28	M6*1.0P
-SLN10- 50	FIG1	97.8	50	31	20	-	55	10	35	35	M8*1.25
-SLN12- 50	FIG1	97.8	50	31	22.5	-	60	12	42	42	M10*1.5P
-SLN16- 63	FIG1	110.8	63	44	24	-	60	16	45	45	M12*1.75P
SK40- SLN6- 50	FIG1	118.4	50	31	18	-	50	6	25	25	M5*0.8P
- SLN8- 50	FIG1	118.4	50	31	18	-	50	8	28	28	M6*1.0P
-SLN10- 50	FIG1	118.4	50	31	20	-	55	10	35	35	M8*1.25
-SLN12- 50	FIG1	118.4	50	31	22.5	-	60	12	42	42	M10*1.5P
-SLN16- 63	FIG1	131.4	63	44	24	-	100	16	45	45	M12*1.75P
-100	FIG1	168.4	100	81	22	18	100	16	45	45	M12*1.75P
-150	FIG2	218.4	150	131	22	18	100	16	38	48	M10*1.5P
-SLN20- 63	FIG1	131.4	63	44	25	-	100	20	50	50	M12*1.76P
-100	FIG1	168.4	100	81	25	20	100	20	50	50	M12*1.77P
-150	FIG2	218.4	150	131	25	20	100	20	45	50	M12*1.77P
-SLN25-100	FIG1	168.4	100	81	24	25	110	25	65	65	M12*1.77P
-150	FIG2	218.4	150	131	24	25	110	25	50	55	M12*1.77P
-SLN32-100	FIG1	168.4	100	81	24	28	120	32	70	70	M16*2.0P
-150	FIG2	218.4	150	131	24	28	120	32	58	63	M16*2.0P

特点:

注:

- ◎ 本体锥柄规格: DIN69871-A 或 GB10944
- ◎ 孔径公差 H5
- ◎ 刚性夹持, 用于重切削
- ◎ 侧固式刀柄被用作刀具的工具刀柄
- ◎ 装入刀具时, 刀具的槽口平面部分与刀柄的侧固螺钉对齐, 强力锁定
- ◎ 拉钉须另行购买

Features:

- ◎ Spindle conicity standard:JDIN69871A or GB10944
- ◎ Aperture tolerance:H5.
- ◎ Used for remachining with rigidly grip.
- ◎ Face mill chuck used to be the holder of cutting tools.
- ◎ When attaching, cutting tools,with strong side aligned lock between the plane of the part and notch solid screws.
- ◎ The pull stud must purchase alone.

规格说明:

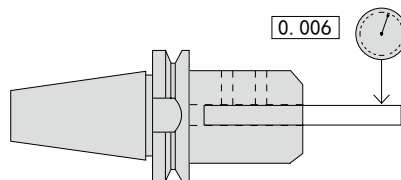

·SK50-SLN 侧固式刀柄

SK50-SLN SIDE LOCK END MILL HOLDER

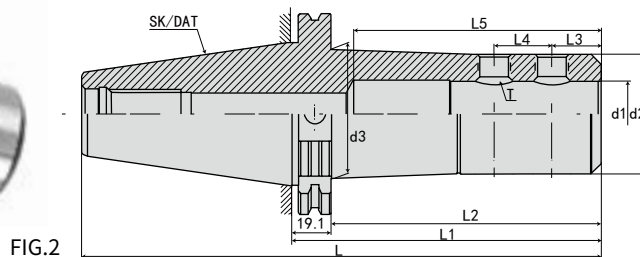
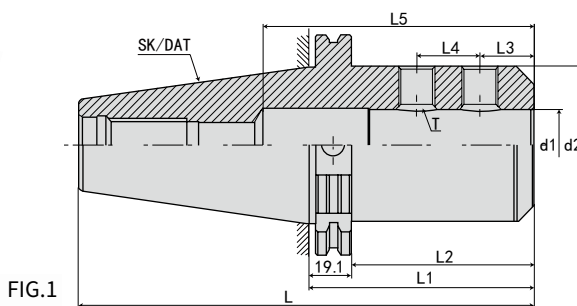
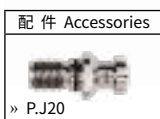

规格 Model	FIG	L	L1	L2	L3	L4	L5	d1	d2	d3	T
SK50- SLN6- 63	FIG1	164.75	63	44	18	-	50	6	25	25	M5*0.8P
-100	FIG1	201.75	100	81	18	18	50	6	25	25	M5*0.8P
- SLN8- 63	FIG1	164.75	63	44	18	-	50	8	28	28	M6*1.0P
-100	FIG1	201.75	100	81	18	18	50	8	28	28	M6*1.0P
-SLN10- 63	FIG1	164.75	63	44	20	18	55	10	35	35	M8*1.25
-100	FIG1	201.75	100	81	20	18	55	10	35	35	M8*1.25
-SLN12- 63	FIG1	164.75	63	44	22.5	18	60	12	42	42	M10*1.5P
-100	FIG1	201.75	100	81	22.5	18	60	12	42	42	M10*1.5P
-SLN16- 63	FIG1	164.75	63	44	24	-	100	16	45	45	M12*1.75P
-100	FIG1	201.75	100	81	22	18	100	16	45	45	M12*1.75P
-150	FIG2	251.75	150	131	22	18	100	16	38	45	M10*1.5P
-SLN20- 63	FIG1	164.75	63	44	25	-	100	20	50	50	M12*1.75P
-100	FIG1	201.75	100	81	25	20	100	20	50	50	M12*1.75P
-150	FIG2	251.75	150	131	25	20	100	20	45	50	M12*1.75P

特点:

注:

- ◎ 本体锥柄规格: DIN69871-A 或 GB10944
- ◎ 孔径公差 H5
- ◎ 刚性夹持, 用于重切削
- ◎ 侧固式刀柄被用作刀具的工具刀柄
- ◎ 装入刀具时, 刀具的槽口平面部分与刀柄的侧固螺钉对齐, 强力锁定
- ◎ 拉钉须另行购买

Features:

- ◎ Spindle conicity standard:JDIN69871A or GB10944
- ◎ Aperture tolerance:H5.
- ◎ Used for remachining with rigidly grip.
- ◎ Face mill chuck used to be the holder of cutting tools.
- ◎ When attaching, cutting tools,with strong side aligned lock between the plane of the part and notch solid screws.
- ◎ The pull stud must purchase alone.

规格说明:

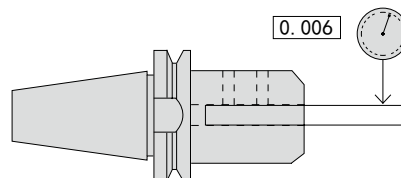

F
SK SHANK SYSTEMS
SK 刀柄系列

·SK50-SLN 侧固式刀柄

SK50-SLN SIDE LOCK END MILL HOLDER

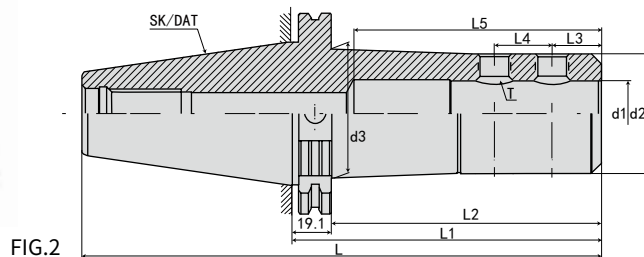
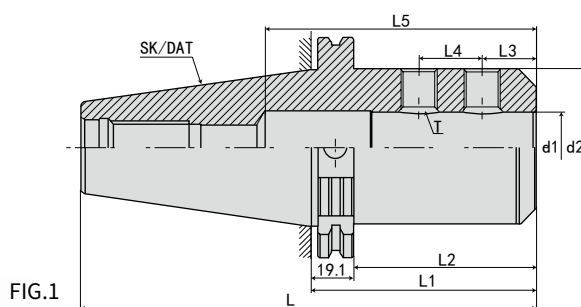
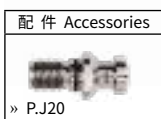

规格 Model	FIG	L	L1	L2	L3	L4	L5	d1	d2	d3	T
SK50- SLN25- 80	FIG1	181.75	80	61	24	-	110	25	65	65	M12*1.75P
-100	FIG1	201.75	100	81	24	25	110	25	65	65	M12*1.75P
-150	FIG2	251.75	150	131	24	25	110	25	50	55	M12*1.75P
- SLN32-100	FIG1	201.75	100	81	24	28	120	32	70	70	M16*2.0P
-150	FIG2	251.75	150	131	24	28	120	32	58	63	M16*2.0P
-200	FIG2	301.75	200	181	24	28	120	32	58	63	M16*2.0P
- SLN40-115	FIG1	216.75	115	96	30	32	120	40	80	80	M20*2.0P
-150	FIG2	251.75	150	131	30	32	120	40	70	75	M16*2.0P
-200	FIG2	301.75	200	181	30	32	120	40	70	75	M16*2.0P
- SLN42-100	FIG1	201.75	100	81	30	32	120	42	80	80	M20*2.0P
-150	FIG2	251.75	150	131	30	32	120	42	75	80	M16*2.0P
-200	FIG2	301.75	200	181	30	32	120	42	75	80	M16*2.0P
- SLN50-120	FIG1	221.75	120	101	35	35	120	50	90	90	M20*2.0P
-150	FIG1	251.75	150	131	35	35	120	50	85	90	M20*2.0P
-SLN50.8-120	FIG1	221.75	120	101	35	35	120	50.8	90	90	M20*2.0P
-150	FIG1	251.75	150	131	35	35	120	50.8	85	90	M20*2.0P

特点:

注:

- ◎ 本体锥柄规格: DIN69871-A 或 GB10944
- ◎ 孔径公差 H5
- ◎ 刚性夹持, 用于重切削
- ◎ 侧固式刀柄被用作刀具的工具刀柄
- ◎ 装入刀具时, 刀具的槽口平面部分与刀柄的侧固螺钉对齐, 强力锁定
- ◎ 拉钉须另行购买

Features:

- ◎ Spindle conicity standard: JDIN69871A or GB10944
- ◎ Aperture tolerance: H5.
- ◎ Used for remachining with rigidly grip.
- ◎ Face mill chuck used to be the holder of cutting tools.
- ◎ When attaching, cutting tools, with strong side aligned lock between the plane of the part and notch solid screws.
- ◎ The pull stud must purchase alone.

规格说明:

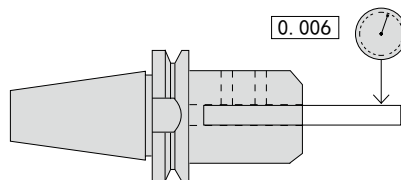
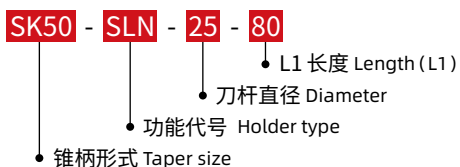

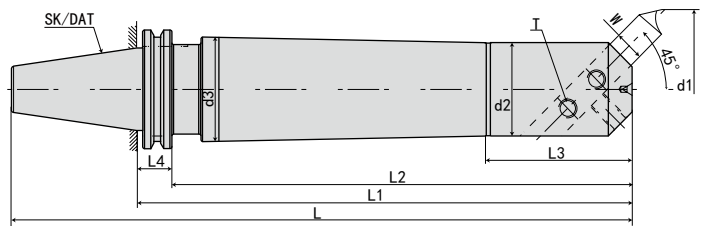
· SK-BSA 45° 粗镗刀杆 (盲孔) SK-BSA 45° DEGREE SLANT-INSERTED TYPE ROUGH BORING HOLDERS

规格 / 型号 Model	d1		d2	d3	D	L	L1	L2	L3	L4	W	T	重量 KGS
	最小加工孔	最大加工孔											
SK40-BSA25 -120	25	38	20	22	63.55	188.4	120	100.9	35	19.1	8	M6*1.0P	1.2
-BSA30 -150	30	42	24	26	63.55	218.4	150	130.9	40	19.1	8	M6*1.0P	1.4
-BSA38 -165	38	52	30	33	63.55	233.4	165	145.9	50	19.1	10	M8*1.25P	1.7
-BSA42 -165	42	56	34	37	63.55	233.4	165	145.9	60	19.1	10	M8*1.25P	2
-BSA50 -165	50	65	40	44	63.55	233.4	165	145.9	65	19.1	13	M10*1.5P	2.3
-220	50	65	40	44	63.55	288.4	220	200.9	65	19.1	13	M10*1.5P	2.8
-BSA62 -180	62	90	50	56	63.55	248.4	180	160.9	80	19.1	16	M10*1.5P	2.4
-220	62	90	50	56	63.55	288.4	220	200.9	80	19.1	16	M10*1.5P	2.9
-BSA72 -180	72	110	60	/	63.55	248.4	180	160.9	95	19.1	19	M10*1.5P	3.9
-220	72	110	60	66	63.55	288.4	220	200.9	95	19.1	19	M10*1.5P	4.4
-BSA90 -180	90	125	75	/	63.55	248.4	180	160.9	110	19.1	19	M12*1.75P	5.2
-220	90	125	75	80	63.55	288.4	220	200.9	110	19.1	19	M12*1.75P	5.7
SK50-BSA25 -135	25	38	20	22	97.5	236.75	135	115.9	35	19.1	8	M6*1.0P	4.2
-185	25	38	20	22	97.5	286.75	185	165.9	35	19.1	8	M6*1.0P	4.4
-BSA30 -165	30	42	24	26	97.5	266.75	165	145.9	40	19.1	8	M6*1.0P	4.4
-BSA38 -180	38	52	30	33	97.5	281.75	180	160.9	50	19.1	10	M8*1.25P	4.8
-240	38	52	30	33	97.5	341.75	240	220.9	50	19.1	10	M8*1.25P	5
-BSA42 -210	42	56	34	37	97.5	311.75	210	190.9	60	19.1	10	M8*1.25P	5
-BSA50 -180	50	65	40	44	97.5	281.75	180	160.9	65	19.1	13	M10*1.5P	5.4
-240	50	65	40	44	97.5	341.75	240	220.9	65	19.1	13	M10*1.5P	5.7
-300	50	65	40	44	97.5	401.75	300	280.9	65	19.1	13	M10*1.5P	6
-BSA62 -195	62	90	50	56	97.5	296.75	195	175.9	80	19.1	16	M10*1.5P	6.2
-270	62	90	50	56	97.5	371.75	270	250.9	80	19.1	16	M10*1.5P	7.6
-350	62	90	50	56	97.5	451.75	350	330.9	80	19.1	16	M10*1.5P	9
-400	62	90	50	56	97.5	501.75	400	380.9	80	19.1	16	M10*1.5P	10.4
-BSA72 -195	72	110	60	66	97.5	296.75	195	175.9	95	19.1	19	M10*1.5P	7
-285	72	110	60	66	97.5	386.75	285	265.9	95	19.1	19	M10*1.5P	9.2
-350	72	110	60	66	97.5	451.75	350	330.9	95	19.1	19	M10*1.5P	10.8
-400	72	110	60	66	97.5	501.75	400	380.9	95	19.1	19	M10*1.5P	12.4
-BSA90 -210	90	125	75	80	97.5	311.75	210	190.9	110	19.1	19	M12*1.75P	9.3
-300	90	125	75	80	97.5	401.75	300	280.9	110	19.1	19	M12*1.75P	12.3
-350	90	125	75	80	97.5	451.75	350	330.9	110	19.1	19	M12*1.75P	15.3
-BSA105-195	105	160	90	/	97.5	296.75	195	175.9	130	19.1	25	M12*1.75P	10.7
-285	105	160	90	94	97.5	386.75	285	265.9	130	19.1	25	M12*1.75P	15
-300	105	160	90	94	97.5	401.75	300	280.9	130	19.1	25	M12*1.75P	13.2
-BSA130-255	130	190	110	/	97.5	356.75	255	235.9	130	19.1	25	M12*1.75P	14.5
-300	130	190	110	115	97.5	401.75	300	280.9	130	19.1	25	M12*1.75P	18.5

规格说明:

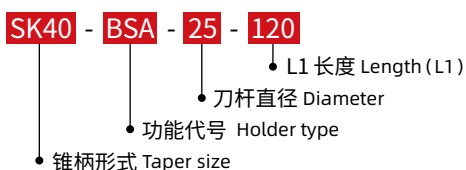
F
 SK SHANK SYSTEMS
 SK 刀柄系列

·SK-BSB 90°粗镗刀杆 (通孔)

SK-BSB 90° DEGREE SLANT-INSERTED TYPE ROUGH BORING HOLDERS

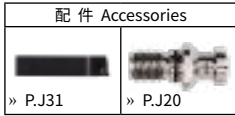
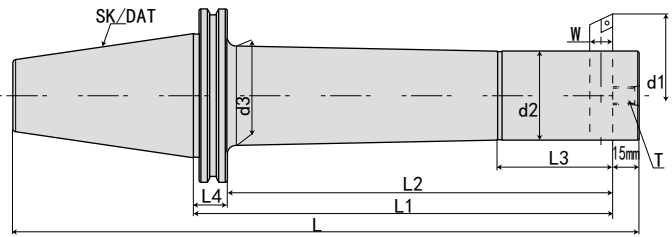

规格 / 型号 Model	d1		d2	d3	D	L	L1	L2	L3	L4	W	T	重量 KGS
	最小加工孔	最大加工孔											
SK40-BSB25 -120	25	52	20	22	63.55	203.4	120	100.9	35	19.1	8	M6*1.0P	1.2
-BSB30 -150	30	57	24	26	63.55	233.4	150	130.9	40	19.1	8	M6*1.0P	1.4
-BSB38 -165	38	70	30	33	63.55	248.4	165	145.9	50	19.1	10	M8*1.25P	1.7
-BSB42 -165	42	74	34	37	63.55	248.4	165	145.9	60	19.1	10	M8*1.25P	2
-BSB50 -165	50	90	40	44	63.55	248.4	165	145.9	65	19.1	13	M10*1.5P	2.3
-220	50	90	40	44	63.55	303.4	220	200.9	65	19.1	13	M10*1.5P	2.8
-BSB62 -180	62	115	50	56	63.55	263.4	180	160.9	80	19.1	16	M10*1.5P	2.4
-220	62	115	50	56	63.55	303.4	220	200.9	80	19.1	16	M10*1.5P	2.9
-BSB72 -180	72	135	60	/	63.55	263.4	180	160.9	95	19.1	19	M10*1.5P	3.9
-220	72	135	60	66	63.55	303.4	220	200.9	95	19.1	19	M10*1.5P	4.4
-BSB90 -180	90	150	75	/	63.55	263.4	180	160.9	110	19.1	19	M12*1.75P	5.2
-220	90	150	75	80	63.55	303.4	220	200.9	110	19.1	19	M12*1.75P	5.7
SK50-BSB25 -135	25	52	20	22	97.5	251.75	135	115.9	35	19.1	8	M6*1.0P	4.2
-185	25	52	20	22	97.5	301.75	185	165.9	35	19.1	8	M6*1.0P	4.4
-BSB30 -165	30	57	24	26	97.5	281.75	165	145.9	40	19.1	8	M6*1.0P	4.4
-BSB38 -180	38	70	30	33	97.5	296.75	180	160.9	50	19.1	10	M8*1.25P	4.8
-240	38	70	30	33	97.5	356.75	240	220.9	50	19.1	10	M8*1.25P	5
-BSB42 -210	42	74	34	37	97.5	326.75	210	190.9	60	19.1	10	M8*1.25P	5
-BSB50 -180	50	90	40	44	97.5	296.75	180	160.9	65	19.1	13	M10*1.5P	5.4
-240	50	90	40	44	97.5	356.75	240	220.9	65	19.1	13	M10*1.5P	5.7
-300	50	90	40	44	97.5	416.75	300	280.9	65	19.1	13	M10*1.5P	6
-BSB62 -195	62	115	50	56	97.5	311.75	195	175.9	80	19.1	16	M10*1.5P	6.2
-270	62	115	50	56	97.5	386.75	270	250.9	80	19.1	16	M10*1.5P	7.6
-350	62	115	50	56	97.5	466.75	350	330.9	80	19.1	16	M10*1.5P	9
-400	62	115	50	56	97.5	516.75	400	380.9	80	19.1	16	M10*1.5P	10.4
-BSB72 -195	72	135	60	66	97.5	311.75	195	175.9	95	19.1	19	M10*1.5P	7
-285	72	135	60	66	97.5	401.75	285	265.9	95	19.1	19	M10*1.5P	9.2
-350	72	135	60	66	97.5	466.75	350	330.9	95	19.1	19	M10*1.5P	10.8
-400	72	135	60	66	97.5	516.75	400	380.9	95	19.1	19	M10*1.5P	12.4
-BSB90 -210	90	150	75	80	97.5	326.75	210	190.9	110	19.1	19	M12*1.75P	9.3
-300	90	150	75	80	97.5	416.75	300	280.9	110	19.1	19	M12*1.75P	12.3
-350	90	150	75	80	97.5	466.75	350	330.9	110	19.1	19	M12*1.75P	15.3
-BSB105-195	105	190	90	/	97.5	311.75	195	175.9	130	19.1	25	M12*1.75P	10.7
-285	105	190	90	94	97.5	401.75	285	265.9	130	19.1	25	M12*1.75P	15
-300	105	190	90	94	97.5	416.75	300	280.9	130	19.1	25	M12*1.75P	13.2
-BSB130-255	130	260	110	/	97.5	371.75	255	235.9	130	19.1	25	M12*1.75P	14.5
-300	130	260	110	115	97.5	416.75	300	280.9	130	19.1	25	M12*1.75P	18.5

规格说明:

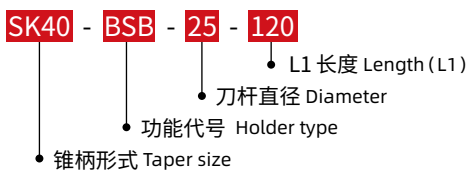

·SK-TC 伸缩扭力攻丝刀柄

SK-TC TAPPING CHUCK WITH LENGTH COMPENSATION

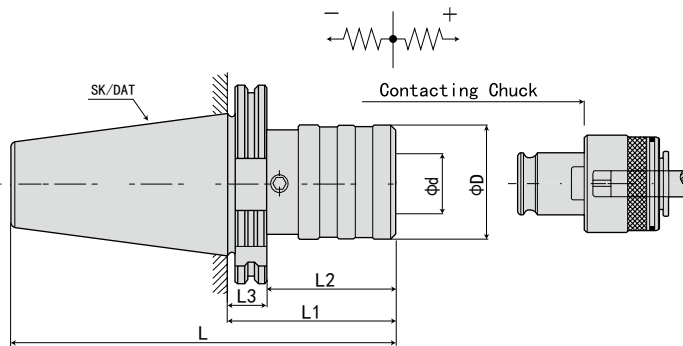

配件 Accessories
» P.J20

规格 Model	攻牙范围 Gripl range	L	L1	L2	L3	D	d	夹头名称 Collet name	重量 KGS
SK40-TC12- 60	M3-M12	107.8	60	40.9	19.1	36	19	TC312	
-TC20-100	M8-M20	147.8	100	80.9	19.1	53	31	TC820	
-TC33-138	M14-M33	185.8	138	118.9	19.1	78	48	TC1433	
SK50-TC12- 62	M3-M12	109.8	62	42.9	19.1	36	19	TC312	
-TC20- 83	M8-M20	130.8	83	63.9	19.1	53	31	TC820	
-TC33-133	M14-M33	180.8	133	113.9	19.1	78	48	TC1433	

规格说明:

SK40 - TC - 12 - 60

- L1 长度 Length (L1)
- 攻丝范围 Tapping range
- 功能代号 Holder type
- 锥柄形式 Taper size

·SK-MOD 模块刀柄

SK-MOD MODULAR TOOL HOLDER

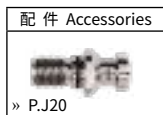
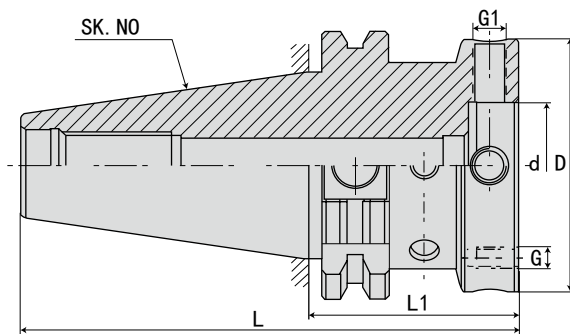

规格 Model	L	L1	D	d	G1	G	形式 Form	重量 KGS
SK30-MOD060-050	97.8	50	60	30	M8*1.0P	M5*0.8P	AD	0.8
-MOD070-050	97.8	50	70	35	M8*1.0P	M6*1.0P	AD	0.9
SK40-MOD060-050	118.4	50	60	30	M8*1.0P	M5*0.8P	AD + B	1.3
-MOD070-050	118.4	50	70	35	M8*1.0P	M6*1.0P	AD + B	1.4
-MOD080-055	123.4	55	80	40	M8*1.0P	M6*1.0P	AD + B	1.7
-MOD100-060	128.4	60	100	50	M10*1.0P	M8*1.25P	AD + B	2.1
SK45-MOD060-050	132.7	50	60	30	M8*1.0P	M5*0.8P	AD + B	2.8
-MOD070-050	132.7	50	70	35	M8*1.0P	M6*1.0P	AD + B	2.9
-MOD080-055	137.7	55	80	40	M8*1.0P	M6*1.0P	AD + B	3.1
-MOD100-060	142.7	60	100	50	M10*1.0P	M8*1.25P	AD + B	3.3
-MOD117-060	142.7	60	117	60	M10*1.0P	M8*1.25P	AD + B	3.5
SK50-MOD060-050	151.75	50	60	30	M8*1.0P	M5*0.8P	AD + B	3.2
-MOD070-050	151.75	50	70	35	M8*1.0P	M6*1.0P	AD + B	3.4
-MOD080-050	151.75	50	80	40	M8*1.0P	M6*1.0P	AD + B	3.6
-MOD100-060	156.75	60	100	50	M10*1.0P	M8*1.25P	AD + B	4.4
-MOD117-060	156.75	60	117	60	M10*1.0P	M8*1.25P	AD + B	4.5
-MOD140-060	156.75	60	140	80	M10*1.0P	M8*1.25P	AD + B	4.7

规格说明:

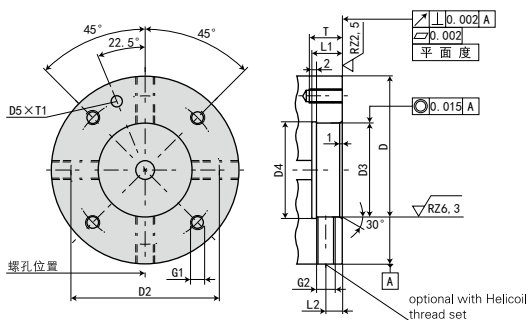
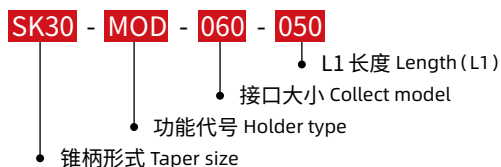

Nominal size module diameter D	32	40	50	63	80	100	125	160
D2+/-0.1	44	53	63	79	96	119	150	185
D3F8	30	35	40	50	60	80	100	120
D4	31	36	41	51	61	81	101	121
D5	4.5	5.0	5.0	5.0	6.0	6.0	6.0	6.0
L1	12	12	12	14	14	14	24	37
L2	7	7	7	8	8	8	8	8
G1	M5	M6	M6	M8	M8	M10	M12	M12
G2	M8*1	M8*1	M8*1	M10*1	M10*1	M10*1	M10*1	M10*1
T	11	14	14	15	15	18	25	25
T1+0.5	3	3.5	3.5	3.5	4.5	4.5	4.5	4.5

·MOD 法兰盘 MOD FLANGE PLATE

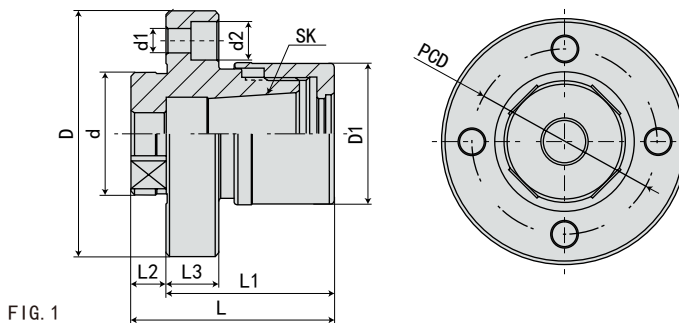

FIG. 1

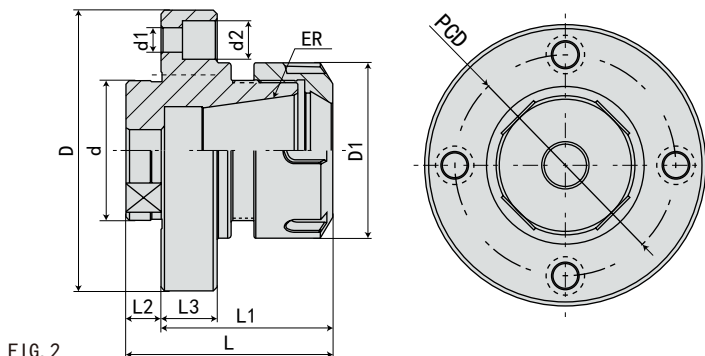

FIG. 2

规格 Model	D	D1	d	d1	d2	L	L1	L2	L3	PCD	FIG
MOD060-GSK16-48	60	40	30	6	9	58	48	10	15	44	1
MOD070-GSK16-48	70	40	35	7	11	58	48	10	15	53	1
MOD080-GSK16-49	80	40	40	7	11	59	49	10	16	63	1
MOD080-ER32-49	80	50	40	7	11	59	49	10	16	63	2
MOD100-ER40-63	100	63	50	9	14	75	63	12	18	79	2

规格说明:

MOD - GSK - 16 - 48

- L1 长度 Length (L1)
- 筒夹型号 Collect model
- 筒夹种类 Collect type GSK
- 锥柄形式 Taper size

·SK-MOD 可调精度刀柄 (铰刀专用)

SK-MOD ADJUSTABLE CHUCK (REAMER USING)

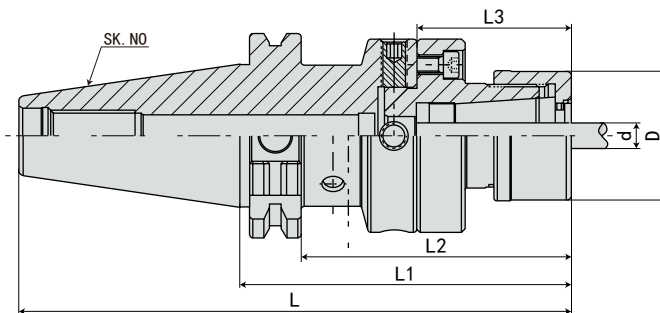
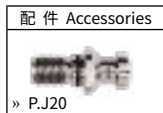

规格 Model	L	L1	L2	L3	D	d 夹持范围 Range	弹性筒夹 Collets
SK30-MOD060-GSK16- 98	145.8	98	79	48	40	3-16mm	GSK16
SK40-MOD060-GSK16- 98	166.4	98	79	48	40	3-16mm	GSK16
-MOD070-GSK16- 98	166.4	98	79	48	40	3-16mm	GSK16
-MOD080- ER32-104	172.4	104	85	49	50	2-20mm	ER32
-MOD080-GSK16-104	172.4	104	85	49	40	3-16mm	GSK16
-MOD100- ER40-123	191.4	123	104	63	63	2-26mm	ER40
SK50-MOD060-GSK16- 98	199.75	98	79	48	40	3-16mm	GSK16
-MOD070-GSK16- 98	199.75	98	79	48	40	3-16mm	GSK16
-MOD080- ER32- 99	200.75	99	80	49	50	2-20mm	ER32
-MOD080-GSK16- 99	200.75	99	80	49	40	3-16mm	GSK16
-MOD100- ER40-123	224.75	123	104	63	63	2-26mm	ER40

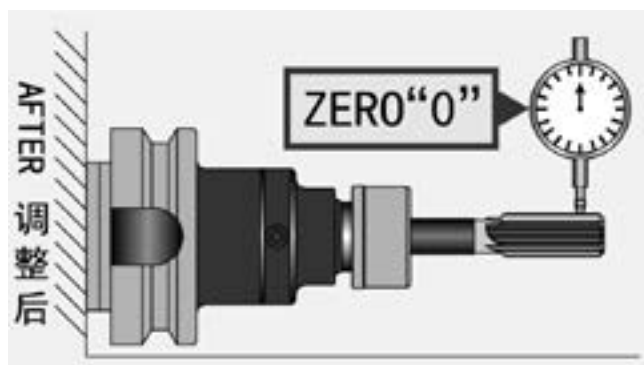
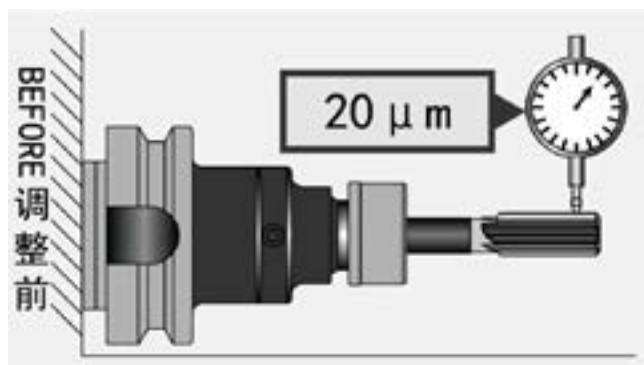
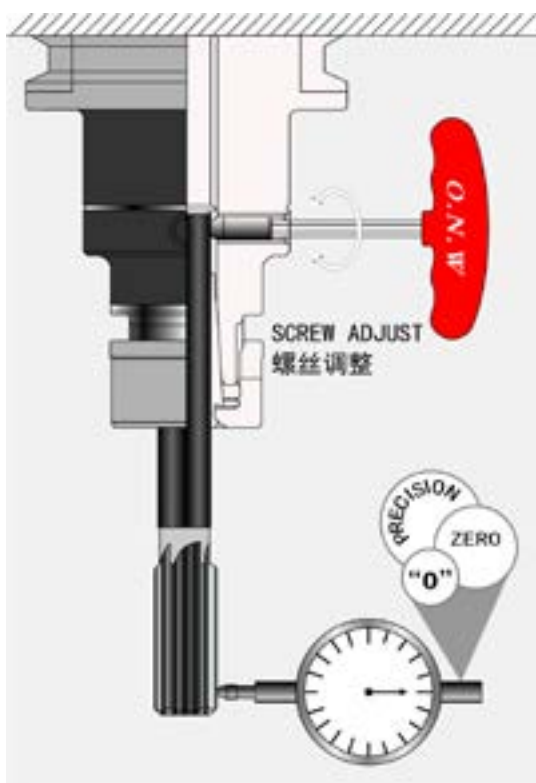

特点:

- ◎ 刀尖位置可调至 "0" 位置
- ◎ 机械主轴、夹头、刀具的累计误差值可一次调整补正

Features:

- ◎ The tool tip position can be adjusted as "0" position.
- ◎ The accumulated error value of the spindle, the chuck, and the tool can all be adjusted and corrected at the same time.

规格说明:

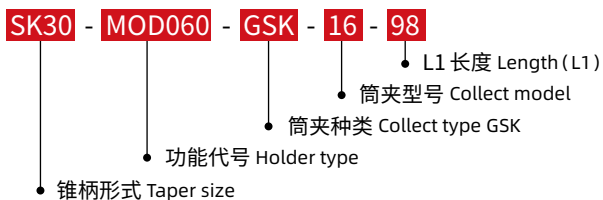

·SK-BST 镗孔组合刀柄

SK-BST ROUGH BORING TOOL HOLDER

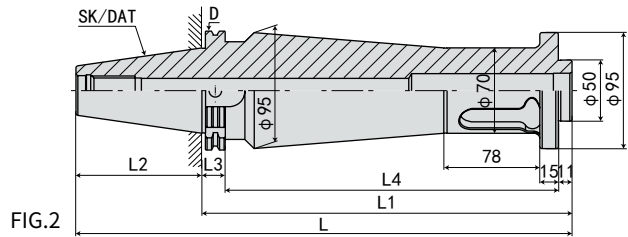
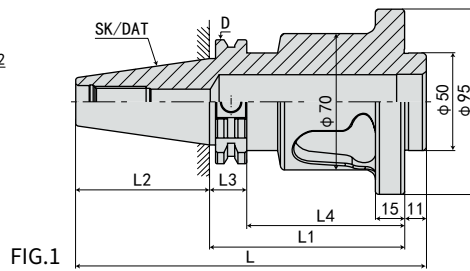
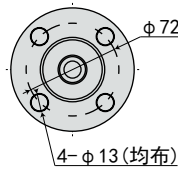
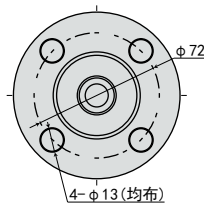
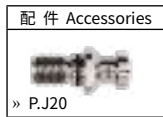

规格 Model	L	L1	L2	L3	L4	FIG	重量 KGS
SK40-BST-100	178.4	100	68.4	19	81	1	
-150	228.4	150	68.4	19	131	1	
-200	278.4	200	68.4	19	181	1	
-250	328.4	250	68.4	19	231	1	
-300	378.4	300	65.4	19	281	1	
SK50-BST-100	211.95	100	101.95	19	81	1	5
-150	261.95	150	101.95	19	131	1	
-200	311.95	200	101.95	19	181	1	
-250	361.95	250	101.95	19	231	1	
-300	411.95	300	101.95	19	281	2	13
-350	461.95	350	101.95	19	331	2	
-400	511.95	400	101.95	19	381	2	
-450	561.95	450	101.95	19	431	2	
-500	611.95	500	101.95	19	481	2	

特点:

注:

- ◎ 整支通孔，利于出水及抗震
- ◎ 非标可订制（400L/450L/500L/600L）
- ◎ 列表中的产品规格以库存实物为准
- ◎ 拉钉须另行购买

规格说明:

SK40 - BST - 100

- L1 长度 Length (L1)
- 功能代号 Holder type
- 锥柄形式 Taper size

Features:

- ◎ The entire through hole, favors the water leakage and quakeproof.
- ◎ Can be made upon requested Dimensions
- ◎ The list of product's specifications reference to material object.
- ◎ The pull stud must purchase alone.

F
SK SHANK SYSTEMS
SK 刀柄系列

·SK-EMH 喷射型侧固式刀柄

SK-EMH SPRAY NOZZLE TYPE END MILL HOLDER

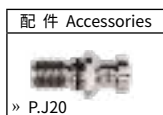
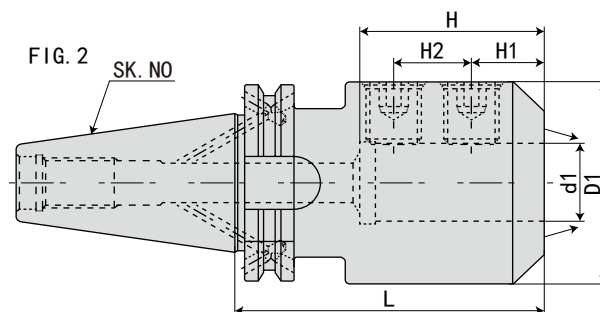
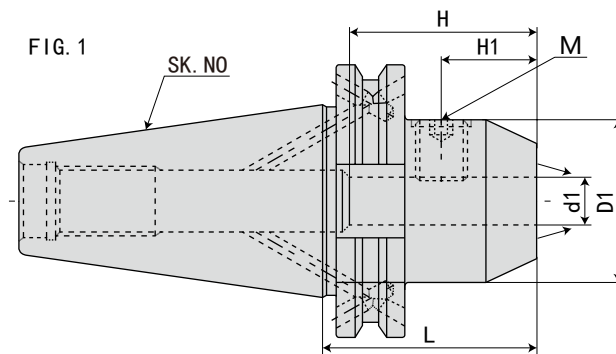

规格 Model	d1	D1	L	H	H1	FIG	M	重量 KGS
SK40AD/B- EMH6C- 50	6	25	50	35	18	1	M6*1.0P	0.86
- EMH8C- 50	8	28	50	35	18	1	M8*1.25P	0.89
-EMH10C- 50	10	35	50	35.5	20	1	M10*1.5P	0.95
-EMH12C- 50	12	42	50	36	22.5	1	M12*1.75P	1.03
-EMH14C- 50	14	44	50	36	22.5	1	M12*1.75P	1.26
-EMH16C- 63	16	48	63	46	24	1	M14	1.28
-EMH18C- 63	18	50	63	46	24	1	M14	1.35
-EMH20C- 63	20	52	63	48	25	1	M16*2.0P	1.4
-EMH25C-100	25	65	100	55	25	2	M18*2.5P	2.29
-EMH32C-100	32	72	100	57	28	2	M20*2.5P	2.5
SK50AD/B- EMH6C- 63	6	25	63	35	18	1	M6*1.0P	2.7
- EMH8C- 63	8	28	63	35	18	1	M8*1.25P	2.7
-EMH10C- 63	10	35	63	35.5	20	1	M10*1.5P	2.9
-EMH12C- 63	12	42	63	36	22.5	1	M12*1.75P	2.9
-EMH14C- 63	14	44	63	36	22.5	1	M12*1.75P	3
-EMH16C- 63	16	48	63	46	24	1	M14	3
-EMH18C- 63	18	50	63	46	24	1	M14	3
-EMH20C- 63	20	52	63	48	25	1	M16*2.0P	3.05
-EMH25C- 80	25	65	80	55	25	2	M18*2.5P	3.73
-EMH32C-100	32	72	100	57	28	2	M20*2.5P	4.53
-EMH40C-120	40	90	120	68	32	2	M20*2.5P	4.8

规格说明:

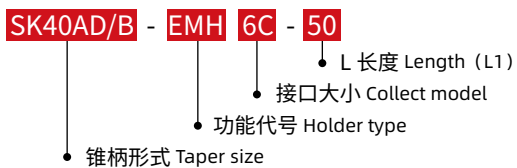

·SK 转换套 (内置夹紧单元) SK CONVERSION SLEEVE(CLAMPING CARTRIDGES)

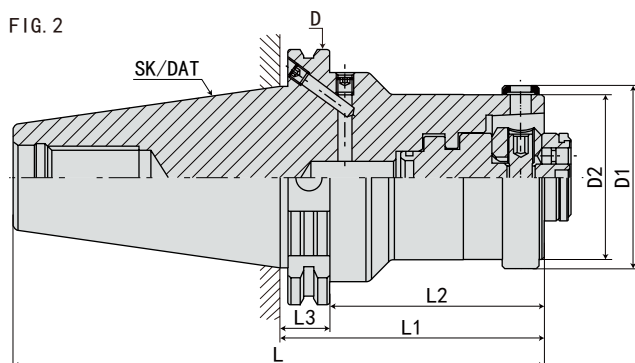
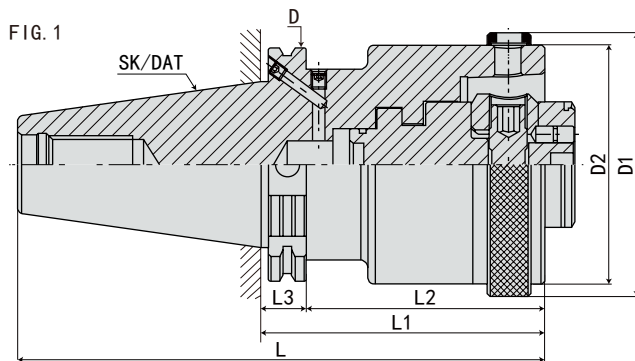

规格	L	L1	L2	L3	D	D1	D2	FIG	重量
SK30- HSK32C- 55C-AF	102.8	55	36	19.1	50	37	32	2	0.7
- HSK40C- 60C-AF	107.8	60	41	19.1	50	45	40	1	0.8
SK40- HSK32C- 55C-AF	123.4	55	36	19.1	63.55	37	32	2	0.9
- HSK40C- 60C-AF	128.4	60	41	19.1	63.55	45	40	2	1
- HSK50C- 65C-AF	133.4	65	46	19.1	63.55	55	50	2	1
- HSK63C- 75C-AF	143.4	75	56	19.1	63.55	70	63	1	1.2
SK50- HSK32C- 55C-AF	156.75	55	36	19.1	97.5	37	32	2	2.7
- HSK40C- 60C-AF	161.75	60	41	19.1	97.5	45	40	2	2.8
- HSK50C- 65C-AF	166.75	65	46	19.1	97.5	55	50	2	2.9
- HSK63C- 75C-AF	176.75	75	56	19.1	97.5	70	63	2	3.1
- HSK80C- 85C-AF	186.75	85	66	19.1	97.5	87	80	2	4
-HSK100C-100C-AF	201.75	100	81	19.1	97.5	110	100	1	5

规格说明:

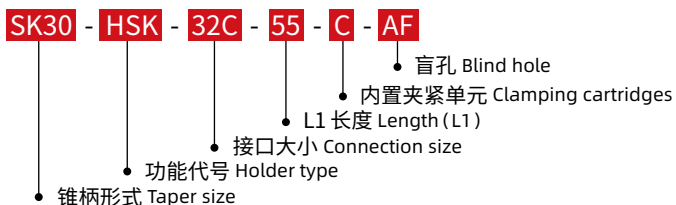

·SK 转换套 (内置夹紧单元) SK CONVERSION SLEEVE(CLAMPING CARTRIDGES)

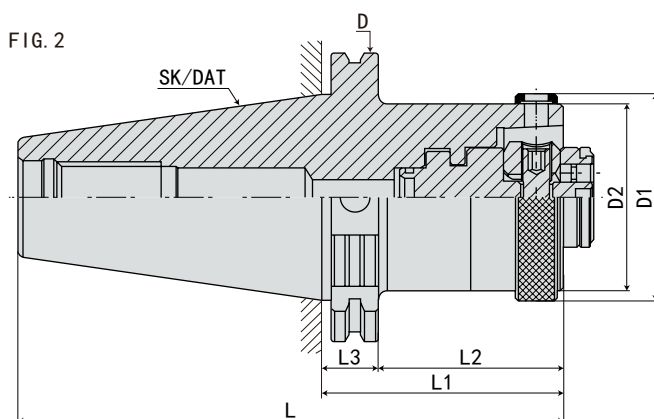
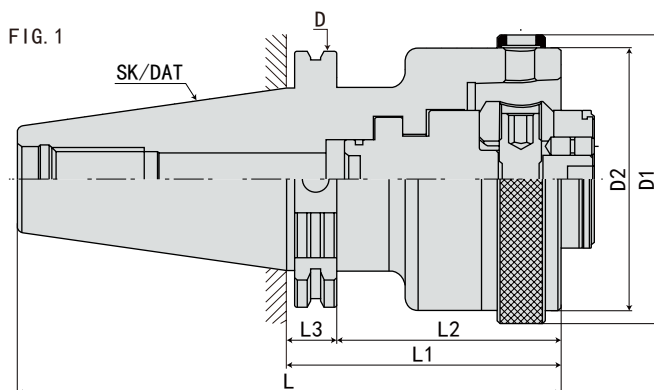

规格	L	L1	L2	L3	D	D1	D2	FIG	重量
SK30- HSK32C-40C-AD	87.8	40	21	19.1	50	37	32	2	0.7
- HSK40C-60C-AD	107.8	60	41	19.1	50	45	40	1	0.8
SK40- HSK32C-40C-AD	108.4	40	21	19.1	63.55	37	32	2	0.9
- HSK40C-40C-AD	108.4	40	21	19.1	63.55	45	40	2	1
- HSK50C-60C-AD	128.4	60	41	19.1	63.55	55	50	2	1
- HSK63C-75C-AD	143.4	75	56	19.1	63.55	70	63	1	1.2
SK50- HSK32C-40C-AD	141.75	40	21	19.1	97.5	37	32	2	2.7
- HSK40C-40C-AD	141.75	40	21	19.1	97.5	45	40	2	2.8
- HSK50C-40C-AD	141.75	40	21	19.1	97.5	55	50	2	2.9
- HSK63C-40C-AD	141.75	40	21	19.1	97.5	70	63	2	3.1
- HSK80C-80C-AD	181.75	80	61	19.1	97.5	87	80	2	4
-HSK100C-95C-AD	196.75	95	76	19.1	97.5	110	100	1	5

规格说明:

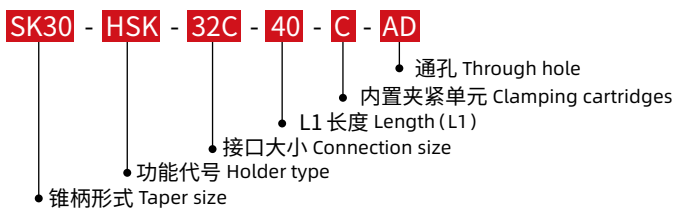

·CAT 转换套 (内置夹紧单元) CAT CONVERSION SLEEVE(CLAMPING CARTRIDGES)

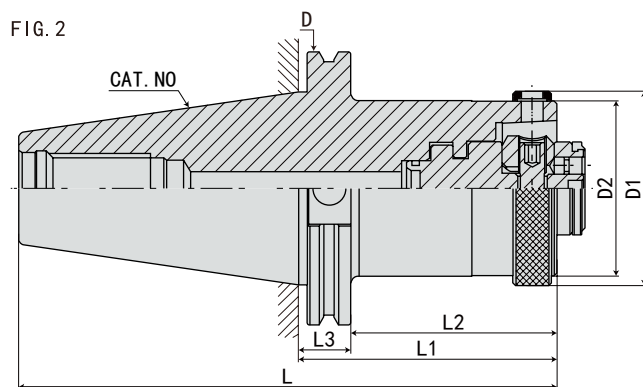
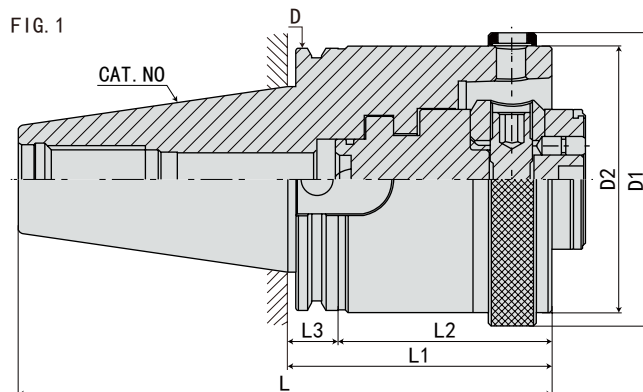

规格	L	L1	L2	L3	D	D1	D2	FIG	重量
CAT30- HSK32C-45C	92.6	45	29	15.9	46	37	32	2	0.7
- HSK40C-60C	107.6	60	44	15.9	46	45	40	1	0.8
CAT40- HSK32C-50C	118.2	50	34	15.9	63.5	37	32	2	0.9
- HSK40C-50C	118.2	50	34	15.9	63.5	45	40	2	1
- HSK50C-60C	128.2	60	44	15.9	63.5	55	50	2	1
- HSK63C-75C	143.2	75	59	15.9	63.5	70	63	1	1.2
CAT50- HSK32C-50C	151.6	50	34	15.9	98.4	37	32	2	2.7
- HSK40C-50C	151.6	50	34	15.9	98.4	45	40	2	2.8
- HSK50C-55C	156.6	55	39	15.9	98.4	55	50	2	2.9
- HSK63C-55C	156.6	55	39	15.9	98.4	70	63	2	3.1
- HSK80C-80C	181.6	80	64	15.9	98.4	87	80	2	4
-HSK100C-95C	196.6	95	79	15.9	98.4	110	100	1	5

规格说明:

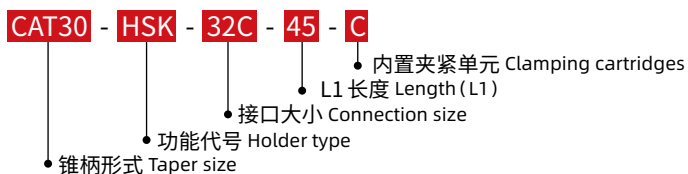

·SK- 基础柄刀柄

SK SEMI-FINISHED TOOL HOLDER

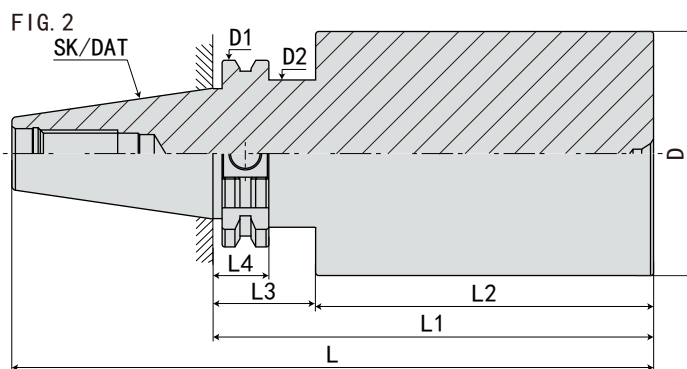
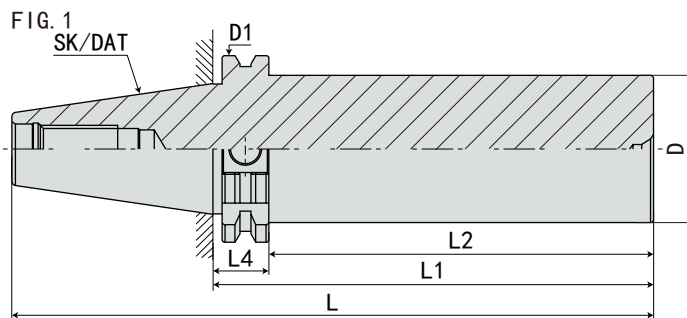

规格 Model	L	L1	L2	L3	L4	D	D1	D2	FIG	重量 KGS
SK40- D50-100	168.4	100	80.9	-	19.1	50	63.55	-	1	
-125	193.4	125	105.9	-	19.1	50	63.55	-	1	
-150	218.4	150	130.9	-	19.1	50	63.55	-	1	
-175	243.4	175	155.9	-	19.1	50	63.55	-	1	
-200	268.4	200	180.9	-	19.1	50	63.55	-	1	
- D63-100	168.4	100	65	35	19.1	63	63.55	50	2	
-125	193.4	125	90	35	19.1	63	63.55	50	2	
-150	218.4	150	115	35	19.1	63	63.55	50	2	
-175	243.4	175	140	35	19.1	63	63.55	50	2	
-200	268.4	200	165	35	19.1	63	63.55	50	2	
-225	293.4	225	190	35	19.1	63	63.55	50	2	
- D83-100	168.4	100	65	35	19.1	83	63.55	50	2	
-125	193.4	125	90	35	19.1	83	63.55	50	2	
-150	218.4	150	115	35	19.1	83	63.55	50	2	
-175	243.4	175	140	35	19.1	83	63.55	50	2	
-200	268.4	200	165	35	19.1	83	63.55	50	2	
-225	293.4	225	190	35	19.1	83	63.55	50	2	
-D102-100	168.4	100	65	35	19.1	102	63.55	50	2	
-125	193.4	125	90	35	19.1	102	63.55	50	2	
-150	218.4	150	115	35	19.1	102	63.55	50	2	
-175	243.4	175	140	35	19.1	102	63.55	50	2	
-200	268.4	200	165	35	19.1	102	63.55	50	2	
-225	293.4	225	190	35	19.1	102	63.55	50	2	

规格说明:

SK40 - D - 50 - 100

- 锥柄形式 Taper size
- 功能代号 Holder type
- 接口大小 Connection size
- L1 长度 Length (L1)